

## Wheels for the general public

### Vulcanised rubber coating

#### COVERING

Grey anti-trace rubber.

#### WHEEL CENTRE BODY

Polypropylene-based (PP) technopolymer, with polyamide thread guards (D = 40 mm) or with metal thread guards (D = 50, 60, 80 mm).

#### ROLLING ACTION

Hub with pass-through hole.

#### APPLICATIONS

Wheels for the general public, excellent rolling resistance and elasticity features. For selection parameters see Technical data. RE.C7 wheels are also supplied with steel sheet bracket RE.C7-C.

#### ENVIRONMENTAL CONDITIONS

Suitable for use in humid environments and in the presence of medium-aggressive chemical environments; use in environments with the presence of organic, chlorinated solvents, hydrocarbons and mineral oils is not recommended.

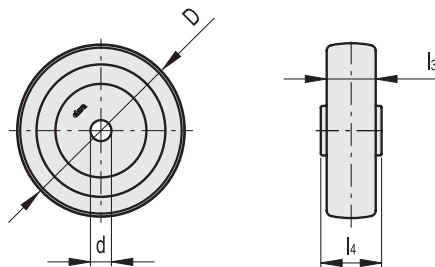

Code	Description	D	d	l <sub>3</sub>	l <sub>4</sub>	Dynamic carrying capacity# [N]	⚖
452076	RE.C7-040-RBL	40	8	18	21	300	30
452081	RE.C7-050-RBL	50	8	18	21	350	60
452086	RE.C7-060-RBL	60	8	24	28	500	100
452091	RE.C7-080-RBL	80	8	24	28	550	170