

Levers for PR-CH flush pull handles

Steel or stainless steel

STANDARD EXECUTIONS

- LPR: zinc-plated steel lever.
- LPR-SST: AISI 304 stainless steel lever.

Assembly on handle PR-CH

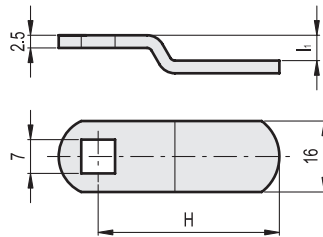
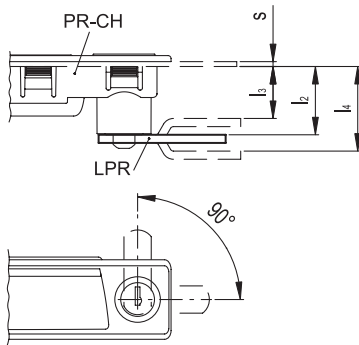

LPR

Code	Description	H	l1	s+l2	s+l3	s+l4	⚖️
421041	LPR-0-17	17,5	0	23,2	-	-	7
421045	LPR-0-22	22	0	23,2	-	-	8
421049	LPR-0-32	32	0	23,2	-	-	11
421053	LPR-0-46	46	0	23,2	-	-	15
421057	LPR-2-24	24,5	2	-	21,2	25,2	8
421061	LPR-2-28	27,8	2	-	21,2	25,2	10
421065	LPR-2-34	34,5	2	-	21,2	25,2	11
421069	LPR-5-30	30	5	-	18,2	28,2	10
421073	LPR-5-33	33	5	-	18,2	28,2	11
421077	LPR-5-35	35,5	5	-	18,2	28,2	12
421081	LPR-8-32	32,5	8	-	15,2	31,2	13
421085	LPR-12-26	26,5	12	-	11,2	35,2	12

LPR-SST

STAINLESS STEEL

Code	Description	H	l1	s+l2	s+l3	s+l4	⚖️
421046	LPR-0-20-SST	19,8	0	23,2	-	-	8
421050	LPR-0-32-SST	32	0	23,2	-	-	11
421054	LPR-0-46-SST	46	0	23,2	-	-	15
421068	LPR-0-45-SST	45	3	-	20,2	26,2	15

