

Oil level sight glasses

Transparent technopolymer

MATERIAL

Transparent polyamide based (PA-T) technopolymer. Avoid contact with alcohol or detergents containing alcohol.

PACKING RING

NBR synthetic rubber.

MAXIMUM CONTINUOUS WORKING TEMPERATURE

100°C.

TECHNICAL DATA

The tightening torque indicated in the table guarantees an optimal tightness, keeping the packing ring in the correct position.

NOTE

For use with other fluids with special additives, please contact ELESA Sales Department.

ACCESSORIES ON REQUEST

Brass nut type GH. (see page) for fitting to reservoirs with wall thickness smaller than 5 mm.



ELESA Original design

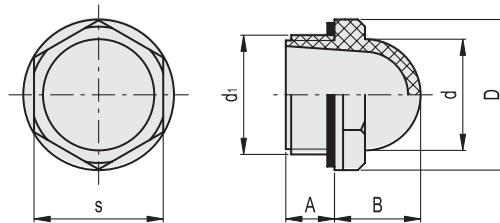

Code	Description	d ₁	A	B	D	d	s	Tightening torque [Nm]	
10851	HCFE.12-3/8	G 3/8	7.5	13	22.5	15	19	3÷5	4
10901	HCFE.15-1/2	G 1/2	10.5	16	26	19	22	4÷6	5
11001	HCFE.20-3/4	G 3/4	10.5	19.5	31.5	25	27	6÷8	8
11101	HCFE.24-1	G 1	11	24	42	31	36	8÷10	18
11111	HCFE.30-1¼	G 1¼	11.5	26.5	46.5	38	40.5	8÷10	22
10841	HCFE.11-M16x1,5	M16x1,5	7.5	13.5	22	15	19	2÷3	3.5
10891	HCFE.14-M20x1,5	M20x1,5	9.5	15.5	26	19	22	4÷6	5
10981	HCFE.18-M25x1,5	M25x1,5	8.5	19.5	31	25	27	6÷8	8
10991	HCFE.19-M27x1,5	M27x1,5	9	19.5	31	25	26.5	6÷8	8.5
11011	HCFE.21-M26x1,5	M26x1,5	13	19.5	31	25	26.5	6÷8	9
11108	HCFE.26-M35x1,5	M35x1,5	11	24	41.5	31	36	8÷10	16.5
11110	HCFE.31-M40x1,5	M40x1,5	11.5	26.5	46.5	38	40.5	8÷10	21