

# GN 950.6-F

Spoked handwheels with fixed handle

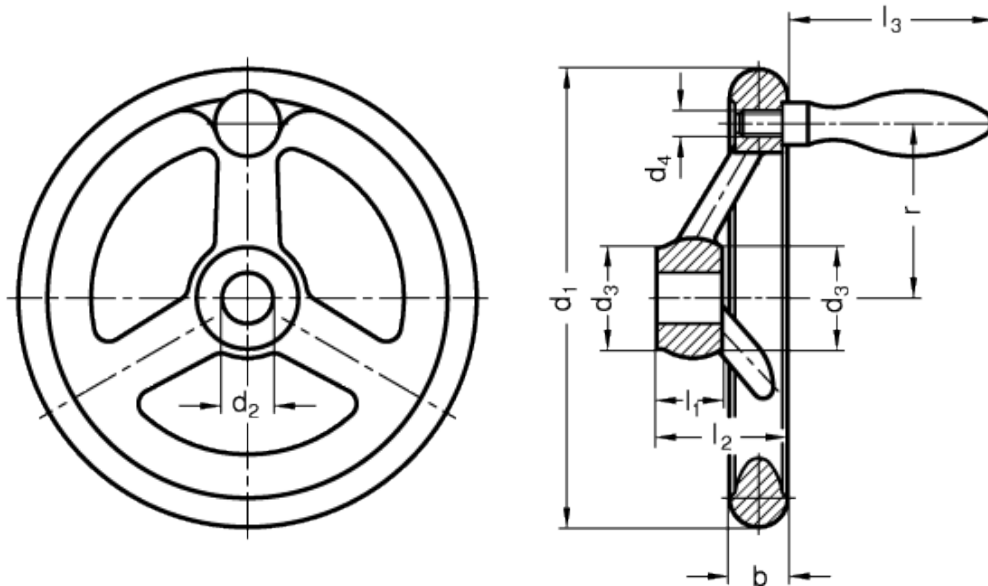

INOX  
Stainless Steel



## technical informations

### Material

AISI 316 LHC stainless steel.

- acid resistant.
- hub machined.
- rim turned and polished.
- unmachined surface matt shot-blasted.

### Assembly

- Version B: H9 reamed hole.
  - Version K: H9 reamed hole and keyway in compliance with [DIN 6885/1 P9 tolerance](#).
- For fixing GN 950.6 on shafts by a grub screw see [Technical Data](#).

### Fixed Handle

Type DIN 39-A4 turned and mirror-polished stainless steel.

*Accessories on request*

Axial retaining washer type [GN 184.5](#).

*Features and applications*

The dimensions of the spoked handwheels with fixed handle GN 950.6 comply extensively with spoked handwheels DIN 950.

Standard Elements	Main dimensions				Bore		Handle				Spokes no.	Weight
Description	d <sub>1</sub>	d <sub>3</sub> ≈	b	l <sub>2</sub> ≈	d <sub>2 H9</sub>	l <sub>1</sub>	l <sub>3</sub>	∅	r	d <sub>4</sub>		g
GN 950.6-100-B10-F	100	25.5	14.5	33	10	17	48.5	16	36	M 6	3	480
GN 950.6-100-K10-F	100	25.5	14.5	33	10	17	48.5	16	36	M 6	3	470
GN 950.6-125-B12-F	125	27	15.8	35.5	12	18	62	20	47	M 8	3	770
GN 950.6-125-K12-F	125	27	15.8	35.5	12	18	62	20	47	M 8	3	760
GN 950.6-140-B14-F	140	29	17	38.5	14	19	62	20	52	M 8	3	940
GN 950.6-140-K14-F	140	29	17	38.5	14	19	62	20	52	M 8	3	930
GN 950.6-160-B14-F	160	31	17.5	39.5	14	20	77	25	62	M 10	3	1320
GN 950.6-160-K14-F	160	31	17.5	39.5	14	20	77	25	62	M 10	3	1310
GN 950.6-200-B18-F	200	37	20	44.5	18	24	77	25	80	M 10	3	2060
GN 950.6-200-K18-F	200	37	20	44.5	18	24	77	25	80	M 10	3	2000



STANDARD MACHINE ELEMENTS WORLDWIDE