

GN 950.6-A

Spoked handwheels

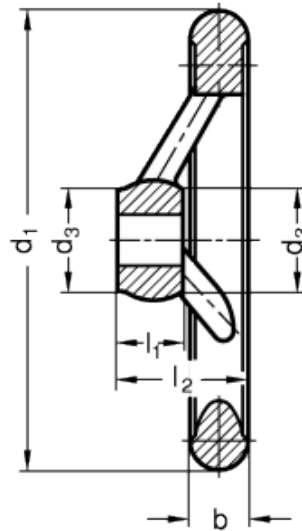

INOX
Stainless Steel

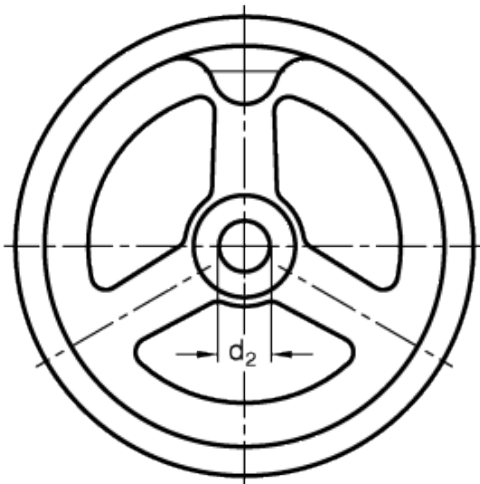

technical informations

Material

AISI 316 LHC stainless steel.

- acid resistant.
- hub machined.
- rim turned and polished.
- unmachined surface matt shot-blasted.

Hub

- Version B: H9 reamed hole.
 - Version K: H9 reamed hole and keyway in compliance with [DIN 6885/1 P9 tolerance](#).
- For fixing GN 950.6 on shafts by a grub screw see [Technical Data](#).

Accessories on request

Axial retaining washer type [GN 184.5](#).

Features and applications

The dimensions of the spoked handwheels GN 950.6 comply extensively with spoked handwheels DIN 950.

Standard Elements	Main dimensions				Bore		Spokes no.	Weight
	Description	d_1	$d_3 \approx$	b	$l_2 \approx$	d_{2H9}		l_1
GN 950.6-100-B10-A	100	25.5	14.5	33	10	17	3	433
GN 950.6-100-K10-A	100	25.5	14.5	33	10	17	3	430
GN 950.6-125-B12-A	125	27	15.8	35.5	12	18	3	660
GN 950.6-125-K12-A	125	27	15.8	35.5	12	18	3	655
GN 950.6-140-B14-A	140	29	17	38.5	14	19	3	865
GN 950.6-140-K14-A	140	29	17	38.5	14	19	3	840
GN 950.6-160-B14-A	160	31	17.5	39.5	14	20	3	1156
GN 950.6-160-K14-A	160	31	17.5	39.5	14	20	3	1150
GN 950.6-200-B18-A	200	37	20	44.5	18	24	3	1938
GN 950.6-200-K18-A	200	37	20	44.5	18	24	3	1930



ELESA and GANTER models all rights reserved in accordance with the law. Always mention the source when reproducing our drawings.

STANDARD MACHINE ELEMENTS WORLDWIDE