

GN 923-R

Solid handwheels with revolving handle

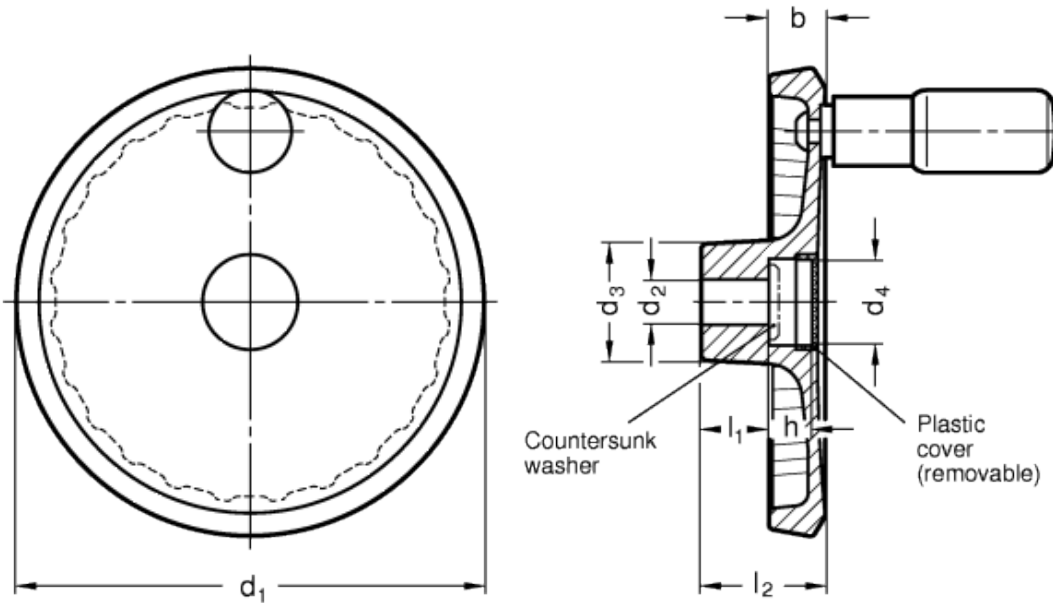

technical informations

Material

Aluminium pressure die casting, hub machined, rim turned.

Colour

- Version SW: plastic coated, black RAL 9005, textured finish.
- Version SR: plastic coated, silver RAL 9006, textured finish.

Assembly

- Version B: hub with H7 tolerance plain hole.

- Version K: hub with H7 reamed hole with keyway in compliance with [DIN 6885/1 P9 tolerance](#).
For fixing GN 923 on shafts by a grub screw see [Technical Data](#).

Plastic cover

Polyamide based (PA) technopolymer, light-grey colour, push-fit assembly

Revolving handle

Type GN 798 in polyamide based (PA) technopolymer, black colour, matte finish. Resistant to solvents, oils, greases and other chemical agents. The two-volume special design of the handle provides the operator's hand with a safe and ergonomic grip when turning the handwheel.

Accessories on request

Axial retaining washer [GN 184](#).

Technical data

Axial and radial runout lower than 0.4.

Features and applications

Solid handwheels GN 923 are distinguished by modern design.
The removable plastic cover shrouds the fixing components such as screws, countersunk washers as well as the shaft end

Standard Elements	Main dimensions					Bore			Handle	Recommended washer	Weight
	Description	d ₁	b	h	d ₃	d ₄	d _{2 H7}	l ₁	l ₂		∅
GN 923-80-B10-R-*	80	13	7	26	17	10	16	26	16	GN 184-16	120
GN 923-80-K10-R-*	80	13	7	26	17	10	16	26	16	GN-184-16	100
GN 923-80-B12-R-*	80	13	7	26	17	12	16	26	16	GN 184-16	100
GN 923-80-K12-R-*	80	13	7	26	17	12	16	26	16	GN-184-16	100
GN 923-100-B10-R-*	100	14	9.5	28	22	10	17	30	18	GN 184-20	160
GN 923-100-K10-R-*	100	14	9.5	28	22	10	17	30	18	GN-184-20	160
GN 923-100-B12-R-*	100	14	9.5	28	22	12	17	30	18	GN 184-20	150
GN 923-100-K12-R-*	100	14	9.5	28	22	12	17	30	18	GN-184-20	150
GN 923-125-B12-R-*	125	15	11	31	22	12	18	33	22	GN 184-20	260
GN 923-125-K12-R-*	125	15	11	31	22	12	18	33	22	GN-184-20	260
GN 923-125-B14-R-*	125	15	11	31	22	14	18	33	22	GN 184-20	250
GN 923-125-K14-R-*	125	15	11	31	22	14	18	33	22	GN-184-20	340
GN 923-140-B14-R-*	140	16.5	13	36	28.5	14	19	36	24	GN 184-25	340
GN 923-140-K14-R-*	140	16.5	13	36	28.5	14	19	36	24	GN-184-25	350
GN 923-140-B16-R-*	140	16.5	13	36	28.5	16	19	36	24	GN 184-25	370
GN 923-140-K16-R-*	140	16.5	13	36	28.5	16	19	36	24	GN-184-25	370
GN 923-160-B14-R-*	160	18	14.5	36	28.5	14	20	39	24	GN 184-25	450
GN 923-160-K14-R-*	160	18	14.5	36	28.5	14	20	39	24	GN-184-25	450
GN 923-160-B16-R-*	160	18	14.5	36	28.5	16	20	39	24	GN 184-25	460
GN 923-160-K16-R-*	160	18	14.5	36	28.5	16	20	39	24	GN-184-25	460
GN 923-200-B18-R-*	200	20.5	16	42	36	18	24	45	25	GN 184-32	780
GN 923-200-K18-R-*	200	20.5	16	42	36	18	24	45	25	GN-184-32	780
GN 923-200-B20-R-*	200	20.5	16	42	36	20	24	45	25	GN 184-32	800
GN 923-200-K20-R-*	200	20.5	16	42	36	20	24	45	25	GN-184-32	800

* Complete the description of the standard item needed by adding the colour of the handwheel: SW (black) or SR (silver).

This product had the following design awards:



STANDARD MACHINE ELEMENTS WORLDWIDE