

# GN 913.5

Grub screws

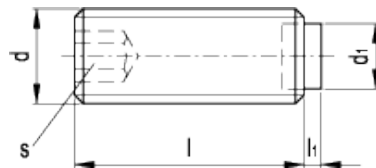

INOX  
Stainless Steel



## technical informations

### Material

AISI 303 stainless steel, hexagon socket head.

### Bolt

- Execution KU: acetal resin based (POM) technopolymer, natural colour.
- Execution MS: brass.

*Special executions on request (For sufficient quantities)*

Different threadings and lengths.

### Features and applications

GN 913.5 grub screws, thanks to the brass or technopolymer bolt, avoid to scratch or damage the contact surface. AISI 303 stainless steel, thanks to its high resistance to corrosion, allows the application of these grub screws on machines and equipment in those sectors where laws or particular hygienic, climatic and environmental factors make it mandatory to use corrosion resistant materials.

Standard Elements	Main dimensions					Weight
Description	d	l	d <sub>1</sub>	l <sub>1</sub>	s	g
GN 913.5-M3-3-KU	M3	3	1.5	0.8	1.5	8
GN 915.3-M3-4-KU	M3	4	1.5	0.8	1.5	-
GN 915.3-M3-5-KU	M3	5	1.5	0.8	1.5	-
GN 915.3-M3-6-KU	M3	6	1.5	0.8	1.5	-
GN 915.3-M3-8-KU	M3	8	1.5	0.8	1.5	-
GN 913.5-M3-10-KU	M3	10	1.5	0.8	1.5	-
GN 913.5-M4-4-KU	M4	4	2	1.2	1.5	-
GN 913.5-M4-5-KU	M4	5	2	1	1.5	-
GN 913.5-M4-6-KU	M4	6	2	1	2	1
GN 913.5-M4-8-KU	M4	8	2	1	2	1
GN 913.5-M4-10-KU	M4	10	2	1	2	1
GN 913.5-M4-12-KU	M4	12	2	1	2	1
GN 913.5-M4-16-KU	M4	16	2	1	2	1
GN 913.5-M5-5-KU	M5	5	3	1	2	-
GN 913.5-M5-6-KU	M5	6	3	1	2	-
GN 913.5-M5-8-KU	M5	8	3	1	2.5	1
GN 913.5-M5-10-KU	M5	10	3	1	2.5	1
GN 913.5-M5-12-KU	M5	12	3	1	2.5	1
GN 913.5-M5-16-KU	M5	16	3	1	2.5	2
GN 913.5-M5-20-KU	M5	20	3	1	2.5	2
GN 913.5-M6-6-KU	M6	6	3.5	1.3	3	-
GN 913.5-M6-8-KU	M6	8	3.5	1.3	3	-
GN 913.5-M6-10-KU	M6	10	3.5	1.3	3	1
GN 913.5-M6-12-KU	M6	12	3.5	1.3	3	1
GN 913.5-M6-16-KU	M6	16	3.5	1.3	3	2
GN 913.5-M6-20-KU	M6	20	3.5	1.3	3	3
GN 913.5-M6-25-KU	M6	25	3.5	1.3	3	4
GN 913.5-M6-32-KU	M6	32	3.5	1.3	3	5
GN 913.5-M8-8-KU	M8	8	5	1.6	4	1
GN 913.5-M8-10-KU	M8	10	5	1.6	4	-
GN 913.5-M8-12-KU	M8	12	5	1.6	4	2
GN 913.5-M8-16-KU	M8	16	5	1.6	4	4
GN 913.5-M8-20-KU	M8	20	5	1.6	4	5
GN 913.5-M8-25-KU	M8	25	5	1.6	4	7
GN 913.5-M8-32-KU	M8	32	5	1.6	4	9
GN 913.5-M8-40-KU	M8	40	5	1.6	4	11
GN 913.5-M10-16-KU	M10	16	6.5	1.9	5	5
GN 913.5-M10-20-KU	M10	20	6.5	1.9	5	7
GN 913.5-M10-25-KU	M10	25	6.5	1.9	5	9
GN 913.5-M10-32-KU	M10	32	6.5	1.9	5	13
GN 913.5-M10-40-KU	M10	40	6.5	1.9	5	16
GN 913.5-M10-50-KU	M10	50	6.5	1.9	5	21

GN 913.5-M12-20-KU	M12	20	8	2.1	6	9
GN 913.5-M12-25-KU	M12	25	8	2.1	6	13
GN 913.5-M12-32-KU	M12	32	8	2.1	6	18
GN 913.5-M12-40-KU	M12	40	8	2.1	6	24
GN 913.5-M12-50-KU	M12	50	8	2.1	6	31
GN 913.5-M12-63-KU	M12	63	8	2.1	6	40
GN 913.5-M3-3-MS	M3	3	1.4	0.5	1.5	-
GN 915.3-M3-4-MS	M3	4	1.4	0.5	1.5	-
GN 915.3-M3-5-MS	M3	5	1.4	0.5	1.5	-
GN 915.3-M3-6-MS	M3	6	1.4	0.5	1.5	-
GN 913.5-M3-8-MS	M3	8	1.4	0.5	1.5	-
GN 913.5-M3-10-MS	M3	10	1.4	0.5	1.5	-
GN 913.5-M4-4-MS	M4	4	2.5	0.5	1.5	-
GN 913.5-M4-5-MS	M4	5	2.5	0.5	1.5	-
GN 913.5-M4-6-MS	M4	6	2.5	0.5	2	1
GN 913.5-M4-8-MS	M4	8	2.5	0.5	2	1
GN 913.5-M4-10-MS	M4	10	2.5	0.5	2	1
GN 913.5-M4-12-MS	M4	12	2.5	0.5	2	1
GN 913.5-M4-16-MS	M4	16	2.5	0.5	2	1
GN 913.5-M5-5-MS	M5	5	3	0.5	2	1
GN 913.5-M5-6-MS	M5	6	3	0.5	2	-
GN 913.5-M5-8-MS	M5	8	3	0.5	2.5	1
GN 913.5-M5-10-MS	M5	10	3	0.5	2.5	1
GN 913.5-M5-12-MS	M5	12	3	0.5	2.5	1
GN 913.5-M5-16-MS	M5	16	3	0.5	2.5	2
GN 913.5-M5-20-MS	M5	20	3	0.5	2.5	2
GN 913.5-M6-6-MS	M6	6	4	1	3	1
GN 913.5-M6-8-MS	M6	8	4	1	3	-
GN 913.5-M6-10-MS	M6	10	4	1	3	1
GN 913.5-M6-12-MS	M6	12	4	1	3	2
GN 913.5-M6-16-MS	M6	16	4	1	3	2
GN 913.5-M6-20-MS	M6	20	4	1	3	3
GN 913.5-M6-25-MS	M6	25	4	1	3	4
GN 913.5-M6-32-MS	M6	32	4	1	3	5
GN 913.5-M8-8-MS	M8	8	6	1.5	4	2
GN 913.5-M8-10-MS	M8	10	6	1.5	4	3
GN 913.5-M8-12-MS	M8	12	6	1.5	4	3
GN 913.5-M8-16-MS	M8	16	6	1.5	4	5
GN 913.5-M8-20-MS	M8	20	6	1.5	4	6
GN 913.5-M8-25-MS	M8	25	6	1.5	4	7
GN 913.5-M8-32-MS	M8	32	6	1.5	4	10
GN 913.5-M8-40-MS	M8	40	6	1.5	4	12
GN 913.5-M10-16-MS	M10	16	8	2	5	7
GN 913.5-M10-20-MS	M10	20	8	2	5	9
GN 913.5-M10-25-MS	M10	25	8	2	5	11

GN 913.5-M10-32-MS	M10	32	8	2	5	15
GN 913.5-M10-40-MS	M10	40	8	2	5	18
GN 913.5-M10-50-MS	M10	50	8	2	5	23
GN 913.5-M12-20-MS	M12	20	10	2	6	13
GN 913.5-M12-25-MS	M12	25	10	2	6	16
GN 913.5-M12-32-MS	M12	32	10	2	6	20
GN 913.5-M12-40-MS	M12	40	10	2	6	27
GN 913.5-M12-50-MS	M12	50	10	2	6	34
GN 913.5-M12-63-MS	M12	63	10	2	6	45



ELESA and GANTER models all rights reserved in accordance with the law. Always mention the source when reproducing our drawings.

**STANDARD MACHINE ELEMENTS WORLDWIDE**