

GN 900.5

Rotary plates

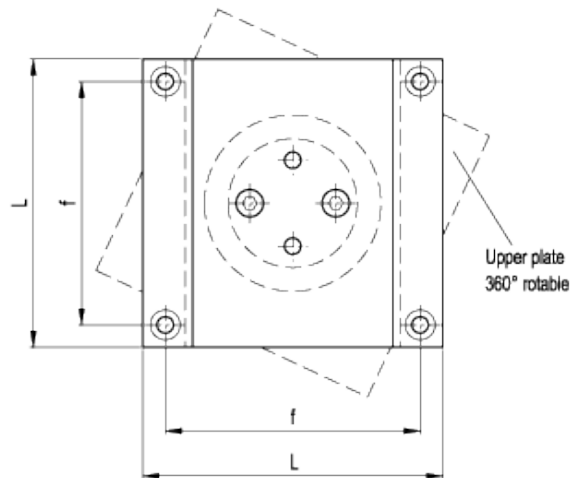
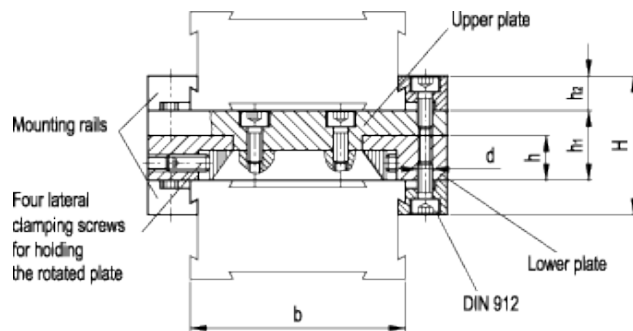

technical informations

Material

Anodised aluminium, natural colour.

Socket head cap screw

Stainless steel, according to ISO 4762.

Features and applications

Rotary plates GN 900.5 allow rotation of one of the adjustable slide units at an off-set angle to the other. This possibility offers an additional axis configuration.

This alternative adaptor consists of two plates connected together in the centre so that they are rotatable. The lower plate is clamped to the lower sliding part while the upper one is clamped to the stationary base of the upper sliding unit. The required parts include two fastening sets as well as the necessary socket head cap screws.

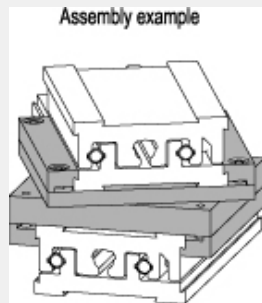

Standard Elements	Main dimensions								Weight
	b	L	d	H	h	h ₁	h ₂	f	
GN 900.5-30-41	30	41	M2.5	18.4	6	10	4.2	35.4	160
GN 900.5-50-67	50	67	M3	28	9	14	7	58	209
GN 900.5-80-105	80	105	M4	39	9	14	12.5	92	568
GN 900.5-120-145	120	145	M5	47.6	12	20	13.8	131.8	1400



ELESA and GANTER models all rights reserved in accordance with the law. Always mention the source when reproducing our drawings.

STANDARD MACHINE ELEMENTS WORLDWIDE