

# GN 900.1

Fastening units

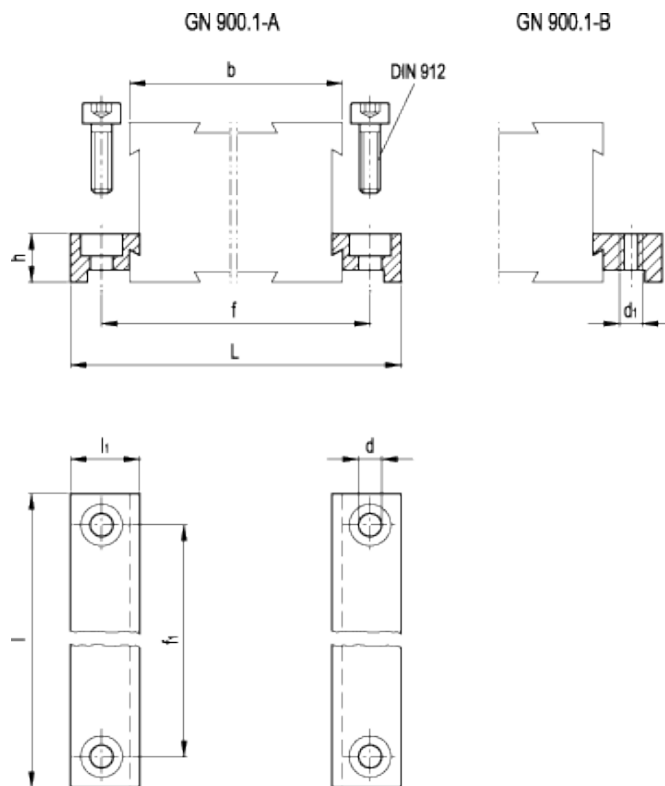

technical informations

**Material**

Anodised aluminium, natural colour.

**Socket head cap screw**

Stainless steel.

**Standard executions available**

- Version A: with bore for socket head cap screw.
- Version B: with threaded bore.

### Features and applications

Fastening units GN 900.1 are fitted to the base of the adjustable slide units [GN 900](#) from the operator's side. The mounting is made on the outside ledge of the slide so that the inner slide can still be moved.

Assembly example

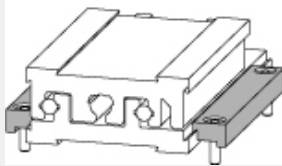

Standard Elements	Main dimensions									Weight
Description	b	l	l <sub>1</sub>	L	d	d <sub>1</sub>	h	f	f <sub>1</sub>	g
GN 900.1-30-41-A	30	41	6.5	41	2.7	M2.5	4.2	35.4	35.4	7
GN 900.1-30-41-B	30	41	6.5	41	2.7	M2.5	4.2	35.4	35.4	8
GN 900.1-50-67-A	50	67	10	67	3.3	M3	7	58	58	20
GN 900.1-50-67-B	50	67	10	67	3.3	M3	7	58	58	24
GN 900.1-80-105-A	80	105	14.5	105	4.5	M4	12.5	92	92	84
GN 900.1-80-105-B	80	105	14.5	105	4.5	M4	12.5	92	92	87
GN 900.1-120-145-A	120	145	14.5	145	5.5	M5	13.8	131.8	131.8	134
GN 900.1-120-145-B	120	145	14.5	145	5.5	M5	13.8	131.8	131.8	138



ELESA and GANTER models all rights reserved in accordance with the law. Always mention the source when reproducing our drawings.

STANDARD MACHINE ELEMENTS WORLDWIDE