

# GN 853-NI

Latch clamps

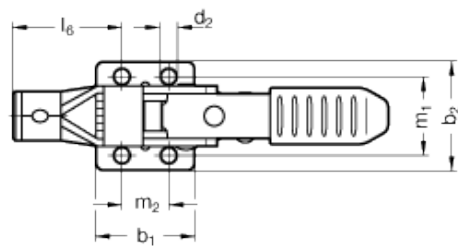

GN 853-TG

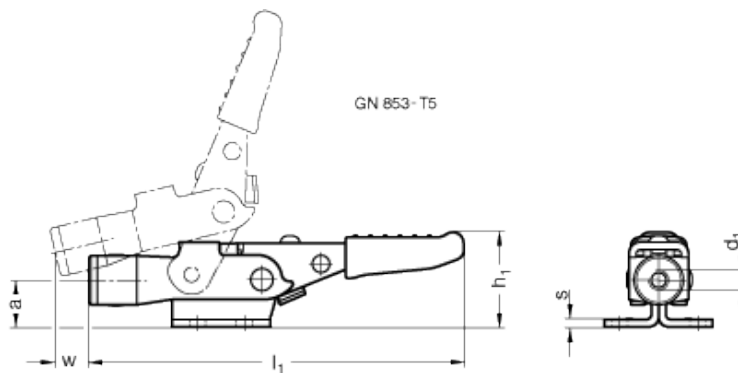
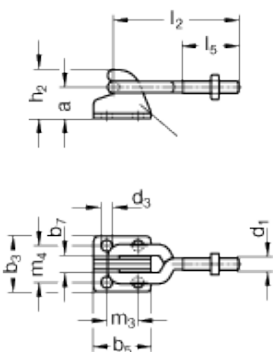

GN 853-TT

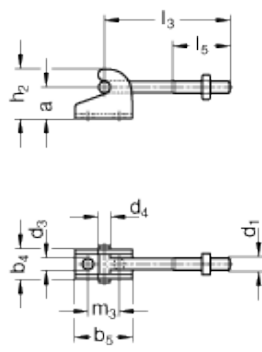

GN 853-TU

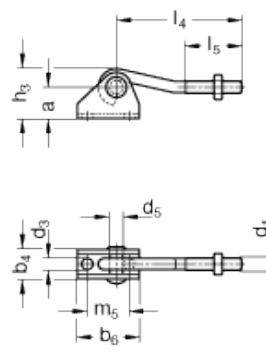

technical informations  
**Body and latch bracket**  
AISI 304 stainless steel.

### Tie-rod

AISI 304 stainless steel.

### Assembly

All moving parts lubricated with special grease.

### Handle

Solid moulded plastic handle sleeve, red, oil resistant.





### Standard versions available

- Version T5: without tie-rod, without latch bracket.
- Version TG: with tie-rod, with latch bracket, tie-rod with drawbar eye.
- Version TT: with tie-rod, with latch bracket, tie-rod with T-piece.
- Version TU: with tie-rod, with latch bracket, tie-rod with hook.

### Features and applications

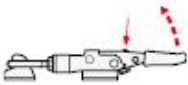
The Latch clamp GN 853-NI also features a locking mechanism which prevents the inadvertent or vibration-induced opening of the clamp.

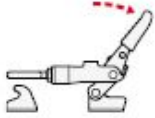
Another benefit is the option of operating the clamp with one hand.

Description of function (for one-hand operation)	
	Press the release button for releasing.
	Lift the clamping arm until the tie-rod disengages from the latch bracket.
	Retracting the clamping arm will lift the tie-rod and release the latch bracket (one-hand operation).
	For <b>clamping</b> operation, lift the clamping arm until it rests on the latch bracket.
	The clamping arm engages in the latch bracket if the releasing button is pressed for the clamping operation. When clamping in the end position, the system locks automatically by spring force.

Standard Elements	Main dimensions																										Stroke	Holding force	Weight
Description	a	b <sub>1</sub>	b <sub>2</sub>	b <sub>3</sub>	b <sub>4</sub>	b <sub>5</sub>	b <sub>6</sub>	b <sub>7</sub>	d <sub>1</sub>	d <sub>2</sub>	d <sub>3</sub>	h <sub>1</sub> ≈	h <sub>2</sub>	h <sub>3</sub>	l <sub>1</sub> ≈	l <sub>2</sub> ≈	l <sub>3</sub>	l <sub>4</sub>	l <sub>5</sub>	l <sub>6</sub>	m <sub>1</sub>	m <sub>2</sub>	m <sub>3</sub>	m <sub>4</sub>	m <sub>5</sub>	s	w <sub>2</sub>	FH in N	g
GN 853-160-T5-NI	13	26	28	-	-	-	-	-	M6	4.5	-	27	-	-	103	-	-	-	-	30	19	16	-	-	-	2	8	1750	97
GN 853-320-T5-NI	19	40	44	-	-	-	-	-	M8	6.7	-	38.5	-	-	153	-	-	-	-	44.5	32	19	-	-	-	3	13	4000	38
GN 853-700-T5-NI	28	60	54	-	-	-	-	-	M10	8.5	-	54	-	-	222	-	-	-	-	51	38	41.5	-	-	-	3.5	19	7500	68
GN 853-160-TG-NI	13	26	28	23	-	26	-	6.8	M6	4.5	4.5	27	20	-	103	55	-	-	28	30	19	16	16	14.3	-	2	8	1750	10
GN 853-320-TG-NI	19	40	44	34	-	35	-	10	M8	6.7	6.7	38.5	30	-	153	76.5	-	-	34	44.5	32	19	19	22.3	-	3	13	4000	33
GN 853-700-TG-NI	28	60	54	41	-	50	-	11	M10	8.5	8.5	53	40.5	-	222	95.5	-	-	42	51	38	41.5	31	25.4	-	3.5	19	7500	88
GN 853-160-TT-NI	13	26	28	-	26	26	-	-	M6	4.5	4.5	27	20	-	103	-	55	-	28	30	19	16	16	-	-	2	8	1750	12
GN 853-320-TT-NI	19	40	44	-	35	35	-	-	M8	6.7	6.7	38.5	30	-	153	-	76.5	-	34	44.5	32	19	19	-	-	3	13	4000	36
GN 853-700-TT-NI	28	60	54	-	50	50	-	-	M10	8.5	8.5	53	40.5	-	222	-	93	-	42	51	38	41.5	31	-	-	3.5	19	7500	78
GN 853-160-TU-NI	13	26	28	-	26	-	35	-	M6	4.5	4.5	27	-	20.5	103	-	-	54	28	30	19	16	-	-	25.4	2	8	1750	12
GN 853-320-TU-NI	19	40	44	-	35	-	38	-	M8	6.7	6.7	38.5	-	28	153	-	-	76.5	34	44.5	32	19	-	-	25.4	3	13	4000	38
GN 853-700-TU-NI	28	60	54	-	50	-	50	-	M10	8.5	8.5	53	-	39	222	-	-	92	42	51	38	41.5	-	-	31	3.5	19	7500	85



STANDARD MACHINE ELEMENTS WORLDWIDE