

GN 853

Latch clamps

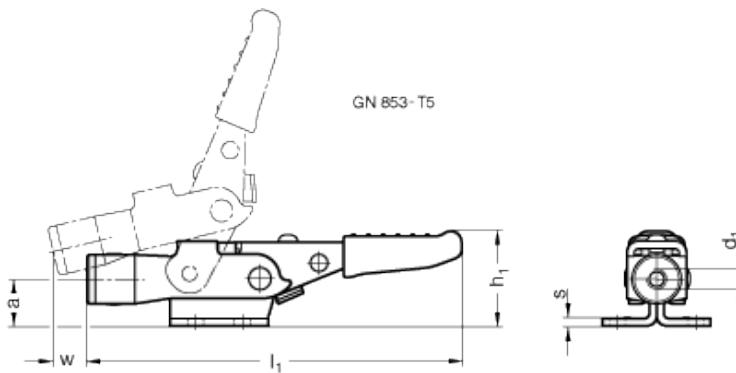

ELESA Original design



GN 853-T5

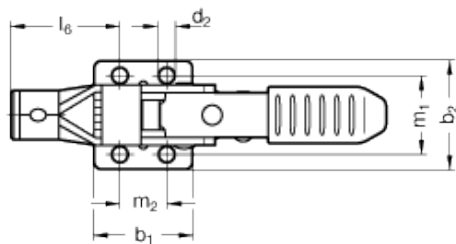

GN 853-TG

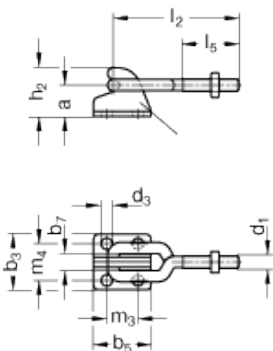

GN 853-TT

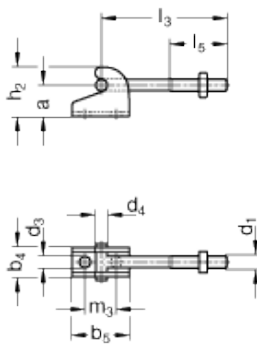

GN 853-TU

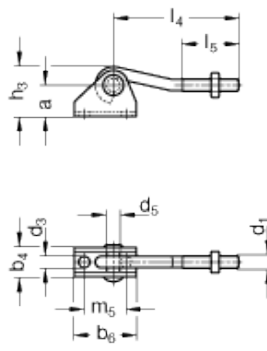

technical informations

Parts in sheet metal

Case-hardened steel C10, blackened.

Tie-rod

Steel St 32, blackened.

Assembly

All moving parts lubricated with special grease.

Handle

Oil-resistant, solid plastic, red colour.





Standard executions available

- Version T5: without tie-rod, without latch bracket.
- Version TG: with tie-rod, with latch bracket, tie-rod with drawbar eye.
- Version TT: with tie-rod, with latch bracket, tie-rod with T-piece.
- Version TU: with tie-rod, with latch bracket, tie-rod with hook.

Features and applications

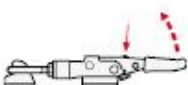
The latch clamp GN 853 also features a locking mechanism which prevents the inadvertent or vibration-induced opening of the clamp.

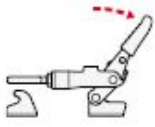
Another benefit is the option of operating the clamp with one hand.

Description of function (for one-hand operation)	
	Press the release button for releasing.
	Lift the clamping arm until the tie-rod disengages from the latch bracket.
	Retracting the clamping arm will lift the tie-rod and release the latch bracket (one-hand operation).
	For clamping operation, lift the clamping arm until it rests on the latch bracket.
	The clamping arm engages in the latch bracket if the releasing button is pressed for the clamping operation. When clamping in the end position, the system locks automatically by spring force.

Standard Elements	Main dimensions																										Stroke	Holding force	Weight
Description	a	b ₁	b ₂	b ₃	b ₄	b ₅	b ₆	b ₇	d ₁	d ₂	d ₃	h ₁ ≈	h ₂	h ₃	l ₁ ≈	l ₂ ≈	l ₃	l ₄	l ₅	l ₆	m ₁	m ₂	m ₃	m ₄	m ₅	s	w ₂	FH in N	g
GN 853-160-T5	13	26	28	-	-	-	-	-	M6	4.5	-	27	-	-	103	-	-	-	-	30	19	16	-	-	-	2	8	1750	80
GN 853-320-T5	19	40	44	-	-	-	-	-	M8	6.7	-	38.5	-	-	153	-	-	-	-	44.5	32	16	-	-	-	3	13	4000	29
GN 853-700-T5	28	60	54	-	-	-	-	-	M10	8.5	-	54	-	-	222	-	-	-	-	51	38	41.5	-	-	-	3.5	19	7500	68
GN 853-160-TG	13	26	28	23	-	26	-	6.8	M6	4.5	4.5	27	20	-	103	55	-	-	28	30	19	16	16	14.3	-	2	8	1750	13
GN 853-320-TG	19	40	44	34	-	35	-	10	M8	6.7	6.7	38.5	30	-	153	76.5	-	-	34	44.5	32	19	1	22.3	-	3	13	4000	38
GN 853-700-TG	28	60	54	41	-	50	-	11	M10	8.5	8.5	53	40.5	-	222	95.5	-	-	42	51	38	41.5	31	25.4	31	3.5	19	7500	88
GN 853-160-TT	13	26	28	-	26	26	-	-	M6	4.5	4.5	27	20	-	103	-	55	-	28	30	19	16	16	-	-	2	8	1750	12
GN 853-320-TT	19	40	44	-	35	35	-	-	M8	6.7	6.7	38.5	30	-	153	-	76.5	-	34	44.5	32	19	19	-	-	3	13	4000	36
GN 853-700-TT	28	60	54	-	50	50	-	-	M10	8.5	8.5	53	40.5	-	222	-	93	-	42	51	38	41.5	31	-	-	3.5	19	7500	84
GN 853-160-TU	13	26	28	-	26	-	35	-	M6	4.5	4.5	27	-	20.5	103	-	-	54	28	30	19	16	-	-	25.4	2	8	1750	10
GN 853-320-TU	19	40	44	-	35	-	38	-	M8	6.7	6.7	38.5	-	28	153	-	-	76.5	34	44.5	32	19	-	-	25.4	3	13	4000	38
GN 853-700-TU	28	60	54	-	50	-	50	-	M10	8.5	8.5	53	-	39	222	-	-	92	42	51	38	41.5	-	-	31	3.5	19	7500	84



STANDARD MACHINE ELEMENTS WORLDWIDE