

GN 844

Plunger clamps for push-pull clamping

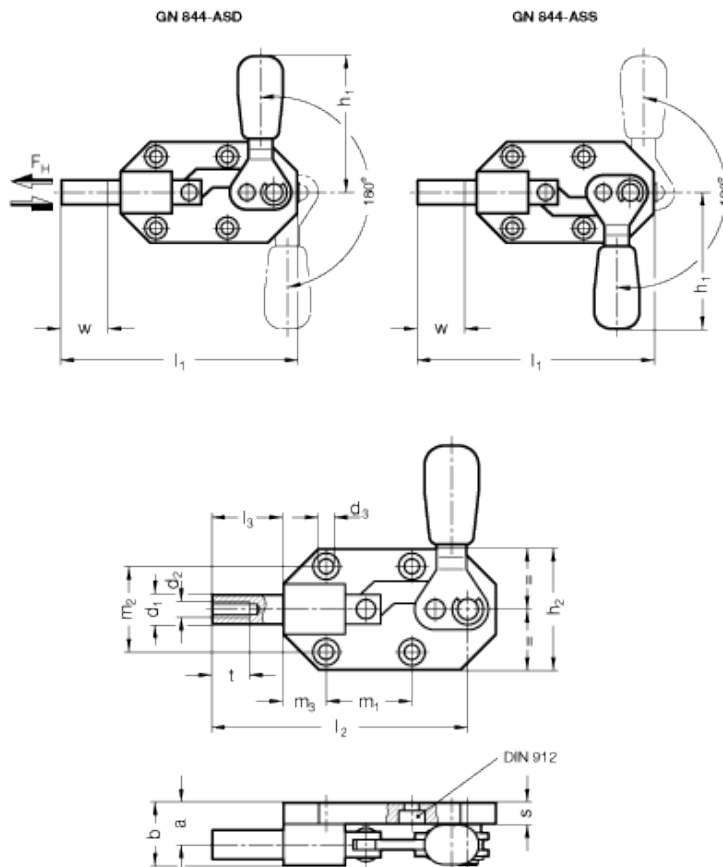

technical informations

Base

Black-oxide brass.

Body and metal parts

Zinc-plated case-hardened steel C10, blue passivated.

- Version ASS: with clamping action by turning the handle on the right.
- Version ASD: with clamping action by turning the handle on the left.

Plunger

Zinc-plated steel, blue passivated.

Handle

Oil-resistant, solid plastic, red colour.

Features

All moving parts are lubricated with special grease. GN 844 plunger clamps are known for their low height in all clamping positions. The hot forged brass body gives the clamp stability. In addition brass offers excellent gliding characteristics for guiding the plunger.

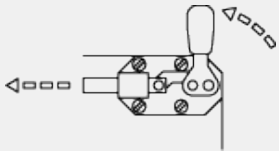

| Standard Elements | Main dimensions | | | | | | | | | | | | | | | | Stroke | Holding force | Weight |
|-------------------|-----------------|------|----------------|----------------|----------------|------------------|----------------|------------------|------------------|------------------|----------------|----------------|----------------|----------------|----|----|--------|---------------|--------|
| Description | a | b | d ₁ | d ₂ | d ₃ | h ₁ ≈ | h ₂ | l ₁ ≈ | l ₂ ≈ | l ₃ ≈ | m ₁ | m ₂ | m ₃ | m ₄ | s | t | w | FH [N] | g |
| GN 844-70-ASD | 12 | 19.5 | 8.5 | M6 | 4.3 | 49 | 36 | 86 | 77 | 22 | 26 | 26 | 13 | - | 6 | 12 | 20 | 900 | 180 |
| GN 844-160-ASD | 15 | 25 | 11 | M6 | 5.3 | 79 | 46 | 117 | 107 | 32 | 36.5 | 33.5 | 11 | - | 10 | 12 | 30 | 1300 | 400 |
| GN 844-550-ASD | 20 | 32 | 14 | M8 | 7 | 113 | 55 | 165 | 153 | 42 | 35 | 41 | 15 | 41 | 7 | 16 | 42 | 4500 | - |
| GN 844-70-ASS | 12 | 19.5 | 8.5 | M6 | 4.3 | 49 | 36 | 86 | 77 | 22 | 26 | 26 | 13 | - | 6 | 12 | 20 | 900 | 180 |
| GN 844-160-ASS | 15 | 25 | 11 | M6 | 5.3 | 79 | 46 | 117 | 107 | 32 | 36.5 | 33.5 | 11 | - | 10 | 12 | 30 | 1300 | 400 |
| GN 844-550-ASS | 20 | 32 | 14 | M8 | 7 | 113 | 55 | 165 | 153 | 42 | 35 | 41 | 15 | 41 | 7 | 16 | 42 | 4500 | - |



STANDARD MACHINE ELEMENTS WORLDWIDE