

GN 820.2

Horizontal clamps

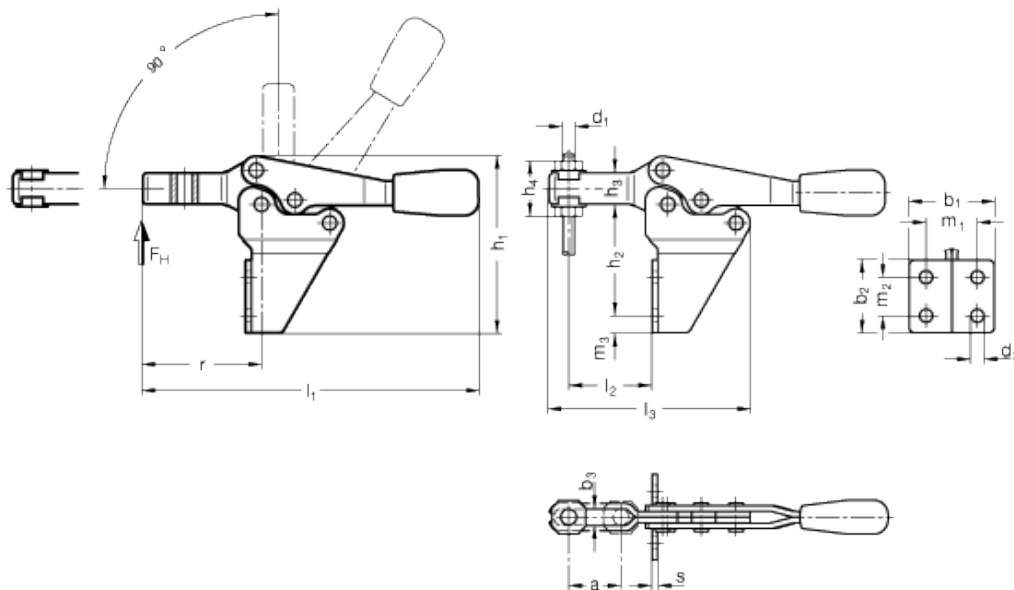

technical informations

Sheet body and metal parts

Zinc-plated case-hardened steel C10, blue passivated.

Bearing pin

Tempered steel.

Bearing bushes

Case-hardened steel (available from size ≥ 355).

Assembly

All moving parts lubricated with special grease.

Handle

Oil-resistant, solid plastic, red colour.

Standard versions available

Version MF: with forked clamping arm with two stepped side washers.

Accessories on request

- Clamping bolts to be ordered separately.
- Holders for clamping bolts GN 801.

Features and applications

Horizontal clamps GN 820.2 are designed to ensure that, when opening, the operator's fingers are not trapped between the clamping lever and the clamping arm (safety distance).

Standard Element	Main dimensions																			Holding force	Weight
Description	a	b ₁	b ₂	b ₃	d ₁	d ₂	h ₁	h ₂	h ₃	h ₄	l ₁	l ₂	l ₃	m ₁	m ₂	m ₃	r	s	FH in N	g	
GN 820.2-75-MF	20	30	25.5	5.5	M5	4.5	62	39	11	22.5	118	30	72	18	13.5	6	42.5	2	900	105	
GN 820.2-130-MF	32	39	35	6.5	M6	5.5	85	58.5	14	27	170	45	95	26	22	6.5	61	2.5	1000	240	
GN 820.2-230-MF	37	43	40	8.5	M8	6.5	102	69	18	35	195	52	113	28.5	24	8	70	3	1700	400	
GN 820.2-355-MF	58	52	52	10.5	M10	8.5	135	92	22	43	270	85	166	32	32	10	108.5	3.5	1800	840	



STANDARD MACHINE ELEMENTS WORLDWIDE