

GN 810-NI

Vertical clamps with horizontal base

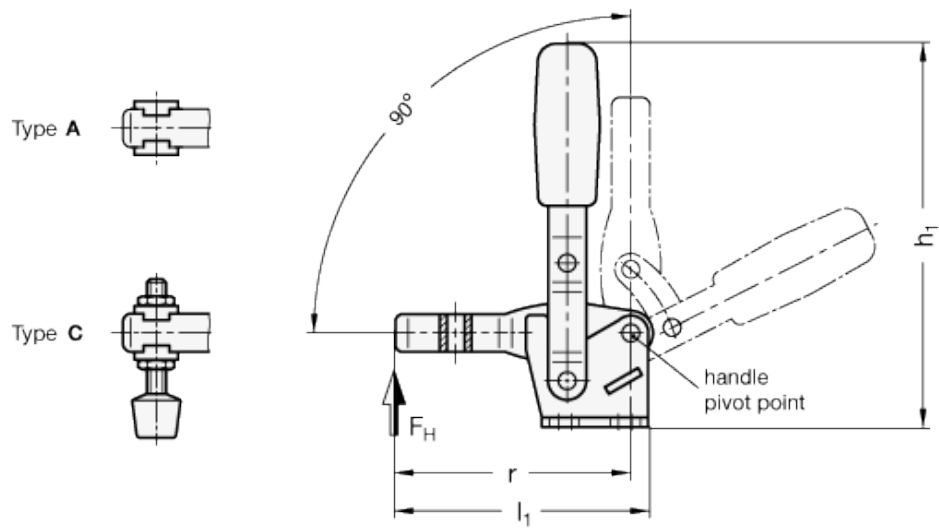



Operating principle

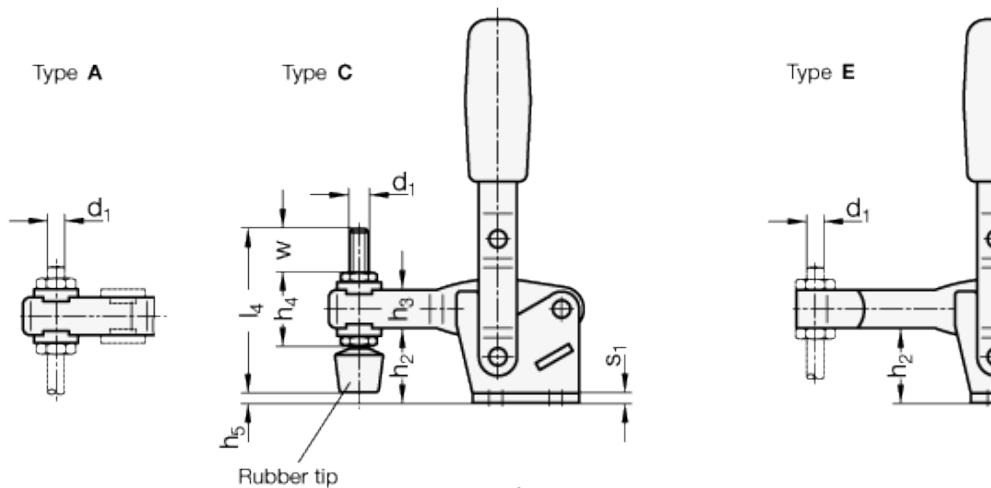
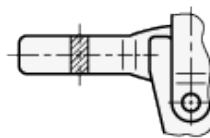
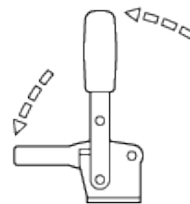

Flanged washers, movable

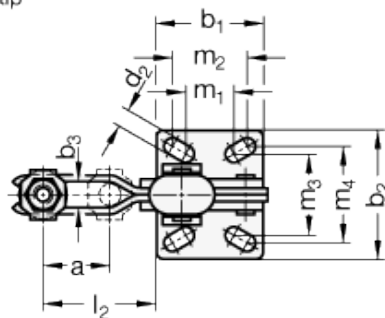
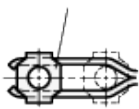

Clasp, weldable

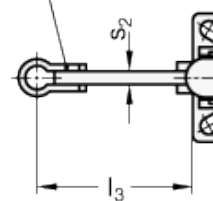

technical informations

Specification

Types

- Type A: U-bar Version, with two flanged washers
- Type C: U-bar Version, with two flanged washers and GN 708.1 spindle assembly
- Type E: Solid bar Version with clasp

Stainless Steel NI
AISI 304

All moving parts lubricated with Special grease

Hand grip
High Quality, oil resistant red plastic

Spindle assembly GN 708.1 (Type A)
- Steel, zinc plated / Stainless Steel, AISI 304
- Rubber tip 85 Shore A

Information

GN 810 vertical acting toggle clamps work according to the toggle principle: lever and clamping bar move in the same direction. In the clamped position the operating lever is in its vertical position. Vertical acting toggle clamps in the U-bar version with two flanged washers (Type A) can accommodate an application specific clamping screw. A spindle assembly with neoprene rubber tip is also included for Type C. Type E version can either be utilized by welding the clasp which can then accommodate an application specific hold-down fastener component, or by utilizing the bar in conjunction with the GN 809 Clamp Mounts to hold the work piece in place.

Accessory

- Spindle assemblies
- GN 801 Clamp Mounts for Toggle Clamps (for Type A)
- GN 809 Clamp Mounts for Toggle Clamps (for Type E)

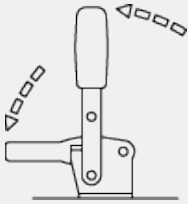

Standard Elements	Main dimensions																				Holding force	Weight			
Description	a	b ₁	b ₂	b ₃	d ₁	d ₂	h ₁	h ₂	h ₃	h ₄	h ₅	l ₁	l ₂	l ₃ max.	l ₄	m ₁	m ₂	m ₃	m ₄	r	s ₁	s ₂	w	FH [N]	g
GN 810-75-A-NI	20	29	34	5.2	M5	4.5	98	20.5	11	-	-	66.5	31.5	-	-	15	16	24	24	62.5	2	-	-	750	95
GN 810-130-A-NI	28	35	42	6.2	M6	5.5	142	28	16	-	-	85	42	-	-	12.5	19	27	29	79.5	2.5	-	-	1050	234
GN 810-230-A-NI	40	43	45	8.5	M8	6.5	168	33.5	18	-	-	110.5	58	-	-	19	20	32	32	104	3	-	-	2000	372
GN 810-75-C-NI	20	29	34	5.2	M5	4.5	98	20.5	11	19	5.5	66.5	31.5	-	45	15	16	24	24	62.5	2	-	15	750	95
GN 810-130-C-NI	28	35	42	6.2	M6	5.5	142	28	16	25.5	11.3	8.5	42	-	55	12.5	19	27	29	79.5	2.5	-	17.5	1050	210
GN 810-230-C-NI	40	43	45	8.5	M8	6.5	168	33.5	18	30	9.5	110.5	58	-	68	19	20	32	32	104	3	-	20	2000	350
GN 810-75-E-NI	-	29	34	-	M5	4.5	98	20.5	11	19	-	67	-	41	-	15	16	24	24	62.5	2	4	-	750	95
GN 810-130-E-NI	-	35	42	-	M6	5.5	142	28	14	25.5	-	86	-	54	-	12.5	19	27	29	79.5	2.5	5	-	1050	210
GN 810-230-E-NI	-	43	45	-	M8	6.5	168	33.5	18	30	-	112	-	73	-	19	20	32	32	104	3	6	-	2400	350



STANDARD MACHINE ELEMENTS WORLDWIDE