

GN 810

Vertical clamps with horizontal base

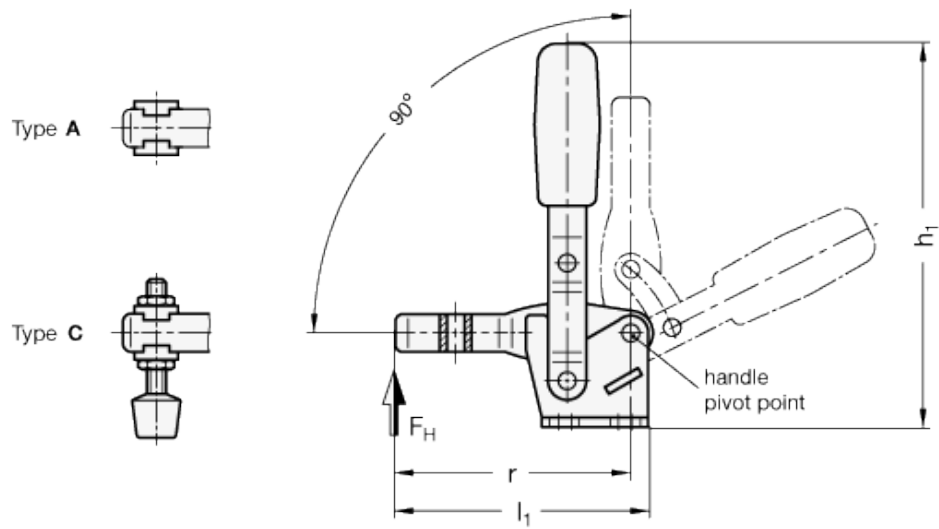



Operating principle

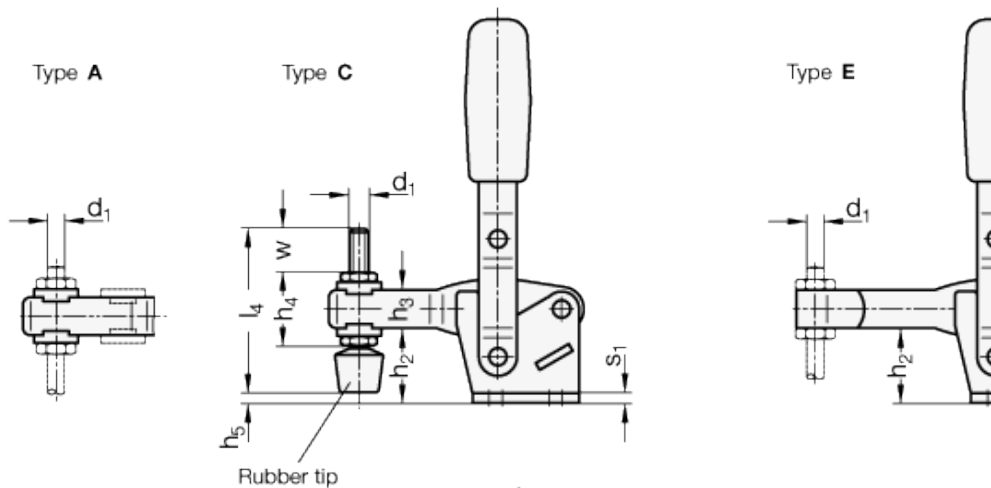
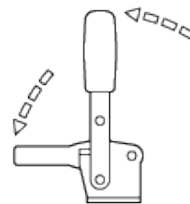

Flanged washers, movable

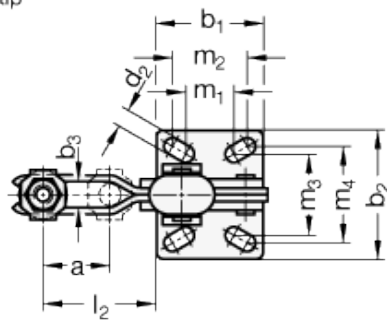
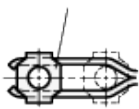

Clasp, weldable

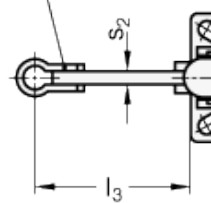

technical informations

Specification

Types

- Type A: U-bar Version, with two flanged washers
- Type C: U-bar Version, with two flanged washers and GN 708.1 Spindle Assembly
- Type E: Solid bar Version, with clasp

Steel

- Case-hardened Steel C10
zinc plated, blue passivated

- Bearing Pins tempered
- BEaring rivets (for size 230 and up)case hardened

All moving parts
lubricated with Special grease

Hand grip
High Quality, oil resistant red plastic

- Spindle assembly GN 708.1 (Type A) - Steel, zinc plated / Stainless Steel, AISI 304
- Rubber tip 85 Shore A

Information

GN 810 vertical acting toggle clamps work according to the toggle principle: lever and clamping bar move in the same direction. In the clamped position the operating lever is in its vertical Position.
Vertical acting toggle clamps in the U-bar version with two flanged washers (Type A) can accommodate an application specific clamping screw. A spindle assembly with neoprene rubber tip is also included for Type C.
Type E version can either be utilized by welding the clasp which can then accommodate an application specific hold-down fastener component, or by utilizing the bar in conjunction with the GN 809 Clamp Mounts to hold the work piece in place.

Accessory

- Spindle assemblies
- GN 801 Clamp Mounts for Toggle Clamps (for Type A)
- GN 809 Clamp Mounts for Toggle Clamps (for Type E)

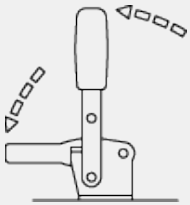

Standard
Elements

Main dimensions

Holding
force

Weig

Description	a	b ₁	b ₂	b ₃	d ₁	d ₂	h ₁	h ₂	h ₃	h ₄	h ₅	l ₁	l ₂	l ₃ max.	l ₄	m ₁	m ₂	m ₃	m ₄	r	s ₁	s ₂	w	FH [N]	g
GN 810-75-A	20	29	34	5.2	M5	4.5	98	20.5	11	-	-	66.5	31.5	-	-	15	16	24	24	62.5	2	-	-	750	95
GN 810-130-A	28	35	42	6.2	M6	5.5	142	28	16	-	-	85	42	-	-	12.5	19	27	29	79.5	2.5	-	-	1050	210
GN 810-230-A	40	43	45	8.5	M8	6.5	168	33.5	18	-	-	110.5	58	-	-	19	20	32	32	104	3	-	-	2000	350
GN 810-330-A	42	50	65	10.5	M10	8.5	195	43	22	-	-	129	66	-	-	29	32	46	45	122	3.5	-	-	2400	550
GN 810-430-A	64	58	65	12.5	M12	8.5	247	55.5	26	-	-	164	88	-	-	32	32	45	45	156	4	-	-	2800	1000
GN 810-530-A	90	80	95	12.5	M12	12.5	303	84.5	32	-	-	223	125	-	-	50	51	70	70	212	7	-	-	4500	1950
GN 810-75-C	20	29	34	5.2	M5	4.5	98	20.5	11	19	5.5	66.5	31.5	-	45	15	16	24	24	62.5	2	-	15	750	95
GN 810-130-C	28	35	42	6.2	M6	5.5	142	28	16	25.5	11.3	8.5	42	-	55	12.5	19	27	29	79.5	2.5	-	17.5	1050	210
GN 810-230-C	40	43	45	8.5	M8	6.5	16.8	33.5	18	30	9.5	110.5	58	-	68	19	20	32	32	104	3	-	20	2000	350
GN 810-330-C	42	50	65	10.5	M10	8.5	195	43	22	37	15	129	66	-	77	29	32	46	45	122	3.5	-	19	2400	550
GN 810-430-C	64	58	65	12.5	M12	8.5	247	55.5	26	43	23	164	88	-	100	32	32	45	45	156	4	-	33	2800	1000
GN 810-530-C	90	80	95	12.5	M12	12.5	303	84.5	32	49	52	223	125	-	100	50	51	87	70	212	7	-	27	4500	1950
GN 810-75-E	-	29	34	-	M5	4.5	98	20.5	11	19	-	67	-	41	-	15	16	24	24	62.5	2	4	-	750	95
GN 810-130-E	-	35	42	-	M6	5.5	142	28	14	25.5	-	86	-	54	-	12.5	19	27	29	79.5	2.5	5	-	1050	210
GN 810-230-E	-	43	45	-	M8	6.5	168	33.5	18	30	-	112	-	73	-	19	20	32	32	104	3	6	-	2400	350
GN 810-330-E	-	50	65	-	M10	8.5	195	43	22	38	-	166	-	86	-	29	32	46	-	122	3.5	7	-	2700	550
GN 810-430-E	-	58	65	-	M12	8.5	247	55.5	26	43	-	166	-	114	-	32	32	45	45	156	4	10	-	2800	1000
GN 810-530-E	-	80	95	-	M12	12.5	303	84.5	32	49	-	225	-	152	-	50	51	70	70	212	7	10	-	4500	1950



STANDARD MACHINE ELEMENTS WORLDWIDE