

GN 798.3

Fold-away handles

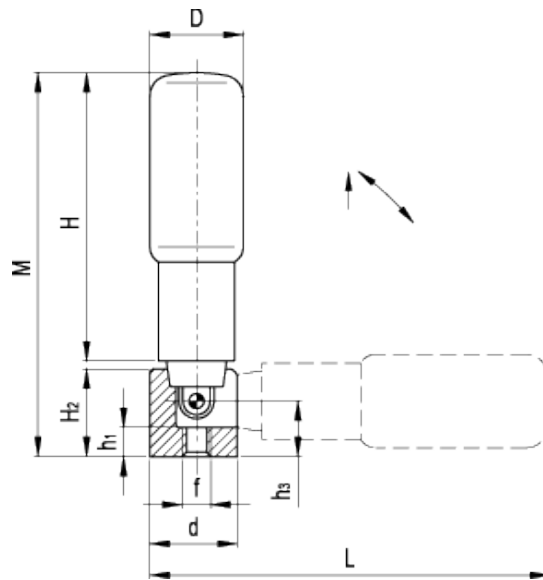

technical informations

Handle

Polyamide-based (PA) technopolymer.

Colour

Black, matte finish.

Stud

Black-oxide steel.

Flat base

Black-oxide steel.

Applications

GN 798.3 fold-away handles are suitable when the handle must be withdrawn during automatic operations.

Instructions of use

The handle is pulled out of its taper seating in the direction of the arrow and then tilted. A compression spring locks the handle in both end positions. A positive lock is achieved in the operating position by way of a taper seating.

Ergonomy and design

Typical in design is the stepped shape consisting of two cylinders giving the operator a better grip, especially when pulling the handle out from its locked position before it can be folded back into the rest position.

Standard Elements	Main dimensions							Mounting hole		Weight
Description	H	L	M	D	H ₂	d	h ₃	f	h ₁	g
GN 798.3-KT-16	41.5	60.5	58	16	15	16	9.5	M5	5	35
GN 798.3-KT-18	56	75	72.5	18	15	16	9.5	M5	5	41
GN 798.3-KT-22	59	84	80.5	22	19.5	20	10.5	M6	6	80
GN 798.3-KT-24	74	99	95.5	24	19.5	20	10.5	M6	6	90
GN 798.3-KT-25	84	108.5	105.5	25	19.5	20	10.5	M6	6	110



STANDARD MACHINE ELEMENTS WORLDWIDE