

Semi-split Stainless Steel- Shaft collars

with extension-tapped holes

SPECIFICATION

TYPES

- Type **A**: Extension-tapped holes, radial
- Type **B**: Extension-tapped holes, axial

Stainless Steel **NI**
Sintered Steel AISI 316 LHC
Socket head cap screw DIN 912
Stainless Steel AISI 304

INFORMATION

With extension-tapped holes of the semi-split Stainless Steel-Shaft collars GN 7062.1, sensor holders GN 7062.10 (see page) or other elements such as the gear lever or cam can be attached to shafts and axles.

They can be assembled safely and easily with a high clamping force by reducing the slot height, without damaging the surface of shafts and axles.

The thread d_3 for sizes $d_1 = 30$ to 36 is designed as a through hole; for sizes $d_1 = 42$ and larger, it is designed as blind hole.

TECHNICAL INFORMATION

- ISO-Fundamental tolerances (see page A21)
- Stainless Steel characteristics (see page A26)



ACCESSORY

- Adjustable hand levers GN 311 (see page)
- Damping washer GN 7062.30 (see page)
- Stainless Steel-Sensor holders GN 7062.10 (see page)

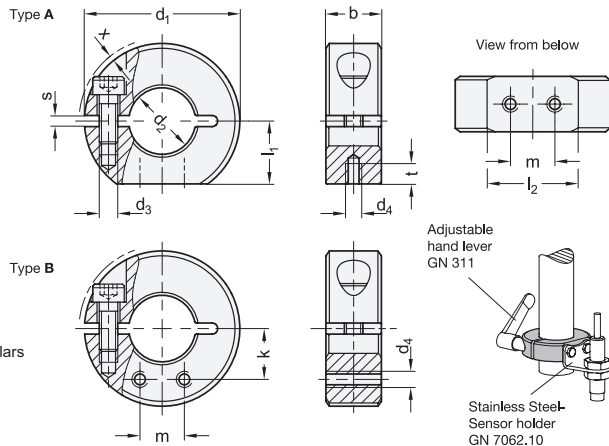

* Complete with type index of the Split Stainless Steel-Shaft collars

- A** Extension-tapped holes, radial **B** Extension-tapped holes, axial

GN 7062.1

Description	d_1	d_2 H10		d_3	d_4	l_1	l_2	m	s	t	$x \approx$ Max. protrusion of cap screw	Adjustable hand lever for d_3	📐
		Recommended shaft	$b \pm 0.2$										
GN 7062.1-30-B12-NI-*	30	B 12	11	M 4	M 3	13	15	8	2.1	4	0.7	311-30-M4-12-SW	38
GN 7062.1-32-B14-NI-*	32	B 14	11	M 4	M 3	14	15.5	8	2.1	4	0.7	311-30-M4-12-SW	42
GN 7062.1-36-B15-NI-*	36	B 15	13	M 5	M 4	15	19.9	10	2.1	5.5	1.4	311-30-M5-13-SW	67
GN 7062.1-36-B16-NI-*	36	B 16	13	M 5	M 4	15	19.9	10	2.1	5.5	1.4	311-30-M5-13-SW	61
GN 7062.1-42-B18-NI-*	42	B 18	15	M 5	M 4	17	24.7	12	3	5.5	0.6	311-30-M5-15-SW	91
GN 7062.1-42-B20-NI-*	42	B 20	15	M 5	M 4	17	24.7	12	3	5.5	0.6	311-30-M5-15-SW	88
GN 7062.1-48-B22-NI-*	48	B 22	15	M 5	M 4	20	26.5	12	3	5.5	0	311-45-M5-16-SW	121
GN 7062.1-48-B25-NI-*	48	B 25	15	M 5	M 4	20	26.5	12	3	5.5	0	311-45-M5-16-SW	111
GN 7062.1-55-B28-NI-*	55	B 28	15	M 6	M 5	22.5	31.6	18	3	7	0.5	311-45-M6-18-SW	145
GN 7062.1-55-B30-NI-*	55	B 30	15	M 6	M 5	22.5	31.6	18	3	7	0.5	311-45-M6-18-SW	140
GN 7062.1-60-B32-NI-*	60	B 32	15	M 6	M 5	25	33.2	18	4	7	0.4	311-45-M6-19-SW	184
GN 7062.1-60-B35-NI-*	60	B 35	15	M 6	M 5	25	33.2	18	4	7	0.4	311-45-M6-19-SW	156
GN 7062.1-65-B40-NI-*	65	B 40	15	M 6	M 5	27.5	34.6	18	4	7	0.5	311-45-M6-20-SW	175

Weight Type A