

# GN 666-NG

Tubular handles

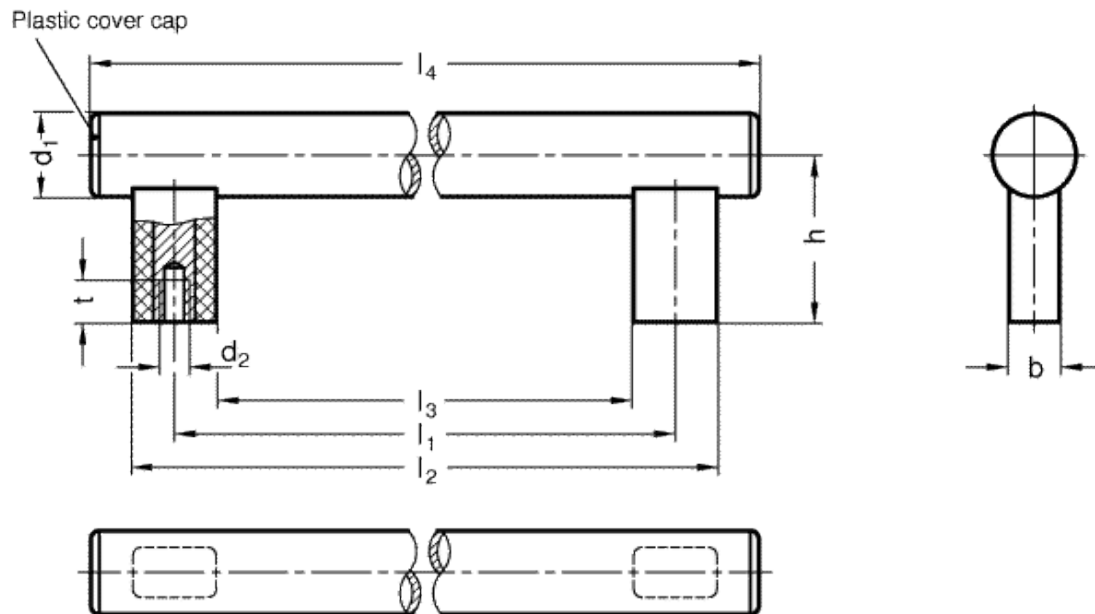

INOX  
Stainless Steel



## technical informations

### Tube

AISI 304 stainless steel NG, ground matte shiny finish.  
Highly resistant to wear, scratches and chemical agents.

### Handle shanks and side end caps

Glass-fibre reinforced polyamide based (PA) technopolymer, black colour, matte finish, temperature resistant up to 100° C.

### Assembly

Back mounting, zinc-plated steel threaded bushings.

### Features and applications

GN 666-NG tubular handles offer an even more extensive size range for any application which require mounting from the back.

*Other executions available on request (For sufficient quantities)*

Different lengths.

Standard Elements	Main dimensions									Weight
Description	d <sub>1</sub>	d <sub>2</sub>	l <sub>1</sub>	b	h	l <sub>2</sub>	l <sub>3</sub>	l <sub>4</sub>	t min.	g
GN 666-30-M6-200-NG	30	M6	200	18	60	230	170	265	12	380
GN 666-30-M6-250-NG	30	M6	250	18	60	280	220	315	12	440
GN 666-30-M6-300-NG	30	M6	300	18	60	330	270	365	12	485
GN 666-30-M6-350-NG	30	M6	350	18	60	380	320	415	12	520
GN 666-30-M6-400-NG	30	M6	400	18	60	430	370	465	12	680
GN 666-30-M6-500-NG	30	M6	500	18	60	530	470	565	12	700
GN 666-30-M6-600-NG	30	M6	600	18	60	630	570	665	12	775
GN 666-30-M8-200-NG	30	M8	200	18	60	230	170	265	15	380
GN 666-30-M8-250-NG	30	M8	250	18	60	280	220	315	15	415
GN 666-30-M8-300-NG	30	M8	300	18	60	330	270	365	15	481
GN 666-30-M8-350-NG	30	M8	350	18	60	380	320	415	15	540
GN 666-30-M8-400-NG	30	M8	400	18	60	430	370	465	15	578
GN 666-30-M8-500-NG	30	M8	500	18	60	530	470	565	15	685
GN 666-30-M8-600-NG	30	M8	600	18	60	630	570	665	15	740



STANDARD MACHINE ELEMENTS WORLDWIDE