

# GN 666.4

Arch-shaped handles

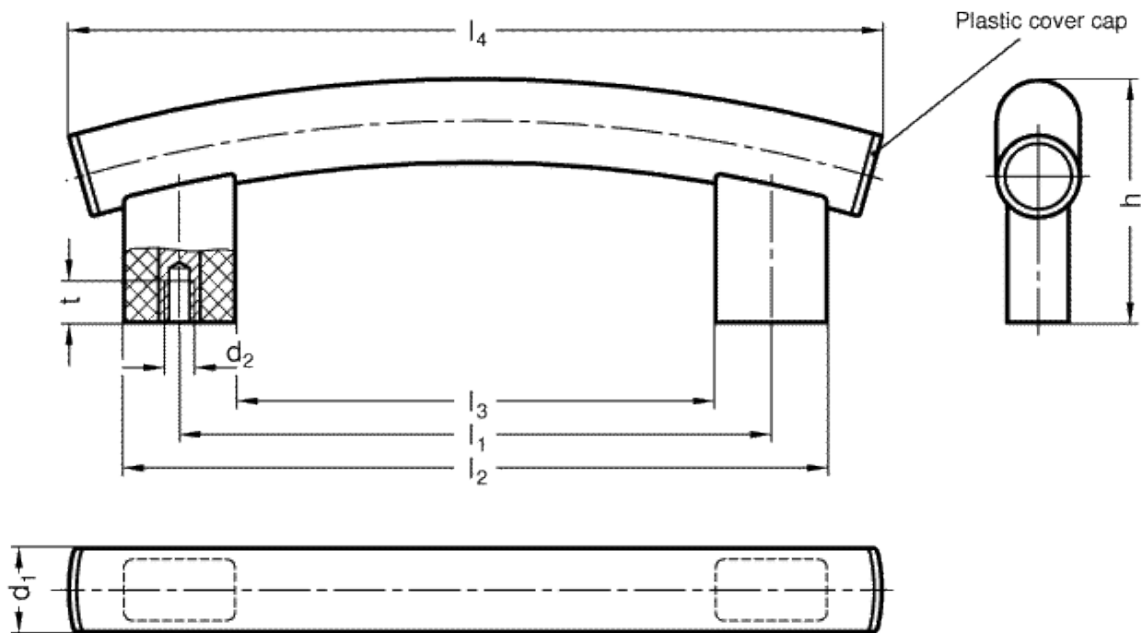

technical informations

**Tube**

Aluminium.

**Handle shanks**

Aluminium, black, matte finish, epoxy resin coating.

**Tube end caps**

Polyamide based (PA) technopolymer, glass fibre reinforced.  
Temperature resistant up to 100 °C.

## Finish

- Version SW:

Tube / Handle shanks: RAL 9005 black, matte finish, epoxy resin coating.

Tube end caps: black, matte finish.

- Version EL:

Tube: anodised, natural colour.

Handle shanks: RAL 9005 black colour, matte finish, epoxy resin coating.

Tube end caps: black, matte finish.

- Version ES: Tube: anodised, natural colour.

Handle shanks: RAL 9006 silver colour, matte finish.

Tube end caps: light grey, matte finish.

## Assembly

Back mounting, zinc-plated steel threaded bushings.

## Features and applications

With their curved type, GN 666.4 tubular arch handles highlight modern machine design.

The production method used allows special solutions to be realised, e. g. with other radii of curvature or other leg heights.

Standard Elements	Main dimensions									Weight
Description	d <sub>1</sub>	d <sub>2</sub>	l <sub>1 ±1</sub>	b	h	l <sub>2</sub>	l <sub>3</sub>	l <sub>4</sub>	t <sub>min.</sub>	g
GN 666.4-30-M6-400-SW	30	M6	400	22	90	440	360	480	15	365
GN 666.4-30-M6-400-EL	30	M6	400	22	90	440	360	480	15	365
GN 666.4-30-M6-400-ES	30	M6	400	22	90	440	360	480	15	350
GN 666.4-30-M6-500-SW	30	M6	500	22	94	540	460	580	15	416
GN 666.4-30-M6-500-EL	30	M6	500	22	94	540	460	580	15	400
GN 666.4-30-M6-500-ES	30	M6	500	22	94	540	460	580	15	360
GN 666.4-30-M6-600-SW	30	M6	600	22	98	640	560	680	15	460
GN 666.4-30-M6-600-EL	30	M6	600	22	98	640	560	680	15	400
GN 666.4-30-M6-600-ES	30	M6	600	22	98	640	560	680	15	400
GN 666.4-30-M8-400-SW	30	M8	400	22	90	440	360	480	15	361
GN 666.4-30-M8-400-EL	30	M8	400	22	90	440	360	480	15	340
GN 666.4-30-M8-400-ES	30	M8	400	22	90	440	360	480	15	350
GN 666.4-30-M8-500-SW	30	M8	500	22	94	540	460	580	15	400
GN 666.4-30-M8-500-EL	30	M8	500	22	94	540	460	580	15	400
GN 666.4-30-M8-500-ES	30	M8	500	22	94	540	460	580	15	400
GN 666.4-30-M8-600-SW	30	M8	600	22	98	640	560	680	15	450
GN 666.4-30-M8-600-EL	30	M8	600	22	98	640	560	680	15	430
GN 666.4-30-M8-600-ES	30	M8	600	22	98	640	560	680	15	450



STANDARD MACHINE ELEMENTS WORLDWIDE