

# GN 666.1-NG

Tubular handles

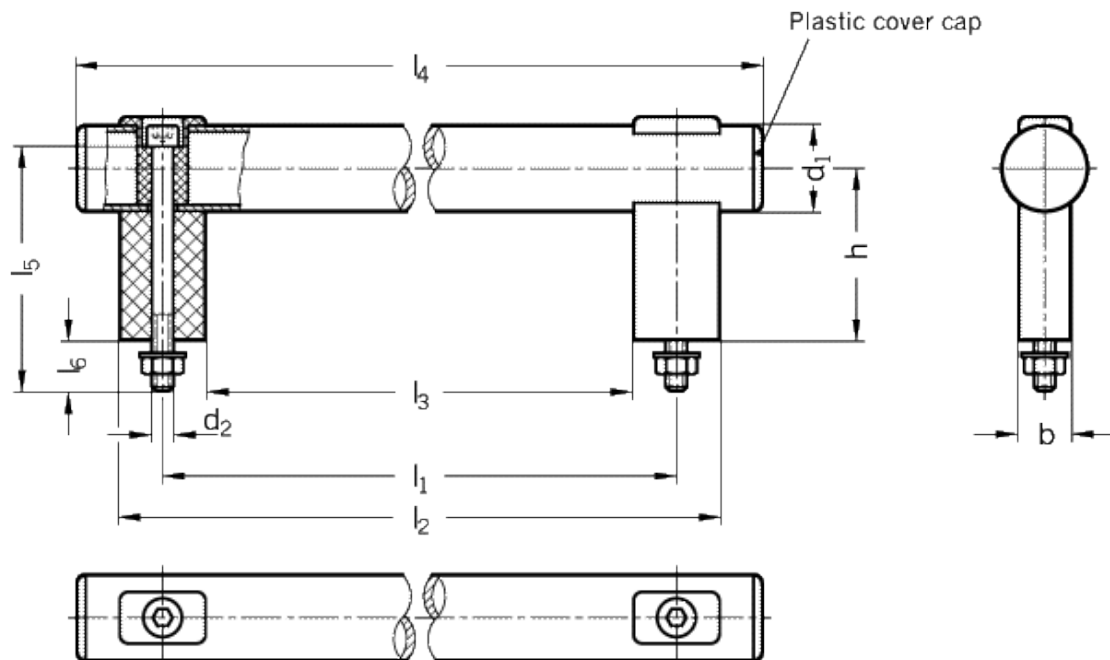

INOX  
Stainless Steel



## technical informations

### Tube

AISI 304 stainless steel NG, ground matte shiny finish.  
Highly resistant to wear, scratches and chemical agents.

### Handle shanks and tube end caps

Glass-fibre reinforced polyamide based (PA) technopolymer, black colour, matte finish, temperature resistant up to 100° C.

### Assembly

Front mounting, black zinc-plated steel socket-head DIN 912-M8-85 screws, zinc-plated steel nuts ISO 4032-M8 and zinc-plated steel washers DIN 125.

*Special executions on request (For sufficient quantities)*

Different lengths.

*Features and applications*

GN 666.1-NG tubular handles offer an even more extensive size range for any application which require mounting from the front.

Standard Elements	Main dimensions										Weight
Description	d <sub>1</sub>	l <sub>1</sub>	b	d <sub>2</sub>	h	l <sub>2</sub>	l <sub>3</sub>	l <sub>4</sub>	l <sub>5</sub>	l <sub>6</sub>	g
GN 666.1-30-200-NG	30	200	18	M8	60	230	170	265	85	17	420
GN 666.1-30-250-NG	30	250	18	M8	60	280	220	315	85	17	460
GN 666.1-30-300-NG	30	300	18	M8	60	330	270	365	85	17	518
GN 666.1-30-400-NG	30	400	18	M8	60	430	370	465	85	17	330
GN 666.1-30-500-NG	30	500	18	M8	60	530	470	565	85	17	725
GN 666.1-30-600-NG	30	600	18	M8	60	630	570	665	85	17	798



STANDARD MACHINE ELEMENTS WORLDWIDE