

# GN 6341

Washers

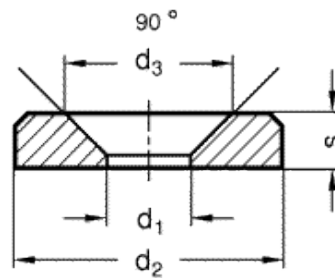
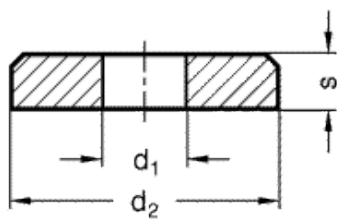

## technical informations

### Material

Steel ST, turned.

### Finish

- Blackened BT.
- Zinc-plated ZB, blue passivated.

### Types

- Type A: with cylindrical bore.
- Type B: with bore for countersunk screw.

### Features and applications

Washers GN 6341 are used mainly in mechanical machine and jig construction when DIN 125, DIN 9021 and DIN 6340 washers no longer meet requirements.

Standard Elements	Main dimensions				Weight
Description	d <sub>1</sub> +0.5/+0.2	d <sub>2</sub>	d <sub>3</sub> Type B	s	g
GN 6341-ST-4-10-A-BT	4	10	-	2.5	2
GN 6341-ST-4-10-A-ZB	4	10	-	2.5	2
GN 6341-ST-4-10-B-BT	4	10	8.4	2.5	9
GN 6341-ST-4-10-B-ZB	4	10	8.4	2.5	9
GN 6341-ST-4-13-A-BT	4	13	-	2.5	10
GN 6341-ST-4-13-A-ZB	4	13	-	2.5	10
GN 6341-ST-4-13-B-BT	4	13	8.4	2.5	2
GN 6341-ST-4-13-B-ZB	4	13	8.4	2.5	2
GN 6341-ST-5-13-A-BT	5	13	-	3	3
GN 6341-ST-5-13-A-ZB	5	13	-	3	3
GN 6341-ST-5-13-B-BT	5	13	10.5	3	2
GN 6341-ST-5-13-B-ZB	5	13	10.5	3	2
GN 6341-ST-5-16-A-BT	5	16	-	3	2
GN 6341-ST-5-16-A-ZB	5	16	-	3	5
GN 6341-ST-5-16-B-BT	5	16	10.5	3	5
GN 6341-ST-5-16-B-ZB	5	16	10.5	3	4
GN 6341-ST-6-15-A-BT	6	15	-	4	4
GN 6341-ST-6-15-A-ZB	6	15	-	4	4
GN 6341-ST-6-15-B-BT	6	15	12.6	4	4
GN 6341-ST-6-15-B-ZB	6	15	12.6	4	4
GN 6341-ST-6-20-A-BT	6	20	-	4	9
GN 6341-ST-6-20-A-ZB	6	20	-	4	9
GN 6341-ST-6-20-B-BT	6	20	12.6	4	8
GN 6341-ST-6-20-B-ZB	6	20	12.6	4	8
GN 6341-ST-8-20-A-BT	8	20	-	5	9
GN 6341-ST-8-20-A-ZB	8	20	-	5	9
GN 6341-ST-8-20-B-BT	8	20	16.8	5	7
GN 6341-ST-8-20-B-ZB	8	20	16.8	5	7
GN 6341-ST-8-26-A-BT	8	26	-	5	18
GN 6341-ST-8-26-A-ZB	8	26	-	5	18
GN 6341-ST-8-26-B-BT	8	26	16.8	5	16
GN 6341-ST-8-26-B-ZB	8	26	16.8	5	16
GN 6341-ST-10-25-A-BT	10	25	-	6.5	20
GN 6341-ST-10-25-A-ZB	10	25	-	6.5	20
GN 6341-ST-10-25-B-BT	10	25	21	6.5	25
GN 6341-ST-10-25-B-ZB	10	25	21	6.5	25
GN 6341-ST-10-32-A-BT	10	32	-	6.5	40
GN 6341-ST-10-32-A-ZB	10	32	-	6.5	40
GN 6341-ST-10-32-B-BT	10	32	21	6.5	30
GN 6341-ST-10-32-B-ZB	10	32	21	6.5	30
GN 6341-ST-12-30-A-BT	12	30	-	7.5	34
GN 6341-ST-12-30-A-ZB	12	30	-	7.5	34

GN 6341-ST-12-30-B-BT	12	30	25.2	7.5	25
GN 6341-ST-12-30-B-ZB	12	30	25.2	7.5	25
GN 6341-ST-12-40-A-BT	12	40	-	7.5	65
GN 6341-ST-12-40-A-ZB	12	40	-	7.5	65
GN 6341-ST-12-40-B-BT	12	40	25.2	7.5	60
GN 6341-ST-12-40-B-ZB	12	40	25.2	7.5	60

---



STANDARD MACHINE ELEMENTS WORLDWIDE