

# GN 607.5

Indexing plungers

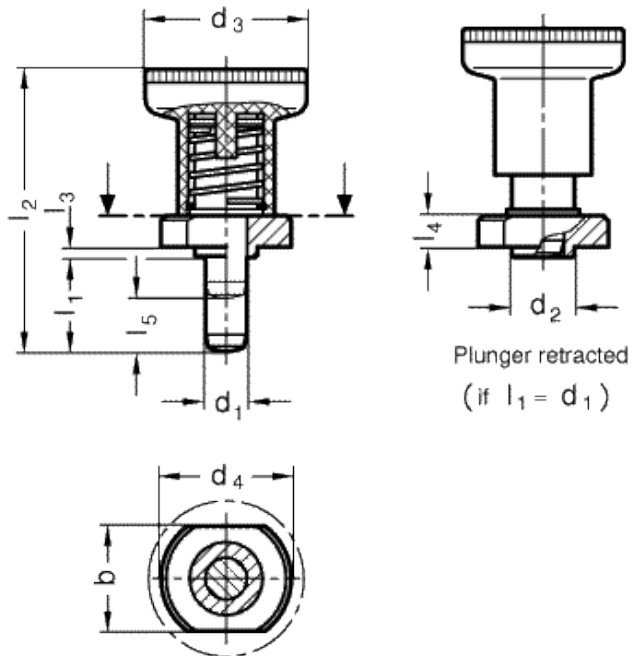

## Assembly instruction

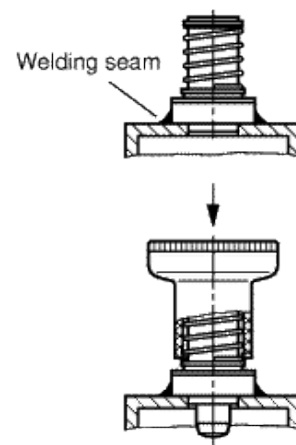

To prevent damage of the plastic knob, it will be driven onto the shaft using a plastic mallet, after the welding process.



technical informations

### Body

Black-oxide steel ST.

### Plunger

Black-oxide steel, hardened. Suggested matching hole with tolerance  $+0,03 / +0,25$ .

### Knob

Plastic, polyamide based (PA) technopolymer, black colour, matte finish, not removable.

*Features and applications*

Indexing plungers GN 607.5 with rest position are used in cases where the indexing pin is temporarily not allowed to protrude. After pulling out, the knob is turned by 90°.

An indexing notch prevents the disengaged knob accidentally or through shock impact turning back.

The GN 607.5 indexing plungers are intended for welded fixing, in particular for use in steel square tubings.

The lug  $d_2$  is intended for positioning.

The plastic knob with the in-moulded indexing pin is driven on after the welding process.

Standard Elements	Main dimensions										Spring pressure in <b>N</b> ≈		Axial load	Weight
	Description	$d_1 -0.02/-0.04$	$l_1$	b	$d_2 -0.02/-0.1$	$d_3$	$d_4$	$l_2$	$l_3$	$l_4$	$l_5$ Stroke	Preload	Max. load	in N
GN 607.5-6-6-ST	6	6	18	10	25	22	37	1.5	5.5	6	8.5	22	400	40
GN 607.5-6-14-ST	6	14	18	10	25	22	45	1.5	5.5	6	8.5	22	400	36
GN 607.5-8-8-ST	8	8	20	12	31	25	44	2	6.5	8	15.5	28	500	54
GN 607.5-8-18-ST	8	18	20	12	31	25	54	2	6.5	8	15.5	28	500	59



STANDARD MACHINE ELEMENTS WORLDWIDE