

GN 598

Revolving handles

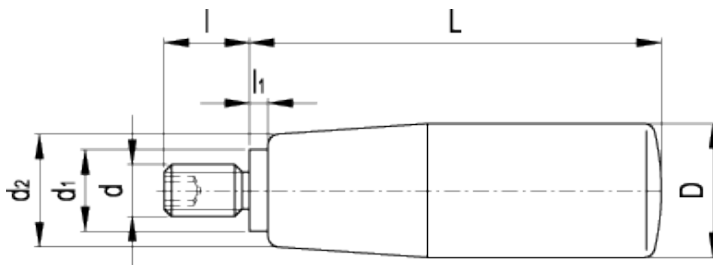

technical informations

Material

Steel.

Colour

RAL 9005 black colour, matte finish, epoxy resin coating.

Assembly

Zinc-plated steel shank, hexagon socket at threaded end.

Standard Elements	Main dimensions					Threaded shank		Weight
Description	D	L	d ₁	d ₂	l ₁	d	l	g
GN 598-ST-18-M6	18	42.5	10	15	2.5	M6	12	71
GN 598-ST-21-M6	21	52.5	10	17	2.5	M6	13	120
GN 598-ST-21-M8	21	52.5	10	17	2.5	M8	13	122
GN 598-ST-23-M8	23	67.5	13	19	2.5	M8	14	188
GN 598-ST-23-M10	23	67.5	13	19	2.5	M10	14	190
GN 598-ST-26-M8	26	82.5	13	21	2.5	M8	16	295
GN 598-ST-26-M10	26	82.5	13	21	2.5	M10	16	298
GN 598-ST-28-M10	28	92.5	13	22	2.5	M10	16	390
GN 598-ST-31-M12	31	104.5	14	25	2.5	M12	20	563



ELESA and GANTER models all rights reserved in accordance with the law. Always mention the source when reproducing our drawings.

STANDARD MACHINE ELEMENTS WORLDWIDE