

## Cabinet "U" handles

Aluminium

### SPECIFICATION

Aluminium

plastic coated

black, RAL 9005, textured finish **SW**

black, RAL 9005, textured finish, UV-resistant **SWU**

red, RAL 3000, textured finish **RS**

silver, RAL 9006, textured finish **SR**

anodized, neutral colour **EL**

blank, tumbled **BL**



### INFORMATION

GN 565.1 cabinet „U“ handles are made from a bent aluminum profile and have excellent stability and ergonomic design. Due to the production process, special designs can be supplied even in relatively small quantities.

In addition to the standard surfaces, these cabinet „U“ handles are also available with a functional coating.

The **SWU** version is coated with a highly weather-resistant and UV-protective powder coating system, making this version excellent for outdoor use.

### TECHNICAL INFORMATION

- Load rating information (see page A35)

Counterbored  
for cap screw  
DIN 912-M5 / M6

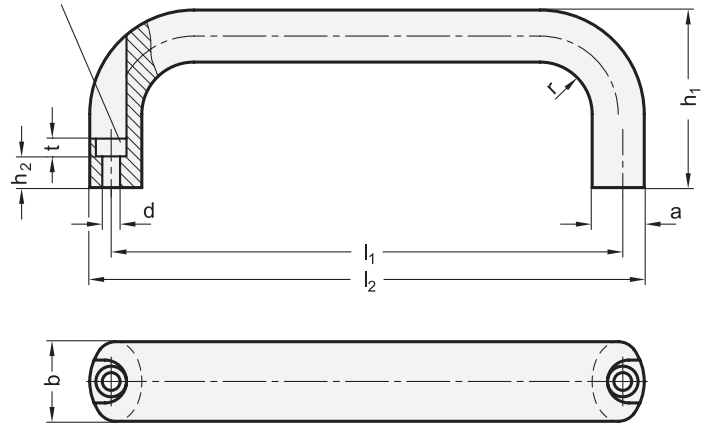

\* Complete with colour index of the Cabinet "U" handles (SW, SWU, RS, SR, WSA, EL or BL)

SW RAL9005   
 SWU RAL9005   
 RS RAL3000   
 SR RAL 9006   
 EL anodized   
 BL blank

### GN 565.1

Description	b	l1 ±0.25	a	d	h1	h2	l2	r	t	⚖️
GN 565.1-20-100-*	20	100	13	5.4	49	13.5	112	13	5.5	80
GN 565.1-20-112-*	20	112	13	5.4	49	13.5	124	13	5.5	87
GN 565.1-20-117-*	20	117	13	5.4	49	13.5	129	13	5.5	89
GN 565.1-20-120-*	20	120	13	5.4	49	13.5	132	13	5.5	90
GN 565.1-20-128-*	20	128	13	5.4	51	13.5	140	13	5.5	100
GN 565.1-20-160-*	20	160	13	5.4	51	13.5	172	13	5.5	120
GN 565.1-26-116-*	26	116	17	6.4	55	11	130	17	6	145
GN 565.1-26-120-*	26	120	17	6.4	55	11	134	17	6	149
GN 565.1-26-132-*	26	132	17	6.4	55	11	146	17	6	160
GN 565.1-26-164-*	26	164	17	6.4	57	11	178	17	6	200
GN 565.1-26-179-*	26	179	17	6.4	57	11	193	17	6	220
GN 565.1-26-196-*	26	196	17	6.4	57	11	210	17	6	226