



GN 480.7

Stainless Steel-Hose adapters

Barbed fitting / Thread



Specification

Stainless Steel

- AISI 304
- blank, unfinished

Information

GN 480.7 hose adapters can attach e.g. air nozzles or coolant nozzles and their feed pipes with clamp mountings and hold them in position.

The d_2 / d_3 thread and barbed fitting diameters are compatible with the most common bolt and internal hose diameters. Hose lines are attached to the barbed fitting with suitable hose clamps, securing them against slipping off.

Technical Information

- [Stainless Steel characteristics](#)

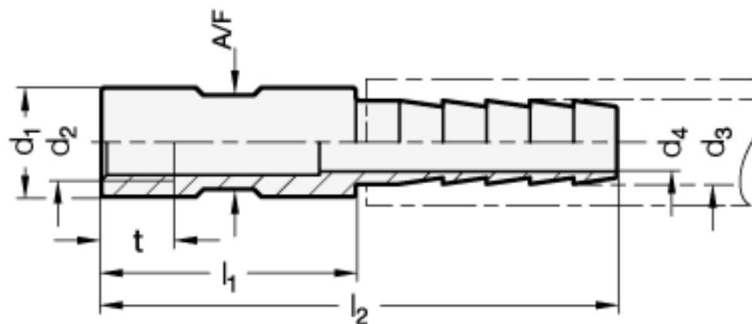

Application example

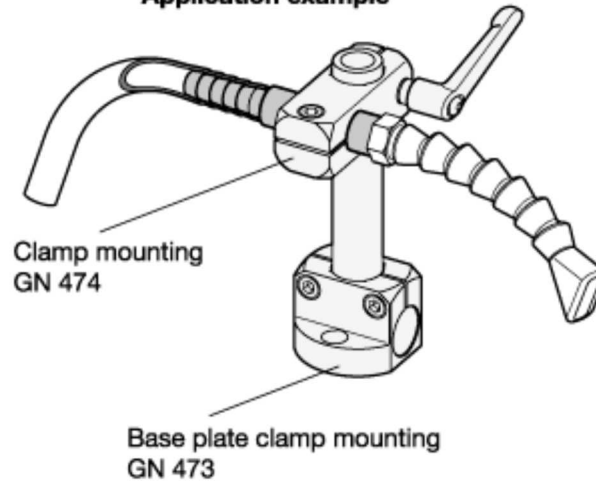

GN 480.7

| Description | d ₁ h9 | d ₂ - t | d ₃ | d ₄ | l ₁ | l ₂ | A/F | Weight |
|-------------------------|-------------------|--------------------|----------------|----------------|----------------|----------------|-----|--------|
| GN 480.7-D10-M5-4 | D 10 | M 5 - 8.5 | 4 | 2.5 | 30 | 48 | 8 | 16 |
| GN 480.7-D10-M6-4 | D 10 | M 6 - 10.5 | 4 | 2.5 | 30 | 48 | 8 | 15 |
| GN 480.7-D10-M5-6 | D 10 | M 5 - 8.5 | 6 | 4.5 | 30 | 57 | 8 | 19 |
| GN 480.7-D10-M6-6 | D 10 | M 6 - 10.5 | 6 | 4.5 | 30 | 57 | 8 | 17 |
| GN 480.7-D12-M7-6 | D 12 | M 7 - 11.5 | 6 | 4.5 | 30 | 57 | 10 | 23 |
| GN 480.7-D12-M8x1-6 | D 12 | M 8x1 - 10 | 6 | 4.5 | 30 | 57 | 10 | 21 |
| GN 480.7-D12-M7-9 | D 12 | M 7 - 11.5 | 9 | 7 | 30 | 63 | 10 | 28 |
| GN 480.7-D12-M8x1-9 | D 12 | M 8x1 - 10 | 9 | 7 | 30 | 63 | 10 | 25 |
| GN 480.7-D15-M10x1-9 | D 15 | M 10x1 - 10 | 9 | 7 | 35 | 68 | 13 | 40 |
| GN 480.7-D15-G1/8-9 | D 15 | G 1/8 - 8 | 9 | 7 | 35 | 68 | 13 | 41 |
| GN 480.7-D15-M10x1-10 | D 15 | M 10x1 - 10 | 10 | 8 | 35 | 71 | 13 | 41 |
| GN 480.7-D15-G1/8-10 | D 15 | G 1/8 - 8 | 10 | 8 | 35 | 71 | 13 | 42 |
| GN 480.7-D16-M12x1,5-10 | D 16 | M 12x1.5 - 14 | 10 | 8 | 35 | 71 | 14 | 42 |
| GN 480.7-D16-G1/8-10 | D 16 | G 1/8 - 8 | 10 | 8 | 35 | 71 | 14 | 49 |
| GN 480.7-D16-M12x1,5-12 | D 16 | M 12x1.5 - 14 | 12 | 9 | 35 | 71 | 14 | 47 |
| GN 480.7-D16-G1/8-12 | D 16 | G 1/8 - 8 | 12 | 8 | 35 | 71 | 14 | 59 |
| GN 480.7-D20-M16x1,5-12 | D 20 | M 16x1.5 - 15 | 12 | 9 | 40 | 76 | 18 | 64 |
| GN 480.7-D20-G3/8-12 | D 20 | G 3/8 - 12 | 12 | 9 | 40 | 76 | 18 | 60 |
| GN 480.7-D20-G1/4-12 | D 20 | G 1/4 - 12 | 12 | 9 | 40 | 76 | 18 | 83 |
| GN 480.7-D20-M16x1,5-16 | D 20 | M 16x1.5 - 15 | 16 | 12 | 40 | 76 | 18 | 68 |
| GN 480.7-D20-G3/8-16 | D 20 | G 3/8 - 12 | 16 | 12 | 40 | 76 | 18 | 69 |
| GN 480.7-D20-G1/4-16 | D 20 | G 1/4 - 12 | 16 | 12 | 40 | 76 | 18 | 69 |