

GN 472.3

Crank handles
with fold-away handle

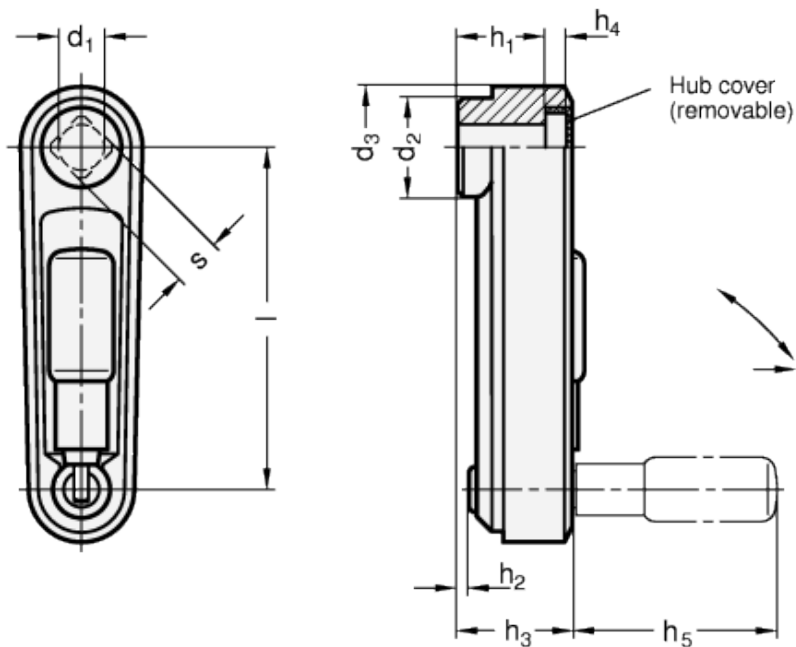

technical informations

Specification

Body

Aluminium

- plastic coated

black, RAL 9005, textured finish SW

silver, RAL 9006, textured finish SR

- hub machined

Hub cover

light grey

Retractable handles GN 798.3

- Plastic, Technopolymer

black, matt finish
 - Retractable mechanism
 Steel, blackened

Information

The handpiece of the cranked handle GN 472.3 is locked in a tapered bore in the operating position. For tilting, the handle must first be pulled out of the taper in axial direction. A compression spring holds the handle in both end positions. When folded out, it automatically re-engages.

Standard Elements	Main dimensions											Weight
Description	l	d _{1 H7}	s _{H11}	d ₂	d ₃	h ₁	h _{2 -}	h ₃	h ₄	h _{5 -}	Ø	g
GN 472.3-80-B10-SW	80	B10	-	23	29	20	3	26	4.3	43	16	145
GN 472.3-80-B10-SR	80	B10	-	23	29	20	3	26	4.3	43	16	145
GN 472.3-80-V10-SW	80	-	V10	23	29	20	3	26	4.3	57.5	16	142
GN 472.3-80-V10-SR	80	-	V10	23	29	20	3	26	4.3	57.5	16	142
GN 472.3-100-B12-SW	100	B12	-	26	34	24	4.5	30	4.2	76.5	18	213
GN 472.3-100-B12-SR	100	B12	-	26	34	24	4.5	30	4.2	76.5	18	213
GN 472.3-100-V12-SW	100	-	V12	26	34	24	4.5	30	4.2	43	18	210
GN 472.3-100-V12-SR	100	-	V12	26	34	24	4.5	30	4.2	43	18	210
GN 472.3-125-B14-SW	125	B14	-	28	36	31	9	37	4.2	57.5	24	305
GN 472.3-125-B14-SR	125	B14	-	28	36	31	9	37	4.2	57.5	24	305
GN 472.3-125-V14-SW	125	-	V14	28	36	31	9	37	4.2	76.5	24	301
GN 472.3-125-V14-SR	125	-	V14	28	36	31	9	37	4.2	76.5	24	301



ELESA and GANTER models all rights reserved in accordance with the law. Always mention the source when reproducing our drawings.

STANDARD MACHINE ELEMENTS WORLDWIDE