

GN 471.3

Crank handles with fold-away handle

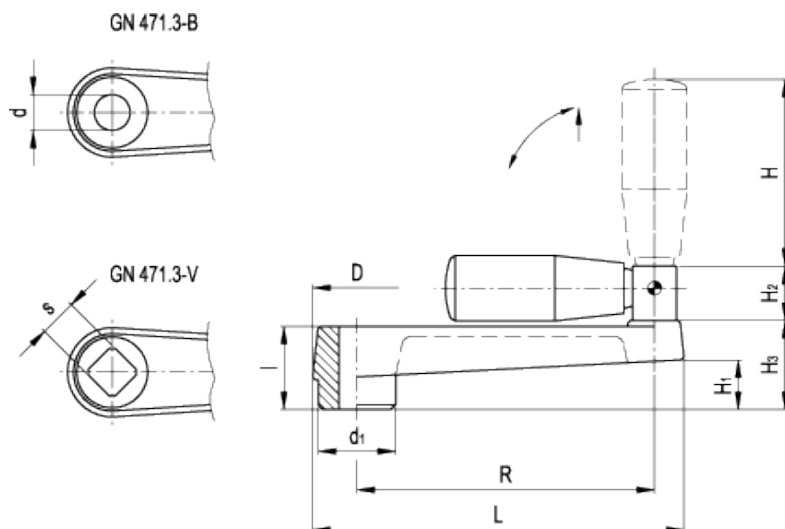

technical informations

Material

Aluminium, RAL 9005 black, matte epoxy resin coating with textured finish.

Assembly

- Version B: hub with H7 tolerance plain bore.
 - Version V: hub with H11 tolerance square bore in compliance with details for square [DIN 79](#).
- For fixing GN 471.3 on shafts by a grub screw see [Technical Data](#).

Fold-away handle

Type [GN 598.3](#) (type KU) black phenolic based (PF) Duroplast. Resistant to solvents, oils, greases and other chemical agents.

Standard Elements	Main dimensions							Mounting hole			Handle		Weight
Description	R	L	D	d ₁	H ₁	H ₂	H ₃	d _{H7}	s _{H11}	l	H	Ø	g
GN 471.3-100-B12	100	125	30	27	17	19.5	30	12	-	28	67.5	23	199
GN 471.3-100-V12	100	125	30	27	17	19.5	30	-	12x12	28	67.5	23	196
GN 471.3-125-B14	125	154	35	32	22	19.5	36	14	-	34	67.5	23	254
GN 471.3-125-V14	125	154	35	32	22	19.5	36	-	14x14	34	67.5	23	247
GN 471.3-160-B17	160	191	39	35	26	19.5	40	17	-	38	82.5	26	346
GN 471.3-160-V17	160	191	39	35	26	19.5	40	-	17x17	38	82.5	26	340



STANDARD MACHINE ELEMENTS WORLDWIDE