

# GN 426.6

Stainless Steel-Cabinet "U" handles

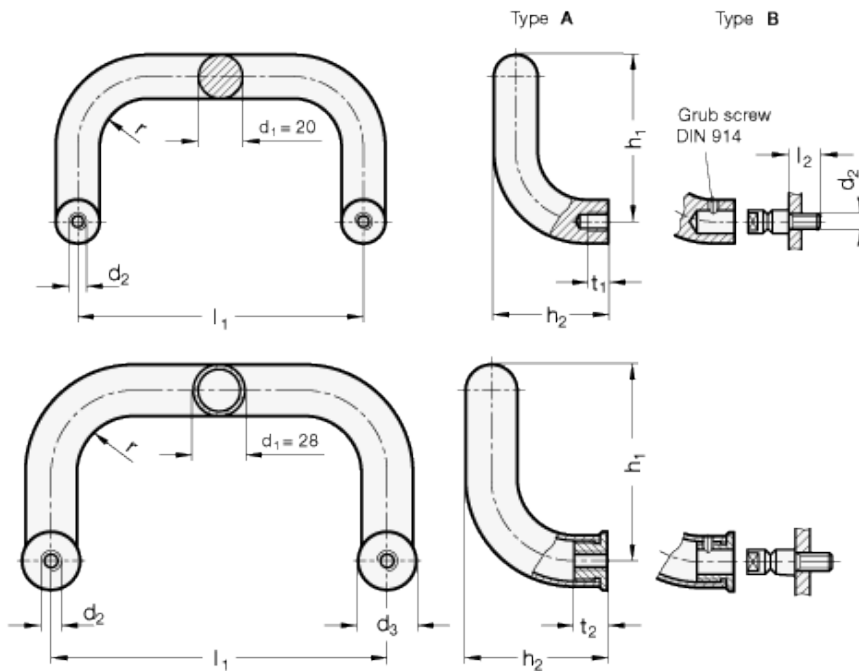

INOX  
Stainless Steel



## technical informations

### Specification

#### Types

- Type A: Mounting from the back (threaded blind bore)
- Type B: Mounting from the Operators side

#### Stainless Steel

- AISI 304
- matt shot-blasted

Threaded bush / Mounting stud  
Stainless Steel AISI 303

Grub screw DIN-914-M5-6-NI

## Information

Stainless Steel-Cabinet "U" handles GN 426.6 can be mounted from the back (type A) as well as from the operator's side (type B). In this case the stud is first screwed in from the machine side and then the handle is pushed on and secured with the grub screw.

Both mounting methods allow the mounting of a pair of handles in opposite position. This method could be used e.g. on doors (double handle). In general, a mounting stud with special length I2 might be required.

The manufacturing process (bending) allows the production of special lengths in relatively small quantities.

Standard Elements	Main dimensions											Weight
	Description	d <sub>1</sub>	l <sub>1 ±0.25</sub>	l <sub>1 ±0.3</sub>	d <sub>2</sub>	d <sub>3</sub>	h <sub>1</sub>	h <sub>2</sub>	l <sub>2</sub>	r	t <sub>1</sub>	
GN 426.6-20-200-A	20	200	-	M 8	-	105	68	-	22	15	-	-
GN 426.6-20-300-A	20	300	-	M 8	-	105	68	-	22	15	-	-
GN 426.6-28-250-A	28	250	-	M10	32	128	90	-	32	-	17	-
GN 426.6-28-350-A	28	350	-	M10	32	128	90	-	32	-	17	-
GN 426.6-28-500-A	28	500	-	M10	32	128	90	-	32	-	17	-
GN 426.6-20-200-B	20	-	200	M 8	-	105	68	20	22	15	-	-
GN 426.6-20-300-B	20	-	300	M 8	-	105	68	20	22	15	-	-
GN 426.6-28-250-B	28	-	250	M10	32	128	90	20	32	-	17	-
GN 426.6-28-350-B	28	-	350	M10	32	128	90	20	32	-	17	-
GN 426.6-28-500-B	28	-	500	M10	32	128	90	20	32	-	17	-



ELESA and GANTER models all rights reserved in accordance with the law. Always mention the source when reproducing our drawings.

STANDARD MACHINE ELEMENTS WORLDWIDE