

GN 355.1

Mounting tools

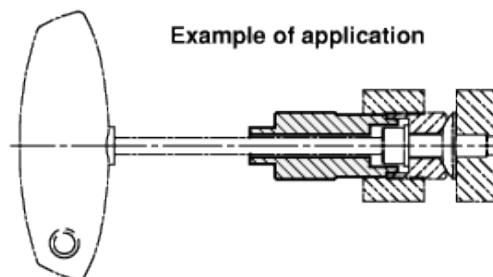
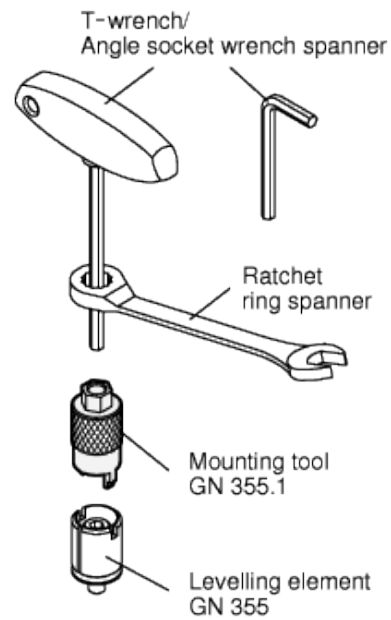
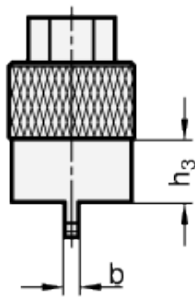
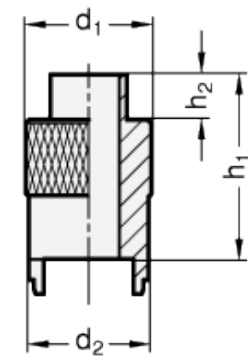

technical informations

Material

Blackened steel, surface hardened.

Features and applications

The assembly tools GN 355.1 serve to adjust the levelling elements GN 355. It is used in connection with a T-wrench or a hexagonal angle socket spanner. To ease levelling, the top end of the assembly tool has an external hexagon head which is used for turning the levelling screw with a ring spanner, ideally with a ratchet function. For adjustment, first use the assembly tool to turn the levelling screw of the levelling element into the desired position and at the same time tighten the screw to secure the levelling element. To ensure that the setting found does not change, the assembly tool may be used to counterhold.

Standard Elements	Main dimensions							max. permissible torque in Nm	Weight
	d ₁	b	d ₂	h ₁	h ₂	h ₃	A/F		
Description									
GN 355.1-12	12	2	11	35	7	6	8	20	22
GN 355.1-18	18	2	17	39	8	9	11	50	57
GN 355.1-24	24	4	22.5	43	9	11	13	75	68
GN 355.1-30	30	4	28.5	48	12	15	17	100	155
GN 355.1-36	36	4	34.5	53	13	18	22	150	255



STANDARD MACHINE ELEMENTS WORLDWIDE