

Tubular Handles

Tube Aluminum, Legs Zinc Die Casting

SPECIFICATION

Types

- Type **A**: Mounting from the back (threaded blind bore)
- Type **B**: Mounting from the operator's side (only for $d_1=28$)

Handle tube

Aluminum, wall thickness 1.5 mm

- Powder coated
Black RAL 9005, textured finish **SW**
Handle legs black
- Anodized, natural color **EL**
Handle legs black
- Anodized, natural color **ES**
Handle legs silver

Handle legs

Zinc die casting

Powder coated, textured finish

- Black, RAL 9005 for SW / EL
- Silver, RAL 9006 for ES

Cover

Plastic, light gray

Fastening set for type B

- Socket button head screws ISO 7380-M6-20
Steel, zinc plated
 - Black passivated for SW / EL
 - Blue passivated for ES
- Hex nuts ISO 4032-M6
Steel, zinc plated, blue passivated
- Washers DIN 125
Steel, zinc plated, blue passivated



INFORMATION

The handle tube of the GN 333.1 tubular handles can be screwed to the handle bases without further machining or processing, allowing **special lengths** to be realised easily.

Further handle legs can be added for very long tubular handles. Individual handle legs for tubular handles $\varnothing 28$ (type A) are available under GN 333.9 (see page 501).

For type B, socket button head screws, hex nuts and washers are included parts of the order.

ACCESSORY

- GN 333.9 Handle Legs (for Tubes $\varnothing 28$, Angled) (see page 501)

TECHNICAL INFORMATION

- Load Rating Information (see page A35)

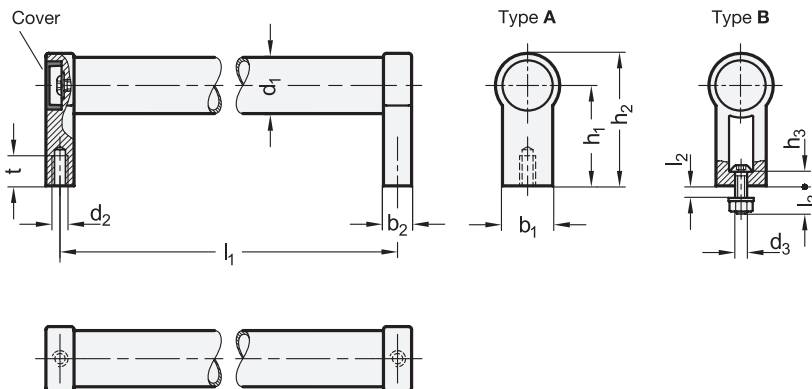

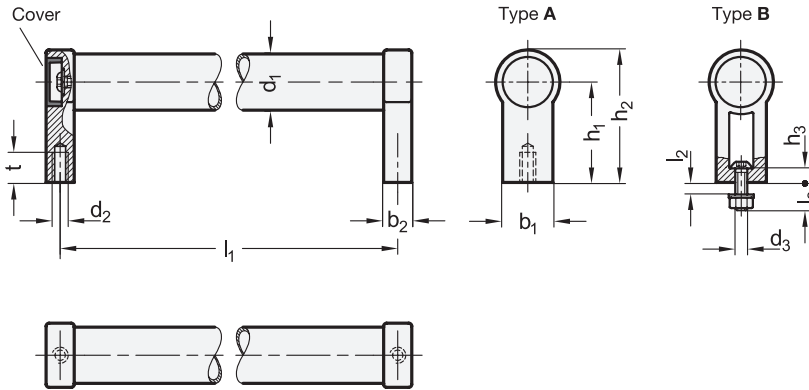

* Complete with

SW EL ES
 RAL9005 Anodized, natural color Anodized, natural color

GN 333.1-A

Description	d1	l1	d2	b1	b2	h1	h2	t min.	△
GN 333.1-20-180-A-*	20	180	M 6	24	12	42	54	12	190
GN 333.1-20-200-A-*	20	200	M 6	24	12	42	54	12	200
GN 333.1-20-250-A-*	20	250	M 6	24	12	42	54	12	208
GN 333.1-20-300-A-*	20	300	M 6	24	12	42	54	12	230
GN 333.1-20-350-A-*	20	350	M 6	24	12	42	54	12	245
GN 333.1-20-400-A-*	20	400	M 6	24	12	42	54	12	290
GN 333.1-28-200-A-*	28	200	M 8	25	14	50	66	15	340
GN 333.1-28-250-A-*	28	250	M 8	25	14	50	66	15	360
GN 333.1-28-300-A-*	28	300	M 8	25	14	50	66	15	390
GN 333.1-28-350-A-*	28	350	M 8	25	14	50	66	15	417
GN 333.1-28-400-A-*	28	400	M 8	25	14	50	66	15	440
GN 333.1-28-500-A-*	28	500	M 8	25	14	50	66	15	480
GN 333.1-28-600-A-*	28	600	M 8	25	14	50	66	15	500
GN 333.1-30-200-A-*	30	200	M 8	27	17	51	68	15	320
GN 333.1-30-300-A-*	30	300	M 8	27	17	51	68	15	374
GN 333.1-30-350-A-*	30	350	M 8	27	17	51	68	15	405
GN 333.1-30-400-A-*	30	400	M 8	27	17	51	68	15	440
GN 333.1-30-500-A-*	30	500	M 8	27	17	51	68	15	500
GN 333.1-30-600-A-*	30	600	M 8	27	17	51	68	15	570
GN 333.1-30-1000-A-*	30	1000	M 8	27	17	51	68	15	800

GN 333.1-B

Description	d1	l1	d3	b1	b2	h1	h2	h3	l2 max.	l3	△
GN 333.1-28-200-B-*	28	200	M 6	25	14	50	66	7	6	13	300
GN 333.1-28-250-B-*	28	250	M 6	25	14	50	66	7	6	13	320
GN 333.1-28-300-B-*	28	300	M 6	25	14	50	66	7	6	13	360
GN 333.1-28-350-B-*	28	350	M 6	25	14	50	66	7	6	13	380
GN 333.1-28-400-B-*	28	400	M 6	25	14	50	66	7	6	13	440
GN 333.1-28-500-B-*	28	500	M 6	25	14	50	66	7	6	13	470
GN 333.1-28-600-B-*	28	600	M 6	25	14	50	66	7	6	13	500

Weight SW

