

GN 321



Solid handwheels with revolving handle

- **Cast aluminium.**
- **Turned and mirror polished rim.** The other surfaces are matte finish fine sandblasted.
- **Hub** with:
 - B** = standard H7 tolerance plain bore
 - K** = standard H7 tolerance reamed bore with DIN 6885/1 P9 keyway (see table on page 669).
- **Axial retaining washer** (on request) type GN 184 (page 452).
- Axial and radial runout lower than IT 12.
- Black phenolic-based (PF) Duroplast **revolving handle.** Resistant to solvents, oils, greases and other chemical agents.

GN 321 solid handwheels are available with GN 000.4 or GN 000.5 safety coupling bushings already assembled (see page 87 GN 321.4 and see page 89 GN 321.5).

For fixing GN 321 on shafts by a grub screw see GN 110 drilling technical information on page 668.

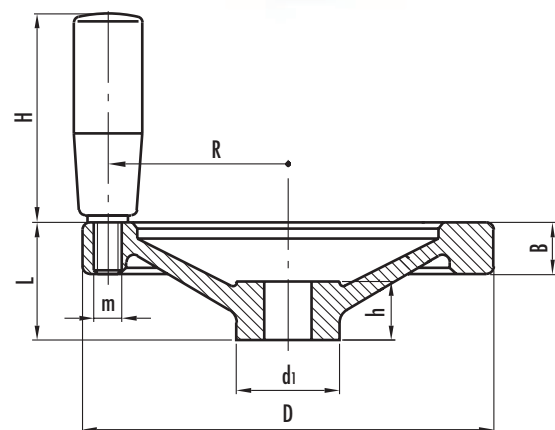

This product has been selected for its design by the international jury of "Die gute Industrieform-Hannover 1980"

design80



This product has been selected for its design by the international jury of "Design 1980-Stuttgart"

Standard elements	Main dimensions				Bore			Handle				Weight	
	Description	D	L	B	d ₁	d H7	h	keyway	H	Ø	m		R
GN 321-80-B10-D	80	26	13	26	10	16	•	42.5	18	M6	33.5	161	
GN 321-80-B12-D					12								154
GN 321-80-K10-D					10								159
GN 321-80-K12-D					12								152
GN 321-100-B10-D	100	30	14	28	10	17	•	52.5	21	M6	42.5	255	
GN 321-100-B12-D					12							253	
GN 321-100-K10-D					10							253	
GN 321-100-K12-D					12							251	
GN 321-125-B12-D	125	33	15	31	12	18	•	67.5	23	M8	54	394	
GN 321-125-B14-D					14							374	
GN 321-125-K12-D					12							392	
GN 321-125-K14-D					14							372	
GN 321-140-B14-D	140	36	16.5	36	14	19	•	67.5	23	M8	61	507	
GN 321-140-B16-D					16							503	
GN 321-140-K14-D					14							501	
GN 321-140-K16-D					16							505	
GN 321-160-B14-D	160	39	18	36	14	20	•	82.5	26	M10	71	675	
GN 321-160-B16-D					16							665	
GN 321-160-K14-D					14							671	
GN 321-160-K16-D					16							661	
GN 321-200-B18-D	200	45	20.5	45	18	24	•	82.5	26	M10	89	990	
GN 321-200-B20-D					20							988	
GN 321-200-K18-D					18							984	
GN 321-200-K20-D					20							963	
GN 321-250-B22-D	250	51	23	48	22	28	•	92.5	28	M10	113	1626	
GN 321-250-B26-D					26							1583	
GN 321-250-K22-D					22							1621	