

# GN 321.6-A

Safety solid handwheels

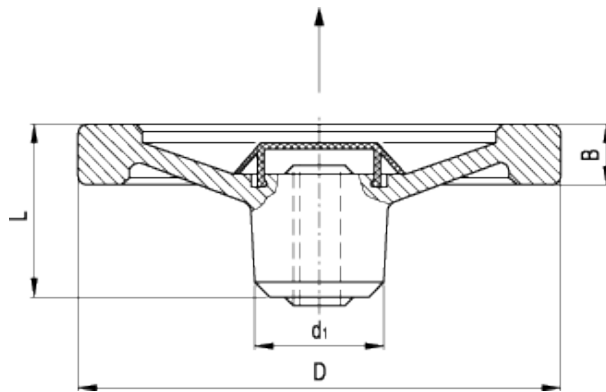

## technical informations

### Material

Aluminium, black epoxy resin coating.

### Rim

Aluminium, mirror-polished.

### Hub cap

Light grey acetal resin based (POM) technopolymer.

### Assembly

Hub with keyway in compliance with [DIN 6885/2 P9 tolerance](#).

### Technical data

Axial and radial runout lower than 0.4.

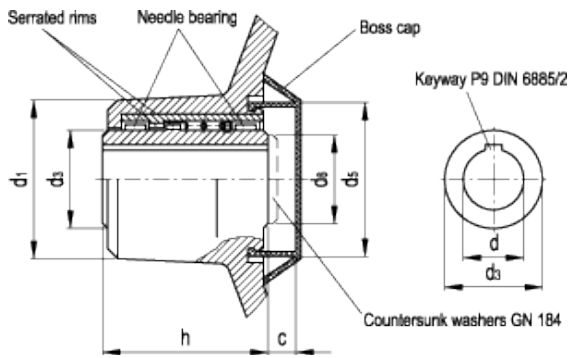

Standard Elements	Main dimensions									Mounting hole	Weight
Description	D	L	B	d <sub>1</sub>	d <sub>3</sub>	d <sub>5</sub>	d <sub>6 max.</sub>	h	c	d <sub>H7</sub>	g
GN 321.6-140-K12-A	140	58	16.5	42	24	40	23	45	7	12	535
GN 321.6-140-K14-A	140	58	16.5	42	24	40	23	45	7	14	520
GN 321.6-140-K16-A	140	58	16.5	42	24	40	23	45	7	16	504
GN 321.6-160-K12-A	160	58	18	42	24	40	23	45	7	12	659
GN 321.6-160-K14-A	160	58	18	42	24	40	23	45	7	14	644
GN 321.6-160-K16-A	160	58	18	42	24	40	23	45	7	16	628



STANDARD MACHINE ELEMENTS WORLDWIDE