

GN 298

T-shaped and angular connectors

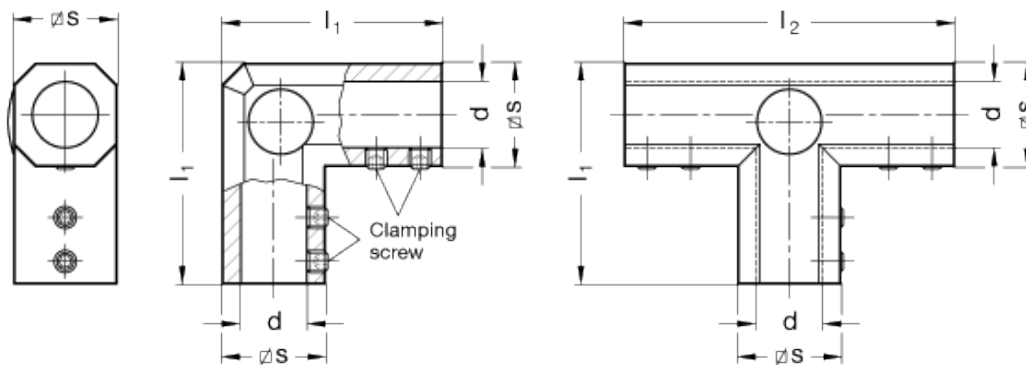

technical informations

Material

Aluminium gravity die-cast.

Clamping screw

Stainless Steel.

Finish

RAL 9005 black, matte finish, epoxy resin coating.

Types

- Type W for angular gears.
- Type T for T-gears.

Features and applications

Housings GN 298 for angular gears / T-gears are used in connection with bevel-gear wheels GN 297 and linear actuators / transfer units: the angular gears / T-gears are designed to deflect the rotary movement of a linear actuator / transfer unit by 90°.

Accessories

- Bevel gear wheels GN 297
- Drive units GN 391
- Transfer units GN 391
- Linear actuators GN 291
- Linear actuators GN 292
- Linear actuators GN 293

Standard Elements	Main dimensions				Weight
Description	s	d	l ₁	l ₂	g
GN 298-28-B18-W-SW	28	B 18	60	90	107
GN 298-40-B30-W-SW	40	B 30	84	126	219
GN 298-50-B40-W-SW	50	B 40	108	162	434
GN 298-60-B50-W-SW	60	B 50	128	190	692
GN 298-28-B18-T-SW	28	B 18	60	90	139
GN 298-40-B30-T-SW	40	B 30	84	126	280
GN 298-50-B40-T-SW	50	B 40	108	162	542
GN 298-60-B50-T-SW	60	B 50	128	190	851



STANDARD MACHINE ELEMENTS WORLDWIDE