

Cam latches

Sintered Steel

SPECIFICATION

Types

- Type **L**: clamping direction left turn
- Type **R**: clamping direction right turn

Sintered Steel **SM**

black, steam oxidized

TECHNICAL INFORMATION

- ISO-Fundamental Tolerances (see page A21)

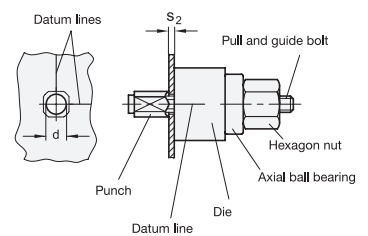
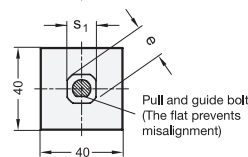
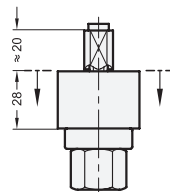
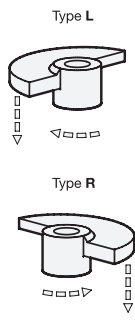
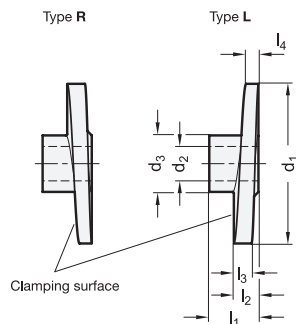

Sheet metal punches

for mounting latches

SPECIFICATION

Steel

Punch and die
hardened (56 - 58 HRC)

INFORMATION

These sheet metal punches GN 123 allow the operator to punch in a simple way fixing holes in sheet metal doors for latches with square V14 and V20.

Sheet metal punches GN 123 are ideally suited for punching holes into sheet metal up to 2 mm thickness.

ASSEMBLY INSTRUCTION

Set predrill hole d. We recommend using an adhesive tape with the centre of the punch hole and the datum lines showing.

Insert pull bolt with punch.

Attach the die, align along the datum lines and fix in place with the hexagon nut / set punch hole.

ON REQUEST

- Sheet metal punches GN 123.5 for Stainless Steel sheet.



GN 218

Description	d1	d2 H8	d3	l1 ≈	l2	l3	l4	Δ
GN 218-SM-35-B8-L	35	B 8	18	15	7	7	3	34
GN 218-SM-35-B10-L	35	B 10	18	15	7	7	3	31
GN 218-SM-65-B12-L	65	B 12	23	20	10	7	5	100
GN 218-SM-80-B16-L	80	B 16	27	24	12	9	6	160
GN 218-SM-35-B8-R	35	B 8	18	15	7	7	3	34
GN 218-SM-35-B10-R	35	B 10	18	15	7	7	3	31
GN 218-SM-65-B12-R	65	B 12	23	20	10	7	5	103
GN 218-SM-80-B16-R	80	B 16	27	24	12	9	6	160

GN 123

Description	s1 +0.1	e Ø +0.5	d	s2	Δ
GN 123-V14.1	V 14.1	16.3	11	2	475
GN 123-V20.1	V 20.1	22.5	15	2	505

