

# GN 212.5

Adjustable handles

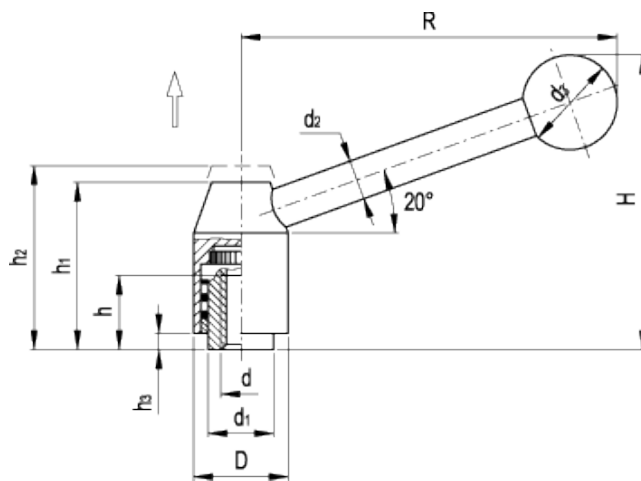

INOX  
Stainless Steel



## technical informations

### Lever body

Matte shot-blasted AISI 303 stainless steel.

### Handle

Matte shot-blasted AISI 303 stainless steel arm inclined by a 20° angle (execution E) with [DIN 319](#) black phenolic based (PF) Duroplast ball knob.

### Clamping element

AISI 303 stainless steel with threaded hole and toothed element for coupling to the lever body, stainless steel return spring.

### Features and applications

GN 212.5 adjustable handles are used for applications having a limited space or where a particular handle position is required. Stainless steel, thanks to its high resistance to corrosion, allows the application of these adjustable handles on machines and equipment in those sectors where laws or particular hygienic, climatic and environmental factors make it mandatory to use corrosion resistant materials.

### Instructions of use

The threaded bushing is connected to the handle via serrations and can be easily disengaged. By pulling the handle, the internal mechanism disengages the serrations and allows the handle to swivel to the ideal clamping position. By releasing the handle, the mechanism automatically re-engages serrations.

Standard Elements	Main dimensions									Mounting hole		Weight
Description	D	R	H~	h <sub>1</sub>	h <sub>2</sub>	h <sub>3</sub>	d <sub>1</sub>	d <sub>2</sub>	d <sub>3</sub>	d	h	g
GN 212.5-21-M6-E	21	75	59	33.5	37.5	1	13.5	8	20	M6	11	97
GN 212.5-21-M8-E	21	75	59	33.5	37.5	1	13.5	8	20	M8	11	95
GN 212.5-24-M8-E	24	101	75	40	44.5	2.5	16	10	25	M8	14	159
GN 212.5-24-M10-E	24	101	75	40	44.5	2.5	16	10	25	M10	14	155
GN 212.5-28-M10-E	28	116	88	48.5	53	4.5	19	12	30	M10	17	261
GN 212.5-28-M12-E	28	116	88	48.5	53	4.5	19	12	30	M12	17	259



STANDARD MACHINE ELEMENTS WORLDWIDE