

Base Plate Connector Clamps

Aluminum, Split Assembly

SPECIFICATION

Identification No.

No. **2**: With 2 stainless steel socket cap screws DIN 912

Aluminum

- Powder coated
Black, RAL 9005, textured finish **SW**
- Plain, matte shot-blasted **BL**

Socket cap screws DIN 912

Stainless Steel AISI 304

Hex nuts DIN 985

Stainless Steel AISI 304

Self-locking via polyamide ring



INFORMATION

The clamping bore of base plate connector clamps GN 165 is not machined and designed for construction tubes GN 990 (see page 1902) or DIN 2391, DIN 2395 and DIN 2462.

The versions with square bores are also suitable for use with **profile systems**.

At the screw locations **z**, the socket cap screws reduce the bore cross-section for clamping.

For clamping without tools, the socket cap screws can be replaced by the adjustable hand levers GN 911 (see page 1874) listed in the table as accessories.

ACCESSORY

- Adjustable Hand Levers GN 911 (see page 1874)

TECHNICAL INFORMATION

- Stainless Steel Characteristics (see page A26)

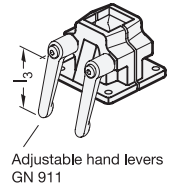
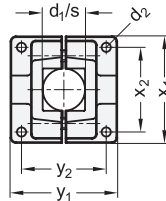
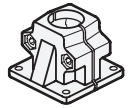
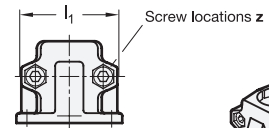
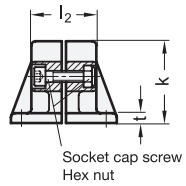

* Complete with

SW **BL**
RAL9005 Plain

GN 165-B

Description	d1	d2	k Clamping length	l1	l2	t	x1	x2	y1	y2	z Screw locations	Accessory Recom. hand lever GN 911 for z l3	⚖
GN 165-B20-2-*	B 20	7	58	69	46	7	75	60	75	60	M8-35	63 78	300
GN 165-B25-2-*	B 25	7	58	69	46	7	75	60	75	60	M8-35	63 78	296
GN 165-B30-2-*	B 30	7	58	69	46	7	75	60	75	60	M8-35	63 78	282
GN 165-B40-2-*	B 40	11	91	98	70	14	115	90	119	90	M10-60	78 92	945
GN 165-B42-2-*	B 42	11	91	98	70	14	115	90	119	90	M10-60	78 92	905
GN 165-B45-2-*	B 45	11	91	98	70	14	115	90	119	90	M10-60	78 92	878
GN 165-B48-2-*	B 48	11	91	98	70	14	115	90	119	90	M10-60	78 92	840
GN 165-B50-2-*	B 50	11	91	98	70	14	115	90	119	90	M10-60	78 92	810

GN 165-S

Description	d1	d2	k Clamping length	l1	l2	t	x1	x2	y1	y2	z Screw locations	Accessory Recom. hand lever GN 911 for z l3	⚖
GN 165-V20-2-*	V 20	7	58	69	46	7	75	60	75	60	M8-35	63 78	300
GN 165-V25-2-*	V 25	7	58	69	46	7	75	60	75	60	M8-35	63 78	286
GN 165-V30-2-*	V 30	7	58	69	46	7	75	60	75	60	M8-35	63 78	270
GN 165-V40-2-*	V 40	11	91	98	70	14	115	90	119	90	M10-60	78 92	920
GN 165-V45-2-*	V 45	11	91	98	70	14	115	90	119	90	M10-60	78 92	886
GN 165-V50-2-*	V 50	11	91	98	70	14	115	90	119	90	M10-60	78 92	880

Weight SW