

Retaining Cables

Stainless Steel, with Key Rings or One Key Ring and One Mounting Tab / with Mounting Tabs or Loops

SPECIFICATION

Types

- Type **A**: With 2 key rings
- Type **B**: With mounting tab and key ring
- Type **C**: With 2 mounting tabs
- Type **D**: With 2 loops
- Type **E**: With mounting tab and loop

Retaining cable

Stainless steel AISI 304

Plain **BL**

Plastic coated (PVC)

Transparent **TR**

Black **SW**

Mounting tab

Stainless steel AISI 304

Plain (for BL / TR)

Zinc plated, black passivated (for SW)

Key ring

Stainless steel AISI 301

Plain, ground (for BL / TR)

Zinc plated, black passivated (for SW)

Press sleeves

Aluminum

Plain (for BL / TR)

Black anodized (for SW)

Type A and type B are ideal suitable for ball lock pins and locking pins with axial lock.

* - GN 113.11, GN 113.12 for pins $\varnothing 5$, $\varnothing 6$

- GN 113.1, GN 113.3, GN 113.4, GN 113.7, GN 113.8, GN 113.9,

GN 113.10, GN 214.2, GN 214.3, GN 214.6 for pins $\varnothing 5$, $\varnothing 6$, $\varnothing 8$

- GN 113.5, GN 113.6, GN 114.2, GN 114.3, GN 114.6, GN 124.1, GN 124.2 for all pins

** - GN 113.11, GN 113.12, GN 314 for pins $\varnothing 8$, $\varnothing 10$, $\varnothing 12$

- GN 113.1, GN 113.3, GN 113.4, GN 113.7, GN 113.8, GN 113.9, GN 113.10, GN 214.2, GN 214.3, GN 214.6 for pins $\varnothing 10$, $\varnothing 12$, $\varnothing 16$, $\varnothing 20$, $\varnothing 25$

*** - GN 113.11, GN 113.12, GN 314 for pins $\varnothing 16$, $\varnothing 20$, $\varnothing 25$



INFORMATION

Retaining cables GN 111.2 are available in 5 different types and can therefore be used in a wide range of applications, e.g. for loss protection or as connecting and mounting cables.

The coating of versions TR and SW protects adjacent parts from chafing or other damage. The smooth surface is also pleasant to the touch. The black design is visually discreet and is also used in situations where the reflections on the surface are to be minimized.

On delivery the key rings are already mounted on the retaining cable. With type A, both rings have the same diameter d_1 .

For all types the loops are reversed laterally and attached parallel to each other, which is not entirely considered in the simplified drawing.

The load values given in the table are non-binding guide values and rule out any liability.

ACCESSORY

- Key Rings GN 111.3 (see page 903)

TECHNICAL INFORMATION

- Stainless Steel Characteristics (see page A26)

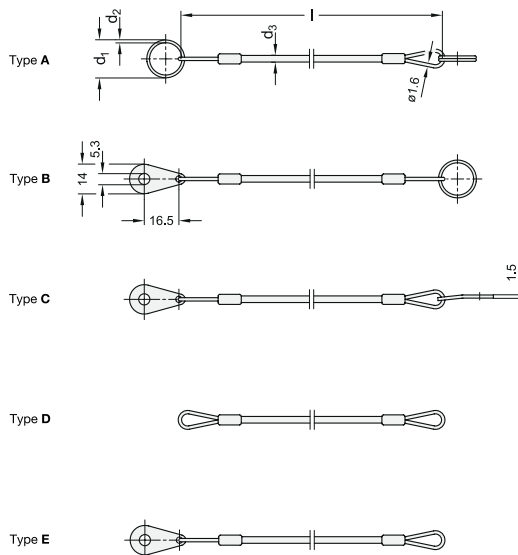

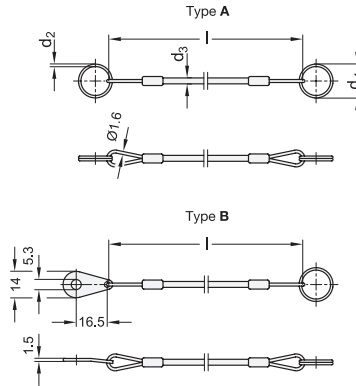

GN 111.2-A

STAINLESS STEEL

GN 111.2-B

STAINLESS STEEL

Description	l	d1	d2	d3	Static load	⚖️
GN 111.2-150-14-A-BL	150	14*	1	1.6	50	31
GN 111.2-150-14-A-TR	150	14*	1	3	50	6
GN 111.2-150-14-A-SW	150	14*	1	3	50	6
GN 111.2-150-18-A-BL	150	18**	1.3	1.6	90	32
GN 111.2-150-18-A-TR	150	18**	1.3	3	90	7
GN 111.2-150-18-A-SW	150	18**	1.3	3	90	7
GN 111.2-150-24-A-BL	150	24***	1.5	1.6	100	34
GN 111.2-150-24-A-TR	150	24***	1.5	3	100	8
GN 111.2-150-24-A-SW	150	24***	1.5	3	100	8
GN 111.2-150-30-A-BL	150	30	1.8	1.6	120	37
GN 111.2-150-30-A-TR	150	30	1.8	3	120	12
GN 111.2-150-30-A-SW	150	30	1.8	3	120	12
GN 111.2-200-14-A-BL	200	14*	1	1.6	50	12
GN 111.2-200-14-A-TR	200	14*	1	3	50	7
GN 111.2-200-14-A-SW	200	14*	1	3	50	7
GN 111.2-200-18-A-BL	200	18**	1.3	1.6	90	12
GN 111.2-200-18-A-TR	200	18**	1.3	3	90	8
GN 111.2-200-18-A-SW	200	18**	1.3	3	90	8
GN 111.2-200-24-A-BL	200	24***	1.5	1.6	100	13
GN 111.2-200-24-A-TR	200	24***	1.5	3	100	8
GN 111.2-200-24-A-SW	200	24***	1.5	3	100	8
GN 111.2-200-30-A-BL	200	30	1.8	1.6	120	15
GN 111.2-200-30-A-TR	200	30	1.8	3	120	11
GN 111.2-200-30-A-SW	200	30	1.8	3	120	11
GN 111.2-320-14-A-BL	320	14*	1	1.6	50	15
GN 111.2-320-14-A-TR	320	14*	1	3	50	8
GN 111.2-320-14-A-SW	320	14*	1	3	50	8
GN 111.2-320-18-A-BL	320	18**	1.3	1.6	90	15
GN 111.2-320-18-A-TR	320	18**	1.3	3	90	9
GN 111.2-320-18-A-SW	320	18**	1.3	3	90	9
GN 111.2-320-24-A-BL	320	24***	1.5	1.6	100	16
GN 111.2-320-24-A-TR	320	24***	1.5	3	100	11
GN 111.2-320-24-A-SW	320	24***	1.5	3	100	11
GN 111.2-320-30-A-BL	320	30	1.8	1.6	120	18
GN 111.2-320-30-A-TR	320	30	1.8	3	120	14
GN 111.2-320-30-A-SW	320	30	1.8	3	120	14
GN 111.2-500-14-A-BL	500	14*	1	1.6	50	22
GN 111.2-500-14-A-TR	500	14*	1	3	50	13
GN 111.2-500-14-A-SW	500	14*	1	3	50	13
GN 111.2-500-18-A-BL	500	18**	1.3	1.6	90	23
GN 111.2-500-18-A-TR	500	18**	1.3	3	90	12
GN 111.2-500-18-A-SW	500	18**	1.3	3	90	12
GN 111.2-500-24-A-BL	500	24***	1.5	1.6	100	24
GN 111.2-500-24-A-TR	500	24***	1.5	3	100	15
GN 111.2-500-24-A-SW	500	24***	1.5	3	100	15
GN 111.2-500-30-A-BL	500	30	1.8	1.6	120	25
GN 111.2-500-30-A-TR	500	30	1.8	3	120	17
GN 111.2-500-30-A-SW	500	30	1.8	3	120	17

Description	l	d1	d2	d3	Static load	⚖️
GN 111.2-150-14-B-BL	150	14*	1	1.6	50	33
GN 111.2-150-14-B-TR	150	14*	1	3	50	7
GN 111.2-150-14-B-SW	150	14*	1	3	50	7
GN 111.2-150-18-B-BL	150	18**	1.3	1.6	90	34
GN 111.2-150-18-B-TR	150	18**	1.3	3	90	7
GN 111.2-150-18-B-SW	150	18**	1.3	3	90	7
GN 111.2-150-24-B-BL	150	24***	1.5	1.6	100	35
GN 111.2-150-24-B-TR	150	24***	1.5	3	100	9
GN 111.2-150-24-B-SW	150	24***	1.5	3	100	9
GN 111.2-150-30-B-BL	150	30	1.8	1.6	120	36
GN 111.2-150-30-B-TR	150	30	1.8	3	120	10
GN 111.2-150-30-B-SW	150	30	1.8	3	120	10
GN 111.2-200-14-B-BL	200	14*	1	1.6	50	14
GN 111.2-200-14-B-TR	200	14*	1	3	50	7
GN 111.2-200-14-B-SW	200	14*	1	3	50	7
GN 111.2-200-18-B-BL	200	18**	1.3	1.6	90	17
GN 111.2-200-18-B-TR	200	18**	1.3	3	90	10
GN 111.2-200-18-B-SW	200	18**	1.3	3	90	10
GN 111.2-200-24-B-BL	200	24***	1.5	1.6	100	24
GN 111.2-200-24-B-TR	200	24***	1.5	3	100	10
GN 111.2-200-24-B-SW	200	24***	1.5	3	100	10
GN 111.2-200-30-B-BL	200	30	1.8	1.6	120	35
GN 111.2-200-30-B-TR	200	30	1.8	3	120	11
GN 111.2-200-30-B-SW	200	30	1.8	3	120	11
GN 111.2-320-14-B-BL	320	14*	1	1.6	50	8
GN 111.2-320-14-B-TR	320	14*	1	3	50	10
GN 111.2-320-14-B-SW	320	14*	1	3	50	10
GN 111.2-320-18-B-BL	320	18**	1.3	1.6	90	12
GN 111.2-320-18-B-TR	320	18**	1.3	3	90	10
GN 111.2-320-18-B-SW	320	18**	1.3	3	90	10
GN 111.2-320-24-B-BL	320	24***	1.5	1.6	100	19
GN 111.2-320-24-B-TR	320	24***	1.5	3	100	8
GN 111.2-320-24-B-SW	320	24***	1.5	3	100	8
GN 111.2-320-30-B-BL	320	30	1.8	1.6	120	30
GN 111.2-320-30-B-TR	320	30	1.8	3	120	13
GN 111.2-320-30-B-SW	320	30	1.8	3	120	13
GN 111.2-500-14-B-BL	500	14*	1	1.6	50	11
GN 111.2-500-14-B-TR	500	14*	1	3	50	13
GN 111.2-500-14-B-SW	500	14*	1	3	50	13
GN 111.2-500-18-B-BL	500	18**	1.3	1.6	90	14
GN 111.2-500-18-B-TR	500	18**	1.3	3	90	15
GN 111.2-500-18-B-SW	500	18**	1.3	3	90	15
GN 111.2-500-24-B-BL	500	24***	1.5	1.6	100	22
GN 111.2-500-24-B-TR	500	24***	1.5	3	100	15
GN 111.2-500-24-B-SW	500	24***	1.5	3	100	15
GN 111.2-500-30-B-BL	500	30	1.8	1.6	120	33
GN 111.2-500-30-B-TR	500	30	1.8	3	120	17
GN 111.2-500-30-B-SW	500	30	11.88	3	120	17



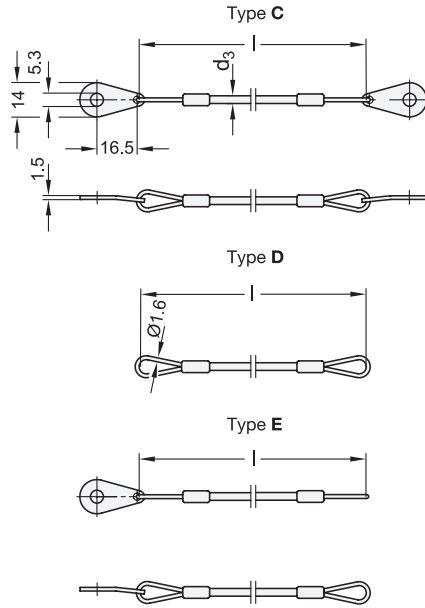

GN 111.2-C STAINLESS STEEL

Description	l	d ₃	Static load	⚖️
GN 111.2-150-C-BL	150	1.6	1800	20
GN 111.2-150-C-TR	150	3	1800	9
GN 111.2-150-C-SW	150	3	1800	9
GN 111.2-200-C-BL	200	1.6	1800	21
GN 111.2-200-C-TR	200	3	1800	11
GN 111.2-200-C-SW	200	3	1800	11
GN 111.2-320-C-BL	320	1.6	1800	23
GN 111.2-320-C-TR	320	3	1800	12
GN 111.2-320-C-SW	320	3	1800	12
GN 111.2-500-C-BL	500	1.6	1800	26
GN 111.2-500-C-TR	500	3	1800	15
GN 111.2-500-C-SW	500	3	1800	15

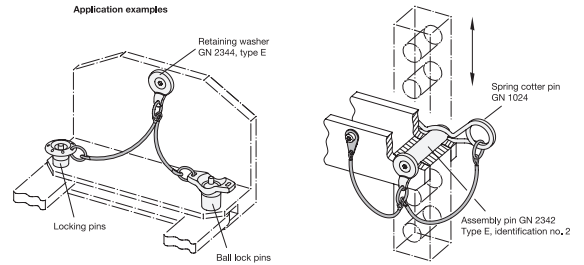

GN 111.2-D STAINLESS STEEL

Description	l	d ₃	Static load	⚖️
GN 111.2-150-D-BL	150	1.6	1800	13
GN 111.2-150-D-TR	150	3	1800	4
GN 111.2-150-D-SW	150	3	1800	4
GN 111.2-200-D-BL	200	1.6	1800	14
GN 111.2-200-D-TR	200	3	1800	5
GN 111.2-200-D-SW	200	3	1800	5
GN 111.2-320-D-BL	320	1.6	1800	15
GN 111.2-320-D-TR	320	3	1800	7
GN 111.2-320-D-SW	320	3	1800	7
GN 111.2-500-D-BL	500	1.6	1800	18
GN 111.2-500-D-TR	500	3	1800	10
GN 111.2-500-D-SW	500	3	1800	10

GN 111.2-E STAINLESS STEEL

Description	l	d ₃	Static load	⚖️
GN 111.2-150-E-BL	150	1.6	1800	9
GN 111.2-150-E-TR	150	3	1800	7
GN 111.2-150-E-SW	150	3	1800	7
GN 111.2-200-E-BL	200	1.6	1800	11
GN 111.2-200-E-TR	200	3	1800	7
GN 111.2-200-E-SW	200	3	1800	7
GN 111.2-320-E-BL	320	1.6	1800	12
GN 111.2-320-E-TR	320	3	1800	10
GN 111.2-320-E-SW	320	3	1800	10
GN 111.2-500-E-BL	500	1.6	1800	15
GN 111.2-500-E-TR	500	3	1800	13
GN 111.2-500-E-SW	500	3	1800	13

Machine Elements