

## Control handles

Zinc die casting

### SPECIFICATION

Body  
Zinc die casting  
plastic coated  
black, textured finish

Cylindrical Revolving handles GN 598 (see page 573)  
- Plastic, technopolymer, black matt  
- Spindle steel, zinc plated, blue passivated

### INFORMATION

Control handles GN 112.1 allow fine adjustment.  
They are connected to a shaft by means of a cross pin. To simplify the installation there is a centred drilling on both sides.

### TECHNICAL INFORMATION

- ISO-Fundamental Tolerances (see page A21)

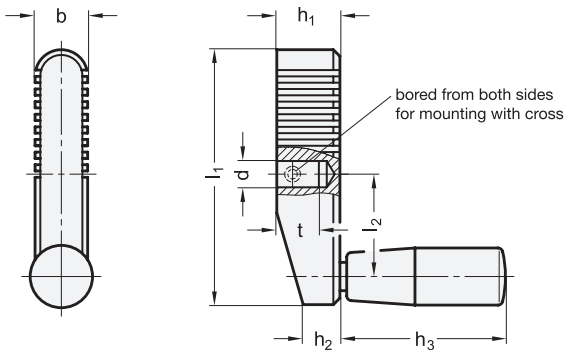

### GN 112.1

Description	l1	d	H7	b	h1	h2	h3 ≈	l2	t min.	Ø Handle	⚖
GN 112.1-70-S8	70	S 8	17	19	11.5	42.5	26.5	12	18	18	125
GN 112.1-80-S8	80	S 8	18	21	12.5	52.5	31	12	21	21	170
GN 112.1-90-S10	90	S 10	19	23	13.5	52.5	35.5	15	21	21	251
GN 112.1-100-S10	100	S 10	20	25	14	67.5	40	17	23	23	320
GN 112.1-100-S12	100	S 12	20	25	14	67.5	40	17	23	23	295

## Tri-ball handles

Steel

### SPECIFICATION

**Type**  
- Type **F**: with fixed handle  
Steel

- turned  
- zinc plated, blue passivated  
Fixed handles DIN 39 (see page 565)  
Steel zinc plated, blue passivated

### INFORMATION

Tri-ball handles GN 10 allow fine adjustment.  
An alternative in modern design are control handles GN 112.1 (see page 203)

### TECHNICAL INFORMATION

- ISO-Fundamental Tolerances (see page A21)

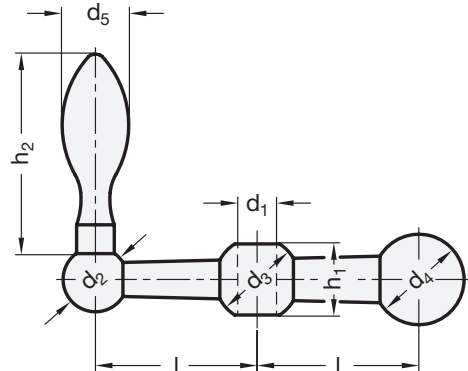

### GN 10

Description	No.	d1 H7	d2	d3	d4	d5	h1	h2 ≈	l	⚖
GN 10-100-B7-F	100	B 7	13	16	18	10	13	31	25	60
GN 10-101-B8-F	101	B 8	15	19	20	13	17	40	28	102
GN 10-102-B8-F	102	B 8	16	20	22	14	17	45	34	136
GN 10-103-B10-F	103	B 10	18	23	25	16	19.5	50	41	194
GN 10-104-B12-F	104	B 12	20	26	28	18	21.5	56	50	283

