

Rubber buffers

Rubber and steel or stainless steel

STANDARD EXECUTIONS

Plain pass-through hole.

- **DVL.2**: base plates in polished zinc-plated steel, vibration-damper body in natural rubber NR, black colour, hardness 40, 55, 70 Shore A ± 5 .
- **DVL.2-SST**: base plates in INOX AISI 304 stainless steel, vibration-damper body in natural rubber NR, black colour, hardness 55 Shore A ± 5 .

FEATURES AND APPLICATIONS

The rubber buffers have been designed to damp vibrations, shocks and noises produced by moving bodies or non-balanced vibrating masses of equipment and machines. Vibrations can cause:

- malfunctioning and reduction of the machine lifespan and/or of the adjacent ones;
- damage to health;
- noise.

Load diagrams for each single code are available on request. See Technical data and guidelines for the choice.



SPECIAL EXECUTIONS ON REQUEST

- Natural rubber NR, hardness 40, 70 tolerance ± 5 Shore A for executions with AISI 304 stainless steel base.
- Nitrile rubber NBR: for applications where high resistance to oil, fuels and other chemical substances is required.
- EPDM Rubber: for applications where high resistance to high temperature, ozone, and atmospheric agents is required. It also has excellent electrical insulation properties.
- EPDM 55 rubber: electrical insulation.

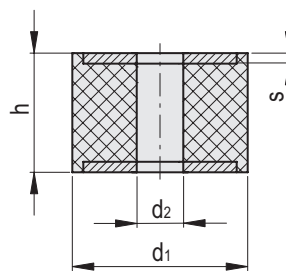

DVL.2

Code	Description	d1	d2	h	s	Max. load [N]	Max. deflection [mm]	Stiffness [N/mm]	
436401	DVL.2-15-25-6-40	15	6	25	2	120	6.25	19.2	11
436402	DVL.2-15-25-6-55	15	6	25	2	194	6.25	31	11
436403	DVL.2-15-25-6-70	15	6	25	2	400	6.25	64	11
436406	DVL.2-20-25-6-40	20	6	25	2	235	6.25	37	14
436407	DVL.2-20-25-6-55	20	6	25	2	360	6.25	57	14
436408	DVL.2-20-25-6-70	20	6	25	2	645	6.25	103	14
436411	DVL.2-25-20-6-6-40	25	6.6	20	2	417	5	83	19
436412	DVL.2-25-20-6-6-55	25	6.6	20	2	710	5	142	19
436413	DVL.2-25-20-6-6-70	25	6.6	20	2	1400	5	280	19
436416	DVL.2-30-15-16-40	30	16	15	2	530	3.75	141	23
436417	DVL.2-30-15-16-55	30	16	15	2	825	3.75	220	23
436418	DVL.2-30-15-16-70	30	16	15	2	2600	3.75	693	23
436421	DVL.2-35-15-19-40	35	19	15	2	990	3.75	264	28
436422	DVL.2-35-15-19-55	35	19	15	2	1806	3.75	481	28
436423	DVL.2-35-15-19-70	35	19	15	2	2840	3.75	757	28
436426	DVL.2-35-20-13-40	35	13	20	2	902	5	180	36
436427	DVL.2-35-20-13-55	35	13	20	2	1491	5	298	36
436428	DVL.2-35-20-13-70	35	13	20	2	3010	5	602	36

DVL.2

Code	Description	d1	d2	h	s	Max. load [N]	Max. deflection [mm]	Stiffness [N/mm]	⚖️
436431	DVL.2-40-20-13-40	40	13	20	2	1326	5	265	45
436432	DVL.2-40-20-13-55	40	13	20	2	1995	5	399	45
436433	DVL.2-40-20-13-70	40	13	20	2	4580	5	916	45
436436	DVL.2-40-28-13-40	40	13	28	2	980	7	140	54
436437	DVL.2-40-28-13-55	40	13	28	2	1620	7	231	54
436438	DVL.2-40-28-13-70	40	13	28	2	2690	7	384	54
436441	DVL.2-40-30-13-40	40	13	30	2	878	7.5	117	58
436442	DVL.2-40-30-13-55	40	13	30	2	1500	7.5	200	58
436443	DVL.2-40-30-13-70	40	13	30	2	3310	7.5	441	58
436446	DVL.2-40-35-13-40	40	13	35	2	915	8.75	105	65
436447	DVL.2-40-35-13-55	40	13	35	2	1495	8.75	171	65
436448	DVL.2-40-35-13-70	40	13	35	2	2670	8.75	305	65
436451	DVL.2-40-40-13-40	40	13	40	2	911	10	91	71
436452	DVL.2-40-40-13-55	40	13	40	2	1340	10	134	71
436453	DVL.2-40-40-13-70	40	13	40	2	3120	10	312	71
436456	DVL.2-50-15-21-40	50	21	15	2	2360	3.75	629	59
436457	DVL.2-50-15-21-55	50	21	15	2	3940	3.75	1051	59
436458	DVL.2-50-15-21-70	50	21	15	2	9270	3.75	2472	59
436461	DVL.2-50-20-17-40	50	17	20	2	2470	5	494	74
436462	DVL.2-50-20-17-55	50	17	20	2	3790	5	758	74
436463	DVL.2-50-20-17-70	50	17	20	2	8540	5	1708	74
436466	DVL.2-50-20-21-40	50	21	20	2	2074	5	415	69
436467	DVL.2-50-20-21-55	50	21	20	2	3270	5	654	69
436468	DVL.2-50-20-21-70	50	21	20	2	5160	5	1032	69
436471	DVL.2-50-25-11-40	50	11	25	2	2130	6.25	341	91
436472	DVL.2-50-25-11-55	50	11	25	2	3620	6.25	579	91
436473	DVL.2-50-25-11-70	50	11	25	2	5660	6.25	906	91
436476	DVL.2-50-30-10-40	50	10	30	2	1670	7.5	223	96
436477	DVL.2-50-30-10-55	50	10	30	2	2660	7.5	355	96
436478	DVL.2-50-30-10-70	50	10	30	2	5170	7.5	689	96
436481	DVL.2-50-30-17-40	50	17	30	2	1535	7.5	205	93
436482	DVL.2-50-30-17-55	50	17	30	2	2530	7.5	337	93
436483	DVL.2-50-30-17-70	50	17	30	2	4980	7.5	664	93
436486	DVL.2-50-30-21-40	50	21	30	2	1395	7.5	186	84
436487	DVL.2-50-30-21-55	50	21	30	2	2293	7.5	306	84
436488	DVL.2-50-30-21-70	50	21	30	2	4450	7.5	593	84
436491	DVL.2-50-40-17-40	50	17	40	2	1352	10	135	112
436492	DVL.2-50-40-17-55	50	17	40	2	2365	10	237	112
436493	DVL.2-50-40-17-70	50	17	40	2	4580	10	458	112
436496	DVL.2-50-50-17-40	50	17	50	2	1385	12.5	111	131
436497	DVL.2-50-50-17-55	50	17	50	2	2143	12.5	171	131
436498	DVL.2-50-50-17-70	50	17	50	2	4200	12.5	336	131
436501	DVL.2-50-50-21-40	50	21	50	2	1205	12.5	96	69
436502	DVL.2-50-50-21-55	50	21	50	2	2177	12.5	174	69
436503	DVL.2-50-50-21-70	50	21	50	2	3320	12.5	266	69



Vibration mounts 21



Vibration mounts 21

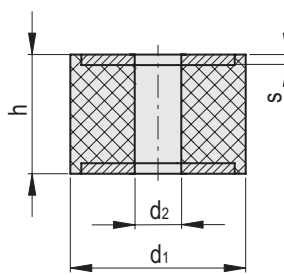

DVL.2

Code	Description	d1	d2	h	s	Max. load [N]	Max. deflection [mm]	Stiffness [N/mm]	
436506	DVL.2-60-13-20.5-40	60	20.5	13	2	5340	3.25	1643	83
436507	DVL.2-60-13-20.5-55	60	20.5	13	2	8650	3.25	2662	83
436508	DVL.2-60-13-20.5-70	60	20.5	13	2	14980	3.25	4609	83
436511	DVL.2-60-30-10.5-40	60	10.5	30	2	3410	7.5	455	168
436512	DVL.2-60-30-10.5-55	60	10.5	30	2	5250	7.5	700	168
436513	DVL.2-60-30-10.5-70	60	10.5	30	2	10540	7.5	1405	168
436516	DVL.2-60-30-18-40	60	18	30	2	2680	7.5	357	160
436517	DVL.2-60-30-18-55	60	18	30	2	4420	7.5	589	160
436518	DVL.2-60-30-18-70	60	18	30	2	7950	7.5	1060	160
436521	DVL.2-60-30-21.5-40	60	21.5	30	2	2570	7.5	343	134
436522	DVL.2-60-30-21.5-55	60	21.5	30	2	4070	7.5	543	134
436523	DVL.2-60-30-21.5-70	60	21.5	30	2	6960	7.5	928	134
436526	DVL.2-60-50-21-40	60	21	50	2	2010	12.5	161	188
436527	DVL.2-60-50-21-55	60	21	50	2	3170	12.5	254	188
436528	DVL.2-60-50-21-70	60	21	50	2	5580	12.5	446	188
436531	DVL.2-75-30-25-40	75	25	30	3	4750	7.5	633	304
436532	DVL.2-75-30-25-55	75	25	30	3	8170	7.5	1089	304
436533	DVL.2-75-30-25-70	75	25	30	3	14190	7.5	1892	304
436536	DVL.2-75-55-25-40	75	25	55	3	3200	13.75	306	358
436537	DVL.2-75-55-25-55	75	25	55	3	5910	13.75	430	358
436538	DVL.2-75-55-25-70	75	25	55	3	8930	13.75	649	358
436541	DVL.2-100-50-30-40	100	30	50	3	6990	12.5	559	622
436542	DVL.2-100-50-30-55	100	30	50	3	11850	12.5	948	622
436543	DVL.2-100-50-30-70	100	30	50	3	18560	12.5	1485	622
436546	DVL.2-100-60-21-40	100	21	60	3	7260	15	484	685
436547	DVL.2-100-60-21-55	100	21	60	3	11710	15	781	685
436548	DVL.2-100-60-21-70	100	21	60	3	21090	15	1406	685

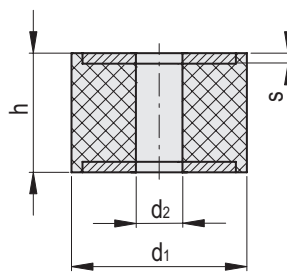

DVL.2-SST

STAINLESS STEEL

Code	Description	d1	d2	h	s	Max. load [N]	Max. deflection [mm]	Stiffness [N/mm]	⚖️
436562	DVL.2-15-25-6-SST-55	15	6	25	2	120	6.25	120	11
436567	DVL.2-20-25-6-SST-55	20	6	25	2	235	6.25	235	14
436572	DVL.2-25-20-6.6-SST-55	25	6.6	20	2	710	5	710	19
436577	DVL.2-30-15-16-SST-55	30	16	15	2	825	3.75	825	23
436582	DVL.2-35-15-19-SST-55	35	19	15	2	1806	3.75	1806	28
436587	DVL.2-35-20-13-SST-55	35	13	20	2	1491	5	1491	36
436592	DVL.2-40-20-13-SST-55	40	13	20	2	1995	5	1995	45
436597	DVL.2-40-28-13-SST-55	40	13	28	2	1620	7	1620	54
436602	DVL.2-40-30-13-SST-55	40	13	30	2	1500	7.5	1500	58
436607	DVL.2-40-35-13-SST-55	40	13	35	2	1495	8.75	1495	65
436612	DVL.2-40-40-13-SST-55	40	13	40	2	1340	10	1340	71
436617	DVL.2-50-15-21-SST-55	50	21	15	2	3940	3.75	3940	59
436622	DVL.2-50-20-17-SST-55	50	17	20	2	3790	5	3790	74
436627	DVL.2-50-20-21-SST-55	50	21	20	2	3270	5	3270	69
436632	DVL.2-50-25-11-SST-55	50	11	25	2	3620	6.25	3620	91
436637	DVL.2-50-30-10-SST-55	50	10	30	2	2660	7.5	2660	96
436642	DVL.2-50-30-17-SST-55	50	17	30	2	2530	7.5	2530	93
436647	DVL.2-50-30-21-SST-55	50	21	30	2	2293	7.5	2293	84
436652	DVL.2-50-40-17-SST-55	50	17	40	2	2365	10	2365	112
436657	DVL.2-50-50-17-SST-55	50	17	50	2	2143	12.5	2143	131
436662	DVL.2-50-50-21-SST-55	50	21	50	2	2177	12.5	2177	69
436667	DVL.2-60-13-20.5-SST-55	60	20.5	13	2	8650	3.25	8650	83
436672	DVL.2-60-30-10.5-SST-55	60	10.5	30	2	5250	7.5	5250	168
436677	DVL.2-60-30-18-SST-55	60	18	30	2	4420	7.5	4420	160
436682	DVL.2-60-30-21.5-SST-55	60	21.5	30	2	4070	7.5	4070	134
436687	DVL.2-60-50-21-SST-55	60	21	50	2	3170	12.5	3170	188
436692	DVL.2-75-30-25-SST-55	75	25	55	3	8170	7.5	8170	304
436697	DVL.2-75-55-25-SST-55	75	25	55	3	5910	13.75	5910	358
436702	DVL.2-100-50-30-SST-55	100	30	50	3	11850	12.5	11850	622
436707	DVL.2-100-60-21-SST-55	100	21	60	3	11710	15	11710	685



Vibration mounts 21