

Rubber buffers

Rubber and steel or stainless steel

STANDARD EXECUTIONS

- **DVC.1:** threaded studs and base plate in polished zinc-plated steel, vibration-damper body in natural rubber NR, black colour, hardness 40, 55, 70 Shore A ± 5 .
- **DVC.1-SST:** threaded studs and base plate in INOX AISI 304 stainless steel, vibration-damper body in natural rubber NR, black colour, hardness 55 Shore A ± 5 .

FEATURES AND APPLICATIONS

The rubber buffers have been designed to damp vibrations, shocks and noises produced by moving bodies or non-balanced vibrating masses of equipment and machines.

Unlike DVA rubber buffers, under pressure these articles allow more lateral movement without leaving the vertical plane of the metal insert.

Vibrations can cause:

- malfunctioning and reduction of the machine lifespan and/or of the adjacent ones;
- damage to operator's health;
- noise.

Load diagrams for each single code are available on request.

See Technical data and guidelines for the choice(on page).

SPECIAL EXECUTIONS ON REQUEST

Natural rubber NR, hardness 40, 70 Shore A ± 5 , for executions with AISI 304 stainless steel base.





Vibration mounts 21

DVC.1-SST

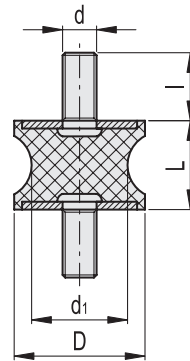

DVC.1 - 10 - 4.5 - 8 - SST - M4 - 10 - 55
 D d1 L Stainless steel d l Shore A

Description	D	L	d	d1	l	△	Hardness 40 Shore A			Hardness 55 Shore A			Hardness 70 Shore A			
							Code	Max load [N]	Max deflection [mm]	Stiffness [N/mm]	Code	Max load [N]	Max deflection [mm]	Stiffness [N/mm]	Code	Max load [N]
DVC.1-10-4.5-8-SST-M4-10-55	10	8	M4	4.5	10	5	43	2	22	433601	80	2	40	105	2	53
DVC.1-10-8-10-SST-M4-10-55	10	10	M4	8	10	8	37	2.5	15	433606	69	2.5	28	98	2.5	39
DVC.1-15-8.5-15-SST-M4-10-55	15	15	M4	8.5	10	12	113	3.75	30	433611	154	3.75	41	207	3.75	55
DVC.1-15-12-15-SST-M4-10-55	15	15	M4	12	10	14	121	3.75	32	433616	163	3.75	43	221	3.75	59
DVC.1-20-14-15-SST-M6-18-55	20	15	M6	14	18	18	211	3.75	56	433631	273	3.75	73	325	3.75	87
DVC.1-20-14-19-SST-M6-18-55	20	19	M6	14	18	25	193	4.75	41	433633	238	4.75	50	302	4.75	64
DVC.1-20-14-20-SST-M6-18-55	20	20	M6	14	18	26	191	5	38	433635	231	5	46	300	5	60
DVC.1-21-16-22-SST-M6-18-55	21	22	M6	16	18	28	205	5.5	37	433641	268	5.5	49	315	5.5	57
DVC.1-20-12-30-SST-M6-18-55	20	30	M6	12	18	30	126	7.5	17	433621	194	7.5	26	217	7.5	29
DVC.1-20-14-30-SST-M6-18-55	20	30	M6	14	18	32	475	7.5	63	433637	202	7.5	27	301	7.5	40
DVC.1-25-18-20-SST-M6-18-55	25	20	M6	18	18	31	539	5	108	433651	887	5	177	1332	5	266
DVC.1-25-20-20-SST-M6-18-55	25	20	M6	20	18	33	560	5	112	433656	902	5	180	1380	5	276
DVC.1-30-22-20-SST-M8-20-55	30	20	M8	22	20	45	738	5	148	433666	1087	5	217	2005	5	401
DVC.1-30-18-25-SST-M8-20-55	30	25	M8	18	20	50	436	6.25	70	433661	671	6.25	107	1342	6.25	215
DVC.1-35-31-15-SST-M8-20-55	35	15	M8	31	20	46	1120	3.75	299	433676	2097	3.75	559	3215	3.75	857
DVC.1-35-25-34-SST-M8-20-55	35	34	M8	25	20	56	1073	8.5	126	433671	1564	8.5	184	2415	8.5	284
DVC.1-40-30-25-SST-M8-23-55	40	25	M8	30	23	58	1823	6.25	292	433685	2430	6.25	389	3378	6.25	540
DVC.1-40-25-30-SST-M8-23-55	40	30	M8	25	23	64	937	7.5	125	433683	1621	7.5	216	2246	7.5	299
DVC.1-40-33-30-SST-M8-23-55	40	30	M8	33	23	68	1007	7.5	134	433689	1873	7.5	250	2423	7.5	323
DVC.1-40-20-48-SST-M8-23-55	40	48	M8	20	23	76	498	12	42	433681	705	12	59	1123	12	94
DVC.1-40-32-50-SST-M8-23-55	40	50	M8	32	23	82	521	12.5	42	433687	795	12.5	64	1321	12.5	106
DVC.1-50-46-15-SST-M10-28-55	50	15	M10	46	28	94	1027	3.75	274	433696	2430	3.75	648	3385	3.75	903
DVC.1-50-42-30-SST-M10-28-55	50	30	M10	42	28	184	1095	7.5	146	433691	1523	7.5	203	2271	7.5	303
DVC.1-55-44-45-SST-M10-28-55	55	45	M10	44	28	233	911	11.25	81	433693	1328	11.25	118	1974	11.25	175
DVC.1-57-25-45-SST-M10-28-55	57	45	M10	25	28	242	902	11.25	80	433701	1222	11.25	109	1765	11.25	157
DVC.1-60-49-60-SST-M10-28-55	60	60	M10	49	28	264	2188	15	146	433706	3785	15	252	4325	15	288
DVC.1-70-45-53-SST-M12-37-55	70	53	M12	45	37	280	1897	13.25	143	433711	2114	13.25	160	3228	13.25	244
DVC.1-72-64-33.5-SST-M12-37-55	72	33.5	M12	64	37	297	2875	8.38	343	433716	4170	8.38	498	7315	8.38	873
DVC.1-75-60-40-SST-M12-37-55	75	40	M12	60	37	380	2409	10	241	433721	3610	10	361	6988	10	699
DVC.1-95-80-75-SST-M16-41-55	95	75	M16	80	41	1090	7584	18.75	404	433726	10865	18.75	579	13263	18.75	707