

Rubber buffers

Rubber and steel or stainless steel

STANDARD EXECUTIONS

- **DVA.6:** threaded stud and base plate in polished zinc-plated steel, vibration-damper body in natural rubber NR, black colour, hardness 40, 55, 70 Shore A ± 5 .
- **DVA.6-SST:** threaded stud and base plate in INOX AISI 304 stainless steel, vibration-damper body in natural rubber NR, black colour, hardness 55 Shore A ± 5 .

FEATURES AND APPLICATIONS

The rubber buffers have been designed to damp vibrations, shocks and noises produced by moving bodies or non-balanced vibrating masses of equipment and machines which can cause:

- malfunctioning and reduction of the machine lifespan and/or of the adjacent ones;
- damage to health;
- noise.

Load diagrams for each single code are available on request.
See Technical data and guidelines for the choice.



SPECIAL EXECUTIONS ON REQUEST

Natural rubber NR, hardness 40, 70 tolerance ± 5 Shore A for executions with AISI 304 stainless steel base.

DVA.6

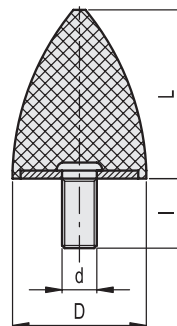

* Complete the description with the desired hardness: 40, 55 or 70 tolerance ± 5 Shore A.

DVA.6 - 20 - 24 - M6 - 18 - 55
 D L d I Shore A

DVA.6

Description	D	L	d	I	⚖	Hardness 40 Shore A			Hardness 55 Shore A			Hardness 70 Shore A					
						Code	Max load [N]	Max deflection [mm]	Stiffness [N/mm]	Code	Max load [N]	Max deflection [mm]	Stiffness [N/mm]	Code	Max load [N]	Max deflection [mm]	Stiffness [N/mm]
DVA.6-10-10-M5-12-*	10	10	M5	12	2	416991	46	3	14	413381	59	3	20	418791	113	3	40
DVA.6-20-15-M6-18-*	20	15	M6	18	9	416997	84	5	17	413397	194	4	48	418797	321	4	78
DVA.6-20-24-M6-18-*	20	24	M6	18	10	416101	82	6	14	413401	130	6	22	418801	330	6	55
DVA.6-25-20-M6-18-*	25	20	M6	18	15	416107	84	5	17	413407	190	5	38	418807	495	5	96
DVA.6-30-30-M8-18-*	30	30	M8	18	24	416111	190	8	25	413411	260	8	35	418811	630	8	84
DVA.6-30-36-M8-20-*	30	36	M8	20	39	416121	180	9	20	413421	320	9	36	418821	650	9	72
DVA.6-35-40-M8-23-*	35	40	M8	23	45	416131	260	10	26	413431	300	10	30	418831	630	10	63
DVA.6-50-50-M8-28-*	50	50	M8	28	111	416133	535	12	43	413434	865	12	69	418833	2100	12	168
DVA.6-50-50-M10-28-*	50	50	M10	28	110	416137	481	13	38	413437	740	13	59	418837	1656	13	132
DVA.6-50-58-M8-28-*	50	58	M8	28	111	416135	430	15	30	413435	760	15	52	418835	1080	15	74
DVA.6-50-58-M10-28-*	50	58	M10	28	112	416139	460	14	31	413436	865	14	60	418846	1755	14	121
DVA.6-50-61-M8-28-*	50	61	M8	28	114	416141	490	15	32	413441	600	15	39	418841	1520	15	100
DVA.6-50-67-M8-28-*	50	67	M8	28	130	416138	500	16	30	413446	980	16	58	418836	1750	16	104
DVA.6-50-68-M10-28-*	50	68	M10	28	131	416151	490	17	29	413451	890	17	52	418851	1950	17	115
DVA.6-70-58-M12-37-*	70	58	M12	37	258	416171	769	15	53	413471	1332	15	92	418871	1923	15	133
DVA.6-75-89-M12-37-*	75	89	M12	37	373	416181	971	22	44	413481	1680	22	76	418881	2328	22	105
DVA.6-95-80-M16-41-*	95	80	M16	41	488	416191	1970	20	98	413491	3090	20	154	418891	5540	20	277
DVA.6-115-136-M16-41-*	115	136	M16	41	603	416211	2600	34	76	413501	4330	34	127	418901	7730	34	227



Vibration mounts 21

DVA.6-SST

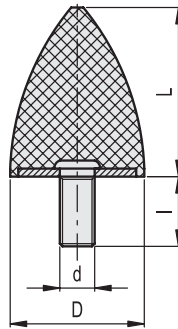

DVA.6 - 20 - 24 - SST - M6 - 18 - 55

D L Stainless steel d I Shore A

DVA.6-SST

STAINLESS STEEL

Description	D	L	d	I	⚖	Hardness 40 Shore A			Hardness 55 Shore A			Hardness 70 Shore A					
						Code	Max load [N]	Max deflection [mm]	Stiffness [N/mm]	Code	Max load [N]	Max deflection [mm]	Stiffness [N/mm]	Code	Max load [N]	Max deflection [mm]	Stiffness [N/mm]
DVA.6-10-10-SST-M5-12-55	10	10	M5	12	2		46	3	14	410499	59	3	20		113	3	40
DVA.6-20-15-SST-M6-18-55	20	15	M6	18	9		84	5	17	410500	194	4	48		321	4	78
DVA.6-20-24-SST-M6-18-55	20	24	M6	18	10		82	6	14	410501	130	6	22		330	6	55
DVA.6-25-20-SST-M6-18-55	25	20	M6	18	15		84	5	17	410503	190	5	38		495	5	96
DVA.6-30-30-SST-M8-18-55	30	30	M8	18	24		190	8	25	410505	260	8	35		630	8	84
DVA.6-30-36-SST-M8-20-55	30	36	M8	20	39		180	9	20	410507	320	9	36		650	9	72
DVA.6-35-40-SST-M8-23-55	35	40	M8	23	45		260	10	26	410511	300	10	30		630	10	63
DVA.6-50-50-SST-M8-28-55	50	50	M8	28	111	ON REQUEST	535	12	43	410517	865	12	69	ON REQUEST	2100	12	168
DVA.6-50-50-SST-M10-28-55	50	50	M10	28	110	ON REQUEST	481	13	38	410519	740	13	59	ON REQUEST	1656	13	132
DVA.6-50-58-SST-M8-28-55	50	58	M10	28	112	ON REQUEST	555	14	40	410515	865	14	60	ON REQUEST	1991	14	142
DVA.6-50-58-SST-M10-28-55	50	58	M8	28	111	ON REQUEST	460	15	31	410520	685	15	49	ON REQUEST	1755	14	121
DVA.6-50-61-SST-M8-28-55	50	61	M8	28	114	ON REQUEST	490	15	32	410521	600	15	39	ON REQUEST	1520	15	100
DVA.6-50-67-SST-M8-28-55	50	67	M8	28	130	ON REQUEST	500	16	30	410516	980	16	58	ON REQUEST	1750	16	104
DVA.6-50-68-SST-M10-28-55	50	68	M10	28	131	ON REQUEST	490	17	29	410523	890	17	52	ON REQUEST	1950	17	115
DVA.6-70-58-SST-M12-37-55	70	58	M12	37	258	ON REQUEST	769	15	53	410551	1332	15	92	ON REQUEST	1923	15	133
DVA.6-75-89-SST-M12-37-55	75	89	M12	37	373	ON REQUEST	971	22	44	410561	1680	22	76	ON REQUEST	2328	22	105
DVA.6-95-80-SST-M16-41-55	95	80	M16	41	488	ON REQUEST	1970	20	98	410566	3090	20	154	ON REQUEST	5540	20	277
DVA.6-115-136-SST-M16-41-55	115	136	M16	41	603	ON REQUEST	2600	34	76	410571	4330	34	127	ON REQUEST	7730	34	227