

Rubber buffers

Rubber and steel or stainless steel

STANDARD EXECUTIONS

- **DVA.2:** bushing with threaded blind hole, threaded stud and base plate in polished zinc-plated steel, vibration-damper body in natural rubber NR, black colour, hardness 40, 55, 70 Shore A ± 5 .
- **DVA.2-SST:** bushing with threaded blind hole, threaded stud and base plate in AISI 304 stainless steel, vibration-damper body in natural rubber NR, black colour, hardness 55 Shore A ± 5 .

FEATURES AND APPLICATIONS

The rubber buffers have been designed to damp vibrations, shocks and noises produced by moving bodies or non-balanced vibrating masses of equipment and machines which can cause:

- malfunctioning and reduction of the machine lifespan and/or of the adjacent ones;
- damage to health;
- noise.

Load diagrams for each single code are available on request.

See Technical data and guidelines for the choice.

SPECIAL EXECUTIONS ON REQUEST

Natural rubber NR, hardness 40, 70 tolerance ± 5 Shore A for executions with AISI 304 stainless steel base.

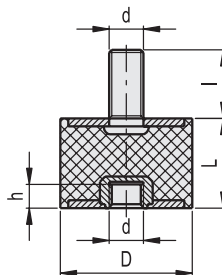

* Complete the description with the desired hardness: 40, 55 or 70 tolerance ± 5 Shore A.

DVA.2

DVA.2 - 8 - 8 - M3 - 6 - 55
 D L d l Shore A

DVA.2

Description	D	L	d	l	h	⚖	Hardness 40 Shore A			Hardness 55 Shore A			Hardness 70 Shore A					
							Code	Max load [N]	Max deflection [mm]	Stiffness [N/mm]	Code	Max load [N]	Max deflection [mm]	Stiffness [N/mm]	Code	Max load [N]	Max deflection [mm]	Stiffness [N/mm]
DVA.2-6-7-M3-6-*	6	7	M3	6	3	1	414291	34	2	19	411681	265	2	151	417000	628	1.8	359
DVA.2-8-8-M3-6-*	8	8	M3	6	3	1	414301	50	2	25	411701	85	2	43	417001	150	2	75
DVA.2-8-13-M3-6-*	8	13	M3	6	3	2	414303	38	3	12	411703	70	3	21	417003	145	3	45
DVA.2-10-10-M4-10-*	10	10	M4	10	4	2	414311	75	3	30	411721	100	3	40	417011	200	3	80
DVA.2-10-15-M4-10-*	10	15	M4	10	4	3	414321	65	4	17	411731	100	4	27	417021	150	4	40
DVA.2-10-20-M4-10-*	10	20	M4	10	4	3	414323	59	5	12	411733	93	5	19	417023	132	5	26
DVA.2-15-10-M4-10-*	15	10	M4	10	4	5	414331	210	2	105	411741	325	2	163	417031	717	2	359
DVA.2-15-15-M4-10-*	15	15	M4	10	4	6	414341	155	4	41	411761	280	4	75	417041	513	4	137
DVA.2-15-20-M4-10-*	15	20	M4	10	4	7	414351	151	5	30	411771	234	5	47	417051	468	5	94
DVA.2-15-25-M4-10-*	15	25	M4	10	4	8	414353	133	6	21	411773	234	6	37	417053	505	6	81
DVA.2-15-30-M4-10-*	15	30	M4	10	4	10	414355	149	7	20	411776	215	7	29	417056	460	7	61

* Complete the description with the desired hardness:
40, 55 or 70 tolerance ±5 Shore A.

DVA.2

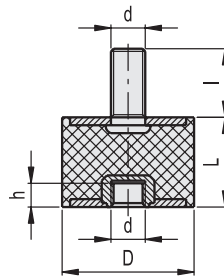

DVA.2 - 8 - 8 - M3 - 6 - 55
D L d I Shore A

DVA.2

Description	D	L	d	I	h	⚖	Hardness 40 Shore A			Hardness 55 Shore A			Hardness 70 Shore A					
							Code	Max load [N]	Max deflection [mm]	Stiffness [N/mm]	Code	Max load [N]	Max deflection [mm]	Stiffness [N/mm]	Code	Max load [N]	Max deflection [mm]	Stiffness [N/mm]
DVA.2-20-15-M6-18-*	20	15	M6	18	6	15	414361	322	4	86	411781	479	4	128	417061	1044	4	278
DVA.2-20-20-M6-18-*	20	20	M6	18	6	17	414371	220	5	44	411801	430	5	86	417071	995	5	199
DVA.2-20-25-M6-18-*	20	25	M6	18	6	18	414381	264	6	42	411811	433	6	69	417081	1010	6	162
DVA.2-20-30-M6-18-*	20	30	M6	18	6	21	414383	261	8	35	411813	417	8	56	417083	1213	8	162
DVA.2-25-15-M6-18-*	25	15	M6	18	6	26	414391	860	4	229	411821	1068	4	285	417091	2690	4	717
DVA.2-25-20-M6-18-*	25	20	M6	18	6	28	414401	391	5	78	411841	620	5	124	417101	1533	5	307
DVA.2-25-30-M6-18-*	25	30	M6	18	6	36	414411	430	7.5	57	411851	524	8	70	417111	1208	8	161
DVA.2-30-15-M8-20-*	30	15	M8	20	8	41	414421	1970	2	985	411861	2100	1	1400	417121	2700	1.5	1800
DVA.2-30-20-M8-20-*	30	20	M8	20	8	43	414431	1300	5	260	411881	3070	5	614	417131	2000	2.75	727
DVA.2-30-25-M8-18-*	30	25	M8	18	8	46	414436	790	6	126	411886	1260	6	202	417136	2650	6.3	424
DVA.2-30-30-M8-20-*	30	30	M8	20	8	50	414441	500	8	67	411901	1055	8	141	417141	1960	8	261
DVA.2-30-40-M8-20-*	30	40	M8	20	8	60	414443	600	10	60	411903	932	10	93	417143	2000	10	200
DVA.2-40-20-M8-23-*	40	20	M8	23	8	73	414451	3490	5	698	411911	2200	3	628	417151	10160	5	2032
DVA.2-40-20-M10-23-*	40	20	M10	23	10	72	414476	3660	5	732	411951	21050	5	4210	417173	10220	5	2044
DVA.2-40-28-M10-23-*	40	28	M10	23	10	78	414477	1318	7	188	411953	3020	7	431	417174	5980	7	854
DVA.2-40-30-M8-23-*	40	30	M8	23	8	85	414461	1137	8	152	411921	1574	8	210	417161	3420	8	456
DVA.2-40-35-M10-23-*	40	35	M10	23	10	90	414478	1328	9	152	411955	2090	9	239	417175	3390	8.8	387
DVA.2-40-40-M8-23-*	40	40	M8	23	8	98	414471	1056	10	106	411941	1397	10	140	417171	3190	10	319
DVA.2-40-40-M10-23-*	40	40	M10	23	10	97	414479	1070	10	107	411957	1873	10	187	417176	2100	10	210
DVA.2-50-20-M10-28-*	50	20	M10	28	10	115	414481	11610	5	2322	411961	14030	5	2806	417181	22540	5	4508
DVA.2-50-25-M10-28-*	50	25	M10	28	10	120	414486	3900	6	624	411971	5540	6	886	417186	12020	6.3	1923
DVA.2-50-30-M10-28-*	50	30	M10	28	10	135	414491	2010	8	268	411981	3300	8	440	417191	5450	8	727
DVA.2-50-35-M10-28-*	50	35	M10	28	10	145	414496	2245	9	257	411991	3270	9	374	417196	7980	8.8	912
DVA.2-50-40-M10-28-*	50	40	M10	28	10	160	414501	1477	10	148	412001	2130	10	213	417201	4940	10	494
DVA.2-50-45-M10-28-*	50	45	M10	28	10	170	414511	1368	11	122	412021	2046	11	182	417211	2580	11	229
DVA.2-50-50-M10-28-*	50	50	M10	28	10	185	414521	1670	12.5	134	412026	2188	13	175	417221	4750	13	380
DVA.2-60-30-M10-28-*	60	30	M10	28	10	199	414531	3020	8	403	412031	4170	8	556	417231	9130	8	1217
DVA.2-60-36-M10-28-*	60	36	M10	28	10	198	414536	2940	9	327	412033	5000	9	555	417236	9370	9	1041
DVA.2-60-40-M10-28-*	60	40	M10	28	10	220	414541	2520	10	252	412036	3610	10	361	417241	6950	10	695
DVA.2-60-50-M10-28-*	60	50	M10	28	10	245	414543	2650	13	212	412039	3410	13	273	417243	6570	13	526
DVA.2-70-30-M10-28-*	70	30	M10	28	10	329	414550	5940	8	792	412040	8570	8	1143	417250	24010	7	3382
DVA.2-70-45-M10-28-*	70	45	M10	28	10	372	414551	3810	11	339	412041	7130	11	634	417251	13210	11	1174
DVA.2-70-50-M10-27-*	70	50	M10	27	10	377	414553	4300	12	344	411683	5930	12	474	417253	14150	12.5	1132
DVA.2-70-70-M10-27-*	70	70	M10	27	10	382	414556	3500	17	200	412046	5010	17	286	417255	8400	17.5	480
DVA.2-75-25-M12-37-*	75	25	M12	37	12	321	414561	6150	4	1537	412051	10000	3	3333	417261	15900	3	5300
DVA.2-75-40-M12-37-*	75	40	M12	37	12	385	414571	4910	10	491	412061	6970	10	697	417271	14800	8	1850
DVA.2-75-45-M12-37-*	75	45	M12	37	12	390	414573	5070	11	451	412071	7050	11	627	417273	15510	11.3	1379
DVA.2-75-50-M12-37-*	75	50	M12	37	12	405	414576	4240	12	339	412076	7010	12	561	417276	15010	12.5	1201
DVA.2-75-55-M12-37-*	75	55	M12	37	12	450	414581	3470	14	252	412081	7510	14	546	417281	11240	14	817
DVA.2-80-40-M14-37-*	80	40	M14	37	14	510	414586	10430	10	1043	412091	16710	10	1671	417286	27700	10	2770
DVA.2-100-40-M16-41-*	100	40	M16	41	16	740	414591	13990	10	1399	412101	20000	10	2000	417291	29000	10	2900
DVA.2-100-55-M16-41-*	100	55	M16	41	16	850	414601	7320	14	532	412121	13080	14	951	417301	24260	14	1764
DVA.2-100-60-M16-41-*	100	60	M16	41	16	865	414611	7000	15	467	412141	11290	15	753	417311	28500	15	1900
DVA.2-100-75-M16-41-*	100	75	M16	41	16	980	414621	7790	19	415	412161	9640	19	514	417321	22350	19	1192
DVA.2-125-55-M16-41-*	125	55	M16	41	16	1320	414651	17600	14	1280	412181	19260	14	1401	417351	23610	8	3008
DVA.2-125-75-M16-41-*	125	75	M16	41	16	1600	414661	12760	19	681	412191	19440	19	1037	417361	24205	19	1291



Vibration mounts 21

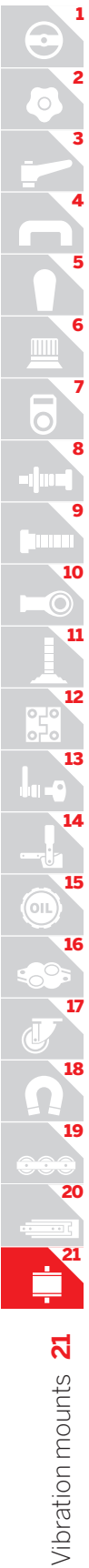

DVA.2 - 8 - 8 - SST - M3 - 6 - 55
 D L Stainless steel d l Shore A

DVA.2-SST

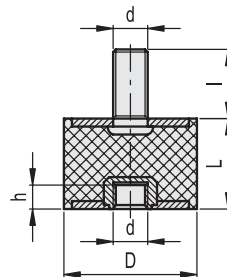

DVA.2-SST

STAINLESS STEEL

Description	D	L	d	l	h	Hardness 40 Shore A			Hardness 55 Shore A			Hardness 70 Shore A						
						Code	Max load [N]	Max deflection [mm]	Stiffness [N/mm]	Code	Max load [N]	Max deflection [mm]	Stiffness [N/mm]	Code	Max load [N]	Max deflection [mm]	Stiffness [N/mm]	
DVA.2-6-7-SST-M3-6-55	6	7	M3	6	3	1		34	2	19	410100	265	2	151		628	2	359
DVA.2-8-8-SST-M3-6-55	8	8	M3	6	3	1		50	2	25	410101	85	2	43		150	2	75
DVA.2-8-13-SST-M3-6-55	8	13	M3	6	3	2		38	3	12	410103	70	3	21		145	3	45
DVA.2-10-10-SST-M4-10-55	10	10	M4	10	4	2		75	3	30	410105	100	3	40		200	3	80
DVA.2-10-15-SST-M4-10-55	10	15	M4	10	4	3		65	4	17	410107	100	4	27		150	4	40
DVA.2-10-20-SST-M4-10-55	10	20	M4	10	4	3		59	5	12	410109	93	5	19		132	5	26
DVA.2-15-10-SST-M4-10-55	15	10	M4	10	4	5		210	2	105	410113	325	2	163		717	2	359
DVA.2-15-15-SST-M4-10-55	15	15	M4	10	4	6		155	4	41	410115	280	4	75		513	4	137
DVA.2-15-20-SST-M4-10-55	15	20	M4	10	4	7		151	5	30	410117	234	5	47		468	5	94
DVA.2-15-25-SST-M4-10-55	15	25	M4	10	4	8	ON REQUEST	133	6	21	410119	234	6	37	ON REQUEST	505	6	81
DVA.2-15-30-SST-M4-10-55	15	30	M4	10	4	10	ON REQUEST	149	7.5	20	410120	215	7	29	ON REQUEST	460	7.5	61
DVA.2-20-15-SST-M6-18-55	20	15	M6	18	6	15	ON REQUEST	322	4	86	410121	479	4	128	ON REQUEST	1044	4	278
DVA.2-20-20-SST-M6-18-55	20	20	M6	18	6	17	ON REQUEST	220	5	44	410123	430	5	86	ON REQUEST	995	5	199
DVA.2-20-25-SST-M6-18-55	20	25	M6	18	6	18	ON REQUEST	264	6	42	410125	433	6	69	ON REQUEST	1010	6	162
DVA.2-20-30-SST-M6-18-55	20	30	M6	18	6	21	ON REQUEST	261	8	35	410127	417	8	56	ON REQUEST	1213	8	162
DVA.2-25-15-SST-M6-18-55	25	15	M6	18	6	26		860	4	229	410131	1068	4	285		2690	4	717
DVA.2-25-20-SST-M6-18-55	25	20	M6	18	6	28		391	5	78	410133	620	5	124		1533	5	307
DVA.2-25-30-SST-M6-18-55	25	30	M6	18	6	36		432	8	58	410137	524	8	70		1208	8	161
DVA.2-30-15-SST-M8-20-55	30	15	M8	20	8	41		986	4	263	410141	2080	4	555		3300	4	880
DVA.2-30-20-SST-M8-20-55	30	20	M8	20	8	43		1300	5	260	410143	3070	5	614		7540	5	1508
DVA.2-30-25-SST-M8-18-55	30	25	M8	18	8	46		790	6	126	410144	1260	6	202		2650	6	424
DVA.2-30-30-SST-M8-20-55	30	30	M8	20	8	50		500	8	67	410145	1055	8	141		1960	8	261
DVA.2-30-40-SST-M8-20-55	30	40	M8	20	8	60		591	10	59	410147	932	10	93		2000	10	200

DVA.2 - 8 - 8 - SST - M3 - 6 - 55
 D L Stainless steel d I Shore A

DVA.2-SST

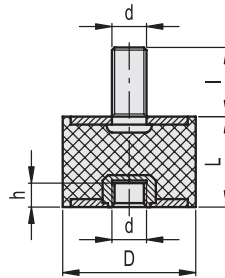

DVA.2-SST

STAINLESS STEEL

Description	D	L	d	I	h	⚖️	Hardness 40 Shore A			Hardness 55 Shore A			Hardness 70 Shore A					
							Code	Max load [N]	Max deflection [mm]	Stiffness [N/mm]	Code	Max load [N]	Max deflection [mm]	Stiffness [N/mm]	Code	Max load [N]	Max deflection [mm]	Stiffness [N/mm]
DVA.2-40-20-SST-M8-23-55	40	20	M8	23	8	73		3490	5	698	410151	8420	5	1684		10160	5	2032
DVA.2-40-20-SST-M10-23-55	40	20	M10	23	10	72		3660	5	732	410150	21050	5	4210		10220	5	2044
DVA.2-40-28-SST-M10-23-55	40	28	M10	23	10	72		1318	7	188	410152	3020	7	431.4		5980	7	854
DVA.2-40-30-SST-M8-23-55	40	30	M8	23	8	85		1137	8	152	410153	1574	8	210		3420	8	456
DVA.2-40-35-SST-M10-23-55	40	35	M10	23	10	90		1328	9	152	410154	2090	9	239		3390	9	387
DVA.2-40-40-SST-M8-23-55	40	40	M8	23	8	98		1056	10	106	410155	1397	10	140		3190	10	319
DVA.2-40-40-SST-M10-23-55	40	40	M10	23	10	97		1070	10	107	410156	1873	10	187.3		2100	10	210
DVA.2-50-20-SST-M10-28-55	50	20	M10	28	10	115		11610	5	2322	410161	14030	5	2806		22540	5	4508
DVA.2-50-25-SST-M10-28-55	50	25	M10	28	10	120		3900	69	624	410162	5540	6	886		12020	6	1923
DVA.2-50-30-SST-M10-28-55	50	30	M10	28	10	135		2010	8	268	410163	3300	8	440		5450	8	727
DVA.2-50-35-SST-M10-28-55	50	35	M10	28	10	145		2245	9	257	410164	3270	9	374		7980	9	912
DVA.2-50-40-SST-M10-28-55	50	40	M10	28	10	160		1477	10	148	410165	2130	10	213		4940	10	494
DVA.2-50-45-SST-M10-28-55	50	45	M10	28	10	170		1368	11	122	410167	2046	11	182		2580	11	229
DVA.2-50-50-SST-M10-28-55	50	50	M10	28	10	185		1500	13	120	410169	2188	13	175		4750	13	380
DVA.2-60-30-SST-M10-28-55	60	30	M10	28	10	199		3020	8	403	410171	4170	8	556		9130	8	1217
DVA.2-60-36-SST-M10-28-55	60	36	M10	28	10	220	ON REQUEST	2940	9	327	410174	5000	9	556		9370	9	1041
DVA.2-60-40-SST-M10-28-55	60	40	M10	28	10	198		2520	10	252	410173	3610	10	361		6950	10	695
DVA.2-60-50-SST-M10-28-55	60	50	M10	28	10	245		2650	13	212	410175	3410	13	273		6570	13	526
DVA.2-70-30-SST-M10-28-55	70	30	M10	28	10	329		5940	8	792	410176	8570	8	1143		24010	7	3382
DVA.2-70-45-SST-M10-28-55	70	45	M10	28	10	372		3810	11	339	410177	7130	11	634		13210	11	1174
DVA.2-70-50-SST-M10-27-55	70	50	M10	27	10	377		4300	12	344	410178	5930	12	474		14150	12	1132
DVA.2-70-70-SST-M10-27-55	70	70	M10	27	10	382		3500	17	200	410180	5010	17	286		8400	17	480
DVA.2-75-25-SST-M12-37-55	75	25	M12	37	12	321		6150	4	1537	410181	10000	3	3333		15900	3	5300
DVA.2-75-40-SST-M12-37-55	75	40	M12	37	12	385		4910	10	491	410183	6970	10	697		14800	8	1850
DVA.2-75-45-SST-M12-37-55	75	45	M12	37	12	390		5070	11	450.6	410184	7050	11	627		15510	11	1379
DVA.2-75-50-SST-M12-37-55	75	50	M12	37	12	405		4240	12	339.2	410186	7010	12.5	561		15010	12	1201
DVA.2-75-55-SST-M12-37-55	75	55	M12	37	12	450		3470	14	252	410185	7510	14	546		11240	14	817
DVA.2-80-40-SST-M14-37-55	80	40	M14	37	14	510		10430	10	1043	410187	16710	10	1671		27700	10	2770
DVA.2-100-40-SST-M16-41-55	100	40	M16	41	16	740		13990	10	1399	410191	20000	10	2000		29000	10	2900
DVA.2-100-55-SST-M16-41-55	100	55	M16	41	16	850		7320	14	532	410193	13080	14	951		24260	14	1764
DVA.2-100-60-SST-M16-41-55	100	60	M16	41	16	865		7000	15	467	410195	11290	15	753		28500	15	1900
DVA.2-100-75-SST-M16-41-55	100	75	M16	41	16	980		7790	19	415	410197	9640	19	514		22350	19	1192
DVA.2-125-55-SST-M16-41-55	125	55	M16	41	16	1320		17600	14	1280	410198	19260	14	1401		23610	8	3008
DVA.2-125-75-SST-M16-41-55	125	75	M16	41	16	1600		12760	19	681	410199	19440	19	1037		24205	19	1291



Vibration mounts 21