

# DIN 6330

Hexagon nuts

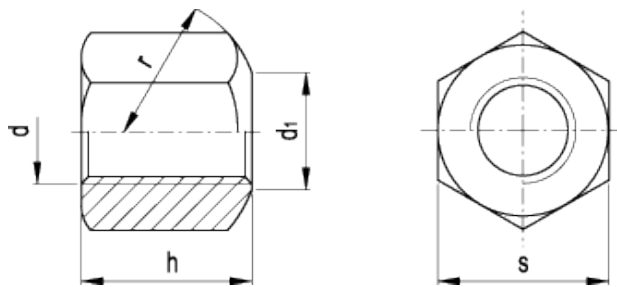

## technical informations

### Material

Black-oxide steel class 10 (tensile strength 1000 N/mm<sup>2</sup>).

### Features and applications

DIN 6330 hexagon nuts are used on clamping applications which require frequent clamping and releasing operations. The spherical seating combined with [DIN 6319](#) concave washers adjusts positioning inaccuracies.

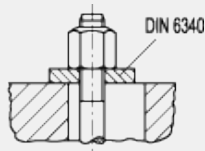
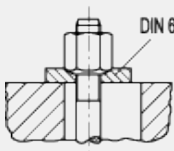

Standard Elements	Main dimensions					Weight
Description	d	d <sub>1 H14</sub>	h	r	s	g
DIN 6330-M8-B	M8	9	12	11	13	9
DIN 6330-M10-B	M10	11.5	15	15	16	20
DIN 6330-M12-B	M12	14	18	17	18	28
DIN 6330-M14-B	M14	16	21	20	22	45
DIN 6330-M16-B	M16	18	24	22	24	53
DIN 6330-M20-B	M20	22	30	27	30	110
DIN 6330-M24-B	M24	26	36	32	36	195
DIN 6330-M30-B	M30	32	45	41	46	405
DIN 6330-M36-B	M36	38	54	50	55	715



STANDARD MACHINE ELEMENTS WORLDWIDE