

DIN 6320

Feet

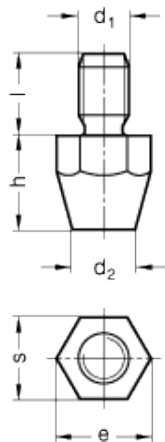

technical informations

Material

Black-oxide steel, not hardened.

Features and applications

Feet DIN 6320 are normally used in jig construction if neither a self-aligning support nor an axial adjustment is required.

Unlike the models specified in the official standard sheet, these feet are made of 1.0718 steel (in place of quenched and tempered steel).

Standard Elements	Main dimensions						Weight
Description	h	d ₁	d ₂	e _{min.}	l	s	g
DIN 6320-10-M6	10	M6	8	11.5	11	10	10
DIN 6320-15-M8	15	M8	10	15	13	13	20
DIN 6320-20-M6	20	M6	6	11.5	11	10	15
DIN 6320-20-M10	20	M10	13	19.6	16	17	25
DIN 6320-25-M12	25	M12	15	21.9	20	19	30
DIN 6320-30-M8	30	M8	9	15	13	13	35
DIN 6320-40-M10	40	M10	13	19.6	16	17	80
DIN 6320-50-M12	50	M12	15	21.9	20	19	130



STANDARD MACHINE ELEMENTS WORLDWIDE