

# DIN 468

Crank handles

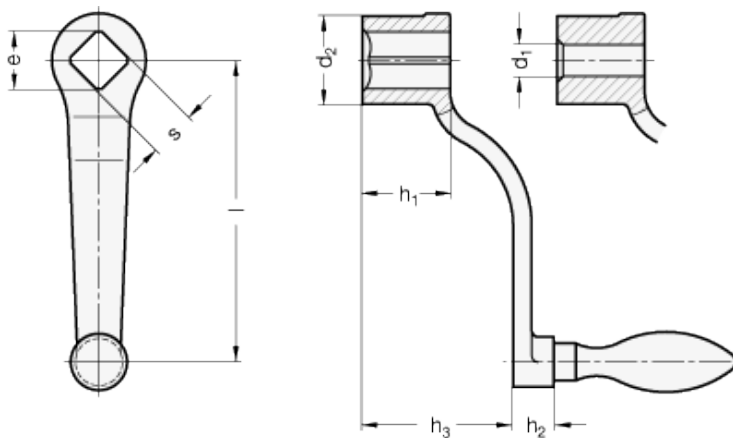

## technical informations

### Material

Nodular deburred cast iron, black colour, matte finish epoxy resin coating.

### Assembly

- Version B: hub with H7 reamed through hole.
- Version V: hub with H11 squared through hole in compliance with details for square [DIN 79](#).

### Handle

- Type D: mirror-polished steel revolving handle type [DIN 98](#).
- Type F: mirror-polished steel fixed handle type [DIN 39](#).

Standard Elements	Main dimensions						Mounting hole			Weight	
Description	l	d <sub>2</sub>	h <sub>1</sub>	h <sub>2</sub>	h <sub>3</sub> -	Ø	s <sub>H11</sub>	e <sub>min.</sub>	d <sub>1 H7</sub>	g	g
DIN 468-63-B6-*	63	20	20	11	32	16	-	-	B6	142	132
DIN 468-63-V10-*	63	20	20	11	32	16	V10	13.1	-	124	114

DIN 468-80-B8-*	80	24	24	13	38	18	-	-	B8	207	195
DIN 468-80-V10-*	80	24	24	13	38	18	V10	13.1	-	195	183
DIN 468-80-V12-*	80	24	24	13	38	18	V12	13.1	-	185	173
DIN 468-100-B10-*	100	28	28	13	48	20	-	-	B10	307	293
DIN 468-100-V12-*	100	28	28	13	48	20	V12	16.1	-	295	281
DIN 468-100-V14-*	100	28	28	13	48	20	V14	16.1	-	282	268
DIN 468-125-B10-*	125	34	34	14	55	22	-	-	B10	477	463
DIN 468-125-V14-*	125	34	34	14	55	22	V14	18.1	-	448	434
DIN 468-125-V17-*	125	34	34	14	55	22	V17	18.1	-	427	413
DIN 468-160-B14-*	160	38	38	14	65	25	-	-	B14	707	697
DIN 468-160-V17-*	160	38	38	14	65	25	V17	22.2	-	664	650
DIN 468-160-V19-*	160	38	38	14	65	25	V19	22.2	-	643	633
DIN 468-200-B17-*	200	44	44	21	78	28	-	-	B17	1066	1043
DIN 468-200-V19-*	200	44	44	21	78	28	V19	25.2	-	1022	999
DIN 468-200-V22-*	200	44	44	21	78	28	V22	25.2	-	965	942
DIN 468-250-B17-*	250	48	48	21	90	32	-	-	B17	1525	1517
DIN 468-250-V22-*	250	48	48	21	90	32	V22	28.2	-	1435	1427
DIN 468-250-V24-*	250	48	48	21	90	32	V24	28.2	-	1382	1374
DIN 468-315-B20-*	315	54	54	26	105	36	-	-	B20	2343	2298
DIN 468-315-V24-*	315	54	54	26	105	36	V24	32.2	-	2168	2123
DIN 468-315-V27-*	315	54	54	26	105	36	V27	32.2	-	2092	2047

\* Complete the description of the standard item needed by adding the type of handle D or F.



ELESA and GANTER models all rights reserved in accordance with the law. Always mention the source when reproducing our drawings.

STANDARD MACHINE ELEMENTS WORLDWIDE