

CP-XX

Covers

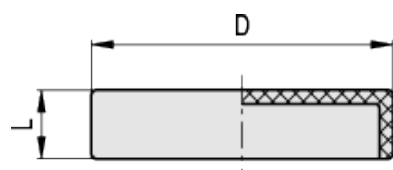

technical informations

Material

Polyester based (PBT) technopolymer.

Colour

Light grey, matte finish.

Assembly

Push-fit. The cover can be removed by using a screwdriver in the proper cavity.

Applications

CP-XX covers are suitable for closing the indicator housing when the indicator is not required.



Application example on VHT. lobe knob

Code	Description	D	L	g	Handwheel/indicator combinations
CE.40101	CP.X1	49.9	11	6	IZN.60-MBT.60-VHT.85
CE.40102	CP.X2	68.6	14	11	IZN.80-MBT.80-VHT.110-VDSC-XX - EWW-XX



ELESA and GANTER models all rights reserved in accordance with the law. Always mention the source when reproducing our drawings.

STANDARD MACHINE ELEMENTS WORLDWIDE