

# CFJ.

Tamperproof hinges

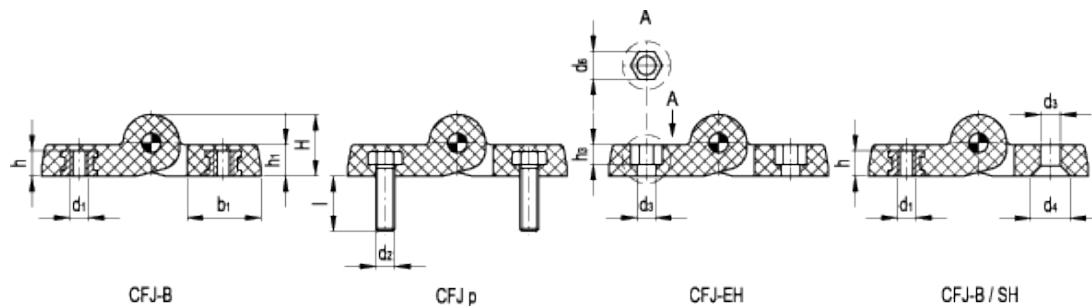

FM Design



## technical informations

### Material

Glass-fibre reinforced polyamide based (PA) technopolymer. Resistant to solvents, oils, greases and other chemical agents.

### Colour

Black, matte finish.

### Rotation pin

AISI 303 stainless steel, totally moulded in the hinge body.

### Assembly

- Execution B: nickel-plated brass bushings, tapped hole.
- Execution p: nickel-plated steel threaded studs.
- Execution EH: through holes for hexagonal head screws.
- Combined executions: B/SH (SH = through holes for countersunk head screws).

### Features and applications

The rotation pin totally moulded in the hinge body (ELESA patent) cannot be extracted, preventing any hinge tampering. This characteristic makes the hinge particularly suitable for mounting on structures or equipments requiring protection against intrusion.

## Rotation angle

Max 270°, between 0° and -90° and between 0° and 180°

(0° = condition where the interconnected surfaces are on the same plane).

Do not exceed the rotation angle limit (see drawing) so as not to prejudice the hinge mechanical performance.

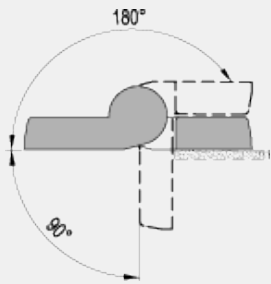

To choose the convenient type and the right number of hinges for your application see the [Guidelines](#).

### Application example

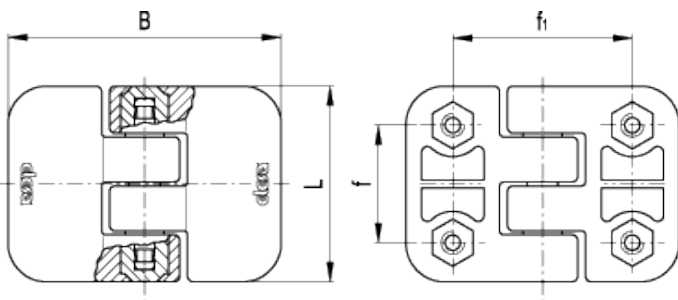
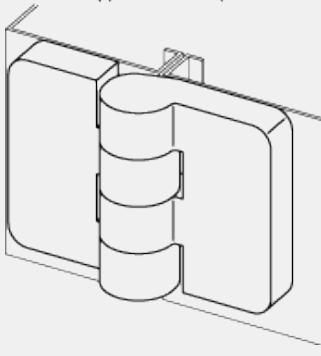

Standard Elements		Main dimensions							Fitting								Weight g	
									Bushings		Studs		Through holes					
Code	Description	L	B	$f_{\pm 0.25}$	$f_1_{\pm 0.25}$	H	$h_1$	$b_1$	$d_1$	h	$d_2$	l	$d_3$	$d_4$	$d_6$	$h_3$	g	
424611	CFJ.50 B-M6	50	70	30	46	19.5	10	23.5	M6	8	-	-	-	-	-	-	-	66
424621	CFJ.50 p-M6x17	50	70	30	46	19.5	10	23.5	-	-	M6	17	-	-	-	-	-	71
424631	CFJ.50 EH-6	50	70	30	46	19.5	10	23.5	-	-	-	-	6.5	-	10	5.5	-	46
424671	CFJ.50-R B-M6-SH-6	50	70	30	46	19.5	10	23.5	M6	8	-	-	6.5	12.5	-	-	-	54

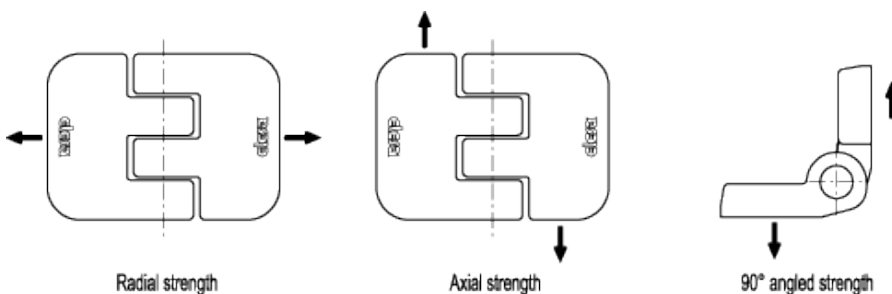

Standard Elements		AXIAL STRENGTH		RADIAL STRENGTH		90° ANGLED STRENGTH		Maximum tightening torque [Nm]	
Code	Description	Maximum working load Ea [N]	Load at breakage Ra [N]	Maximum working load Er [N]	Load at breakage Rr [N]	Maximum working load E90 [N]	Load at breakage R90 [N]	EH/SH	B
424611	CFJ.50 B-M6	730	4170	2220	4450	710	2250	-	5
424621	CFJ.50 p-M6x17	1420	4410	2180	4350	510	2220	-	-
424631	CFJ.50 EH-6	1740	3470	1490	2970	460	2120	5	-
424671	CFJ.50-R B-M6-SH-6	1480	2780	1310	2490	390	1900	3	5



ELESA and GANTER models all rights reserved in accordance with the law. Always mention the source when reproducing our drawings.

**STANDARD MACHINE ELEMENTS WORLDWIDE**