

REVISION HISTORY			
REV	DATE	BY	DESCRIPTION
E	22APR2024	GEA/CMS	PRN: P2024-0140

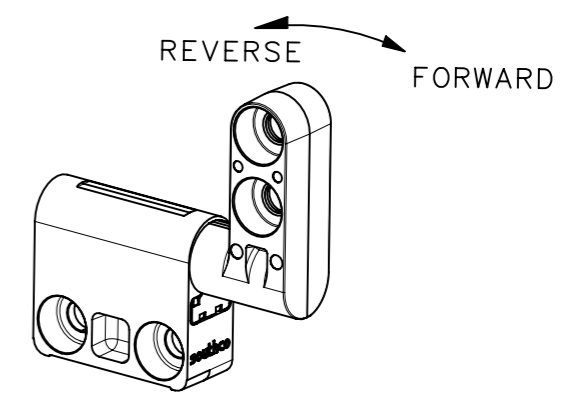
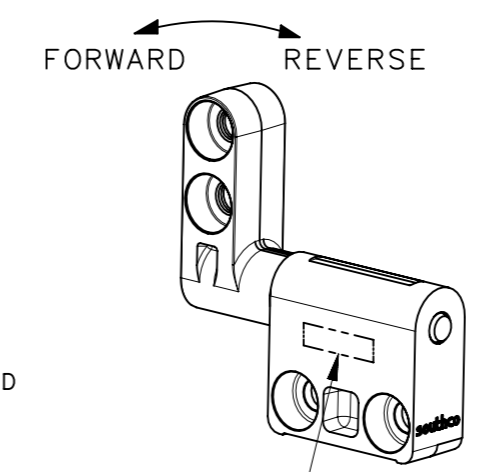
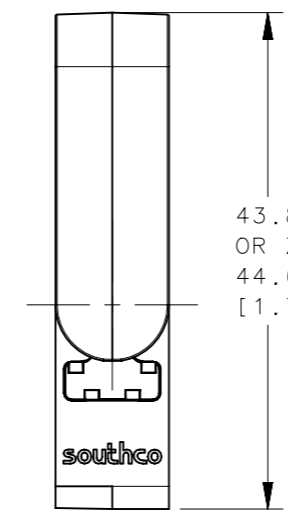
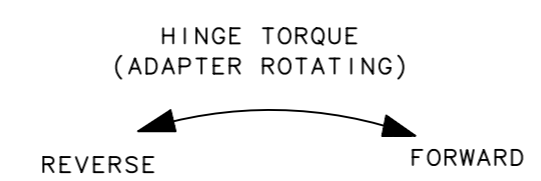
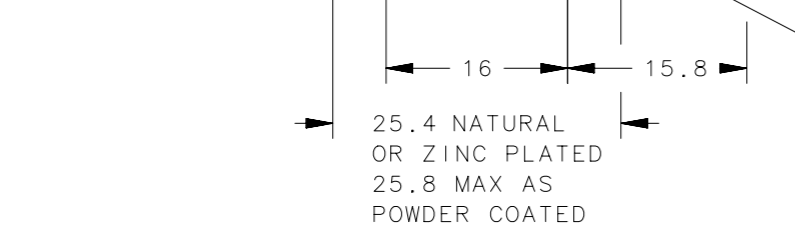
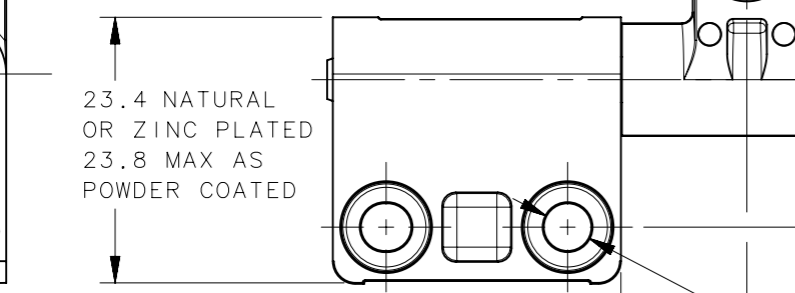
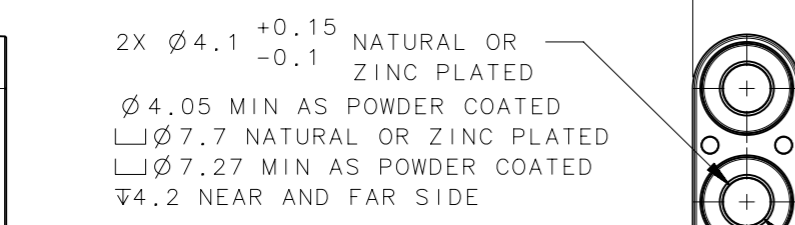
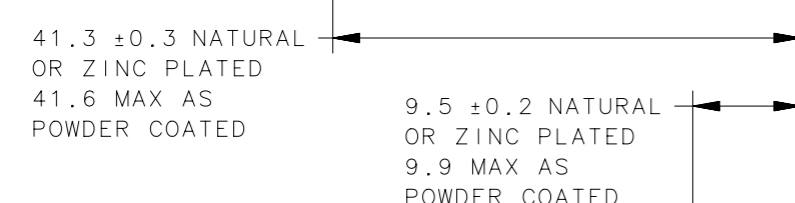
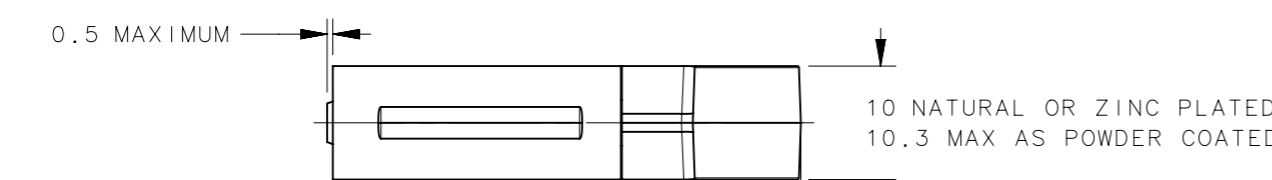

PART NUMBER	STATIC TORQUE +/-20% *	
	FORWARD TORQUE Lbf-in (N-m)	REARWARD TORQUE Lbf-in (N-m)
ST-10A2-35ST-XX	3.0 (0.34)	3.0 (0.34)
ST-10A2-70ST-XX	6.0 (0.68)	6.0 (0.68)
ST-10A2-100ST-XX	9.0 (1.02)	9.0 (1.02)
ST-10A2-135ST-XX	12.0 (1.36)	12.0 (1.36)
ST-10A2-170ST-XX	15 (1.7)	15 (1.7)
ST-10A2-200ST-XX	18 (2.04)	18 (2.04)
ST-10A2-240ST-XX	21 (2.38)	21 (2.38)
ST-10A2-270ST-XX	24 (2.72)	24 (2.72)
ST-10A2-300ST-XX	27 (3.06)	27 (3.06)
ST-10A2-80FT-XX	6.7 (0.76)	5.3 (0.6)*
ST-10A2-95FT-XX	8.4 (0.95)	6.6 (0.75)*
ST-10A2-115FT-XX	10.1 (1.14)	8.0 (0.9)*
ST-10A2-130FT-XX	11.8 (1.33)	9.3 (1.05)*
ST-10A2-150FT-XX	13.5 (1.52)	10.6 (1.2)*
ST-10A2-170FT-XX	15.1 (1.71)	11.9 (1.35)*
ST-10A2-190FT-XX	16.8 (1.9)	13.3 (1.5)*
ST-10A2-210FT-XX	18.5 (2.09)	14.6 (1.65)*
ST-10A2-225FT-XX	20.2 (2.28)	15.9 (1.8)*
ST-10A2-245FT-XX	21.9 (2.47)	17.3(1.95)*
ST-10A2-265FT-XX	23.5 (2.66)	18.6 (2.1)*
ST-10A2-285FT-XX	25.2 (2.85)	19.9 (2.25)*
ST-10A2-300FT-XX	26.9 (3.04)	21.2 (2.4)*
ST-10A2-80RT-XX	5.3 (0.6)*	6.7 (0.76)
ST-10A2-95RT-XX	6.6 (0.75)*	8.4 (0.95)
ST-10A2-115RT-XX	8.0 (0.9)*	10.1 (1.14)
ST-10A2-130RT-XX	9.3 (1.05)*	11.8 (1.33)
ST-10A2-150RT-XX	10.6 (1.2)*	13.5 (1.52)
ST-10A2-170RT-XX	11.9 (1.35)*	15.1 (1.71)
ST-10A2-190RT-XX	13.3 (1.5)*	16.8 (1.9)
ST-10A2-210RT-XX	14.6 (1.65)*	18.5 (2.09)
ST-10A2-225RT-XX	15.9 (1.8)*	20.2 (2.28)
ST-10A2-245RT-XX	17.3(1.95)*	21.9 (2.47)
ST-10A2-265RT-XX	18.6 (2.1)*	23.5 (2.66)
ST-10A2-285RT-XX	19.9 (2.25)*	25.2 (2.85)
ST-10A2-300RT-XX	21.2 (2.4)*	26.9 (3.04)

* TOLERANCE IN LOW TORQUE DIRECTION ±30%

- NOTES:
- MATERIAL AND FINISH:
HOUSING, ADAPTER AND END CAP - ZINC ALLOY, FOR FINISH, SEE TABLE
SHAFT AND TORQUE ELEMENTS - HARDENED STEEL
 - INSTALL HINGE USING No.8 or M4 SOCKET HEAD CAP SCREWS, OR EQUIVALENT, USE LOW PROFILE CAP SCREWS IF SCREW HEAD MUST BE SUBFLUSH.
 - FOR PROPER FUNCTION, ASSEMBLY MUST INCLUDE (2) TYPE T HINGES.
FOR ASYMMETRIC TORQUE, USE (1) RT HINGE AND (1) FT HINGE.
 - DIMENSIONS INDICATE AS BUILT CONDITON, LEAF TO LEAF SPACING WILL SELF-ADJUST DURING NORMAL OPERATION
 - PERFORMANCE TORQUE TOLERANCE OVER 50,000 CYCLES.

PART NUMBER	DESCRIPTION	FINISH
ST-10A2-XXXXT-33	ASSEMBLY - AS CAST	NATURAL
ST-10A2-XXXXT-50	ASSEMBLY - POWDER COATED	BLACK
ST-10A2-XXXXT-53	ASSEMBLY - ZINC PLATED	BLACK

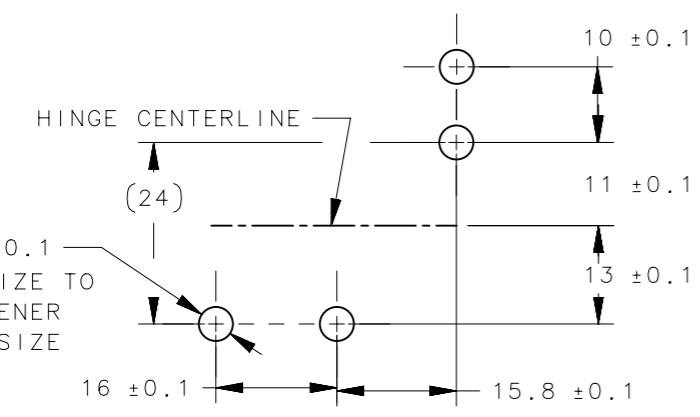

PANEL PREPARATION

CPB NUMBER 2021-0920	THIRD ANGLE PROJECTION
SURFACE AREA	MILLIMETERS [IN]
VOLUME	TOLERANCES UNLESS OTHERWISE NOTED
PROPRIETARY ITEM	ALL DIMENSIONS WITHOUT TOLERANCES ARE FOR REFERENCE ONLY.
EXCEPT FOR USES EXPRESSLY GRANTED IN WRITING, INFORMATION DISCLOSED HEREON IS CONFIDENTIAL AND ALL RIGHTS, PATENT AND OTHERWISE, ARE RESERVED BY SOUTHCO, INC.	PER ASME Y14.5M-2009

SIZE A3	SYSTEM NX	DWG NO.
DRAWN BY GEA/CMS	DATE 22JUN2023	SCALE 1:1
SHEET 1 OF 1		

southco
CONNECT · CREATE · INNOVATE

DESCRIPTION
HINGE & CONTROLLED MOTION DEVICE
ST-10A2-T HINGE ASSEMBLY - TYPE T

DWG NO. J-ST-10A2-T