



# E5 Cam Latch

Zinc · Tool operated · Adjustable grip

- Single hole install
- Latched / unlatched indicator
- Easy grip adjustment
- Tool operated for security
- Sensor Cam Option - for monitoring door and latch status

## Material and Finish

Zinc alloy, powder coated or chrome plated and steel, zinc plated

## Performance Details

Maximum static load: 330 N (74 lbf)

## Installation Notes

Position cam so latching function can be achieved comfortably by hand. Recommended tightening torque for mounting nut is 10 N·m (88 in·lbf) max, and jam nut is 7 N·m (62 in·lbf)

## Sealing Notes

NEMA 4 / IP65 achieved using gasket supplied

## Keys and Accessories

See page 121 and 169-175

## Part Number Selection

See table

Order latch and cam separately

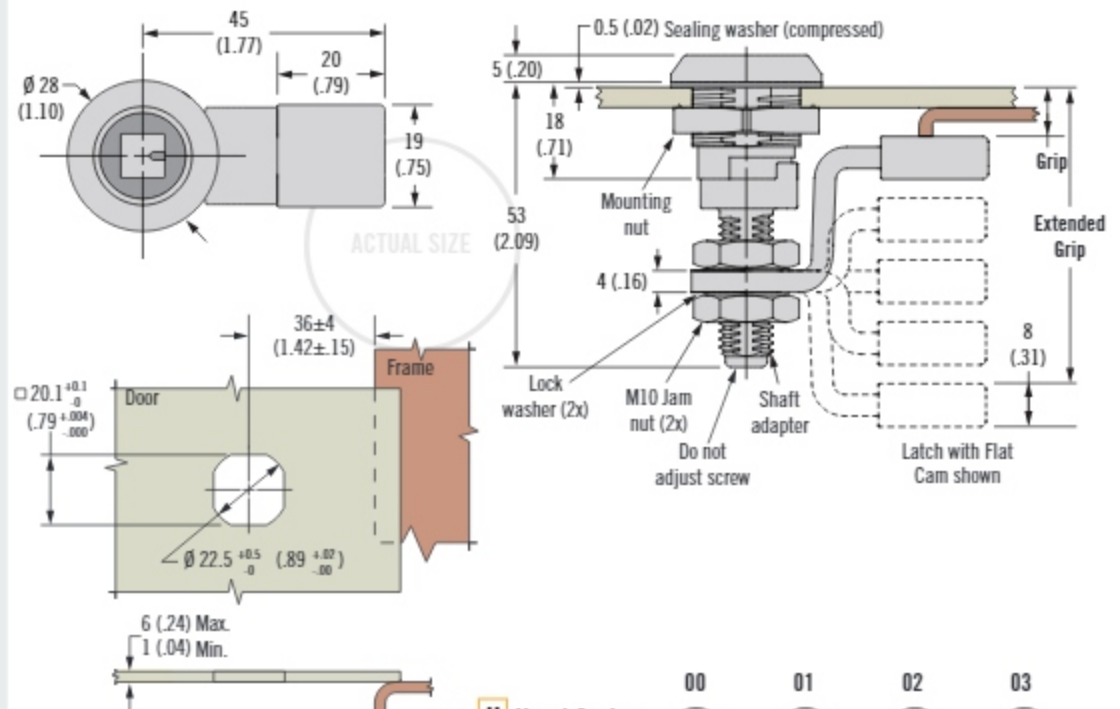

## H Head Styles

Latch Part Number (no cam)

**E5 - 6 - H F - 01**

- F** Finish
- 2 Bright chrome
  - 5 Black powder coated

00	01	02	03
Slotted	8 (.32) Hex recess	7 (.28) Triangle	8 (.32) Triangle
04	05	06	07
7 (.28) Square	8 (.32) Square	3 (.11) Double bit	5 (.19) Double bit
08	13	19	21
8 (.32) Square recess	Bellcore 216	Bellcore electronics	Recessed slot (tamper resistant)
			22
			Railway standard

## Latch Can Be Used With ES-01 Universal Latch Sensor for Monitoring Latch and Door Status

(see page 47A)

Requires: E5-6 Latch, E5-400X-XXX Sensor Cam and Universal Latch Sensor.

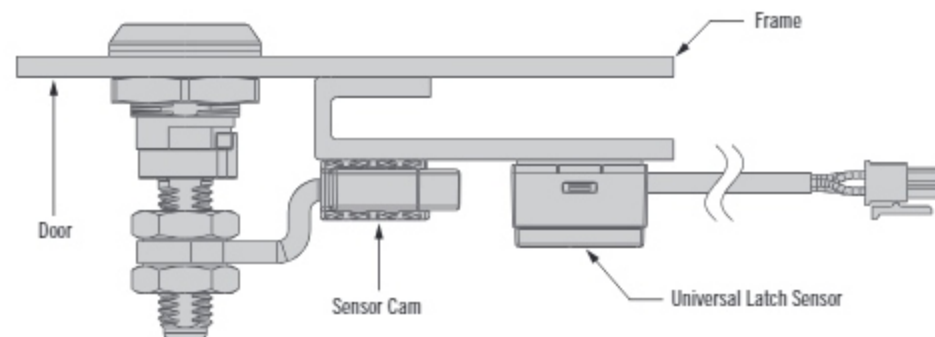

Dimensions in millimeters (inch) unless otherwise stated

# E5 Cam Latch

## Adjustable grip cam options



153A

**Protected Cam Part Number Table (order separately from latch)**

Minimum Grip +2(.08) - 0	Maximum Grip +2(.08) - 0	Offset	Cam Type	Part Number
5 (.20)	16.5 (.65)	Deep Cam	Forward	E5-4001
51 (2.01)	62.5 (2.46)	Deep Cam	Reversed	
16.5 (.65)	28 (1.10)	Cam	Forward	E5-4002
39.5 (1.56)	51 (2.01)	Cam	Reversed	
28 (1.10)	39.5 (1.56)	-	Straight Cam	E5-4003



### Protected Cam

- Stable frame engagement
- Improved surface contact
- Minimal frame surface prep

**Roller Cam Part Number Table (order separately from latch)**

Minimum Grip +2(.08) - 0	Maximum Grip +2(.08) - 0	Offset	Cam Type	Part Number
0 (0)	5 (.20)	Extra Deep Cam	Forward	E5-4505
54 (2.13)	62.5 (2.46)	Extra Deep Cam	Reversed	
0 (0)	8 (.31)	Deep Cam	Forward	E5-4506
45 (1.89)	58 (2.28)	Deep Cam	Reversed	
8 (.31)	18 (.71)	Medium Cam	Forward	E5-4507
38 (1.50)	48 (1.89)	Medium Cam	Reversed	
18 (.17)	28 (1.10)	Low Cam	Forward	E5-4508
28 (1.10)	38 (1.50)	Low Cam	Reversed	

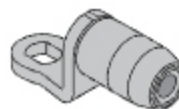

### Roller Cam

- Reduce operating effort
- Minimize scratching frame finish
- Detented feel (with optional Keeper)

**Sensor Cam Part Number Table (order separately from latch)**

Minimum Grip +2(.08) / - 0	Maximum Grip +2(.08) / - 0	Offset	Cam Type	Magnet Position	Part Number
3.5 (.14)	15 (.59)	Deep Cam	Forward	Position 1	E5-4001-M01
49.5 (1.95)	61 (2.40)		Reversed	Position 2	E5-4001-M02
				Position 3	E5-4001-M03
15 (.59)	26.5 (1.04)	Cam	Forward	Position 1	E5-4002-M01
38 (1.50)	49.5 (1.95)		Reversed	Position 2	E5-4002-M02
				Position 3	E5-4002-M03
26.5 (1.04)	38 (1.50)	Straight Cam	-	Position 1	E5-4003-M01
				Position 2	E5-4003-M02
				Position 3	E5-4003-M03

### Sensor Cam

- Stable frame engagement
- Improved surface contact
- Works with Southco ES-01 Universal Latch Sensor (page 47A)

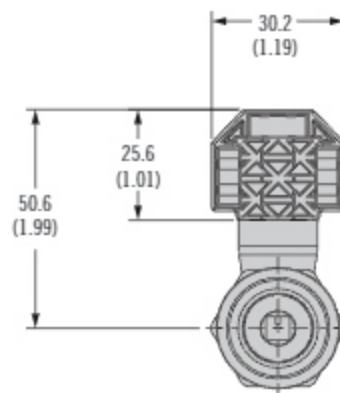
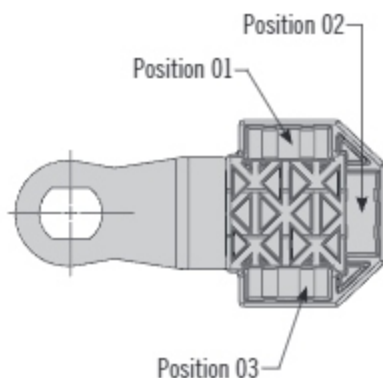
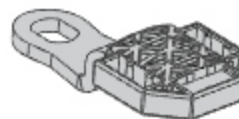

- Single hole install
- Latched / unlatched indicator
- Easy grip adjustment
- Tool operated for security
- Sensor Cam Option - for monitoring door and latch status

### Material and Finish

Zinc alloy, powder coated or chrome plated and steel, zinc plated

### Performance Details

Maximum static load: 330 N (74 lbf)

### Installation Notes

Position cam so latching function can be achieved comfortably by hand. Recommended tightening torque for mounting nut is 10 N·m (88 in·lbf) max, and jam nut is 7 N·m (62 in·lbf)

### Sealing Notes

NEMA 4 / IP65 achieved using gasket supplied

### Keys and Accessories

See page 121 and 169-175

### Part Number Selection

See table

Order latch and cam separately