



D9 - *DZUS*[®] Tech Line Quick Access Fasteners

D9-PR PCI Riser Cage Fastener Assembly

- Designed for 2U Servers
- Hand operation
- Spring ejected
- Wide variety of receptacle options

Fastener Assembly Material and Finish

Cap: UL94-V0 PA6
 Assembly Cover: PC-ABS, black
 Pin, Washer: Stainless steel, passivate
 Lower Stud, Bracket, Clip: Steel, zinc plate
 Rotation Limiter, Upper Stud: Zinc alloy, chromate sealer

Installation Notes

Maximum installation torque of mounting screws to attach assembly covers
 0.7 Nm (6 in-lbs) using M3 screws.

Performance Details

Maximum torque to be applied to cap is 1.1 Nm (10 in-lbs)

Part Numbers

See tables

Receptacle Details

(order separately)

See page 471

Fastener Assembly

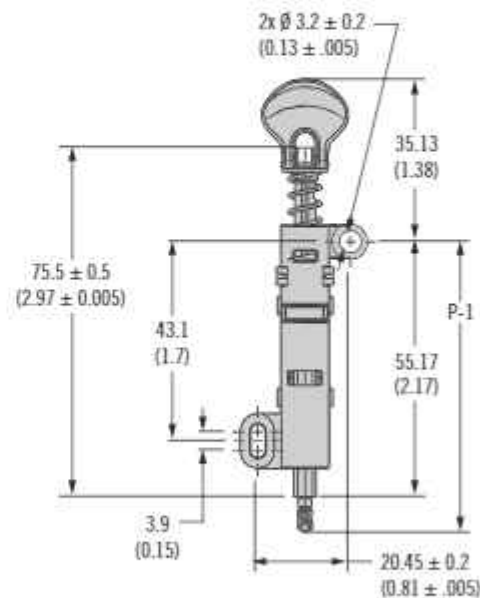
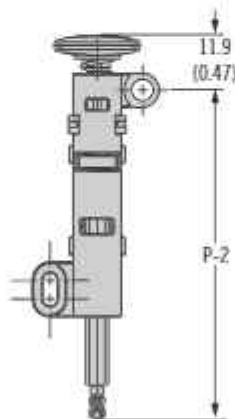

Fastened

Please note correct receptacle Orientation

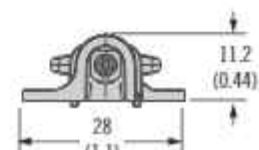

Unfastened

To fasten, push on cap to place lower stud into receptacle and turn cap 180° and fold down.

Part Number	TMT	P-1	P-2	Cap Color
D9-PR-20-000	4.25 (0.16)	62.4 ± 1.2 (2.45 ± 0.04)	70.9 ± 1.2 (2.78 ± 0.04)	Black
D9-PR-20-072				Blue
D9-PR-21-000	4.45 (0.17)	62.6 ± 1.2 (2.46 ± 0.04)	71.1 ± 1.2 (2.79 ± 0.04)	Black
D9-PR-21-072				Blue
D9-PR-22-000	4.65 (0.18)	62.8 ± 1.2 (2.47 ± 0.04)	71.3 ± 1.2 (2.80 ± 0.04)	Black
D9-PR-22-072				Blue

TMT = Customer panel thickness + Customer PCB thickness + Southco receptacle thickness + Southco gasket compressed thickness (0.55 mm)

Gasket

Part Number	Material	Color
D9-81 (order separately)	High density foam	Gray

NOTES:

1. ASSEMBLY AND ALL ITS COMPONENTS ARE RoHS COMPLIANT.
2. MAXIMUM INSTALLATION TORQUE ALLOWED TO ATTACH COVER SCREWS IS 0.7 Nm (6 IN-LBS) AND M3 THREAD RECOMMENDED. AND DO NOT SUGGEST TO USE FLAT HEAD SCREW OR OVAL HEAD SCREW.
3. MAXIMUM TORQUE APPLICABLE TO BAIL 1.1 Nm (10 IN-LBS).
4. COSMETIC SPECIFICATION:
ALL SURFACES ON BAIL CAP AND COVER VISIBLE AFTER INSTALLATION INTO SERVER ARE TO BE CLASS *B*. ALL OTHER SURFACES ARE TO CONFORM TO A CLASS *C* DESIGNATION AS DESCRIBED IN SOUTHCO COSMETIC SPECIFICATIONS: S-121.
5. SOUTHCO RECEPTACLE D9-61-11, D9-62-11 OR D9-63-11 ORDERED SEPARATELY. SEE J-D9-61, J-D9-62 OR J-D9-63 FOR DETAIL DIMENSIONS.
6. SOUTHCO GASKET D9-81 ORDERED SEPARATELY. SEE J-D9-81 FOR DETAIL DIMENSIONS.
7. TMT=CUSTOMER PANEL THICKNESS+CUSTOMER PCB THICKNESS+SOUTHCO RECEPTACLE THICKNESS+SOUTHCO GASKET COMPRESSED THICKNESS(COMPRESSED THICKNESS=0.55mm)
8. TO FASTEN,PUSH ON CAP TO PLACE LOWER STUD INTO RECEPTACLE AND TURN CAP 180° AND FOLD DOWN.

REVISION HISTORY			
REV	DATE	BY	DESCRIPTION
B	19OCT2022	DL/ED	PRN:P2022-1850

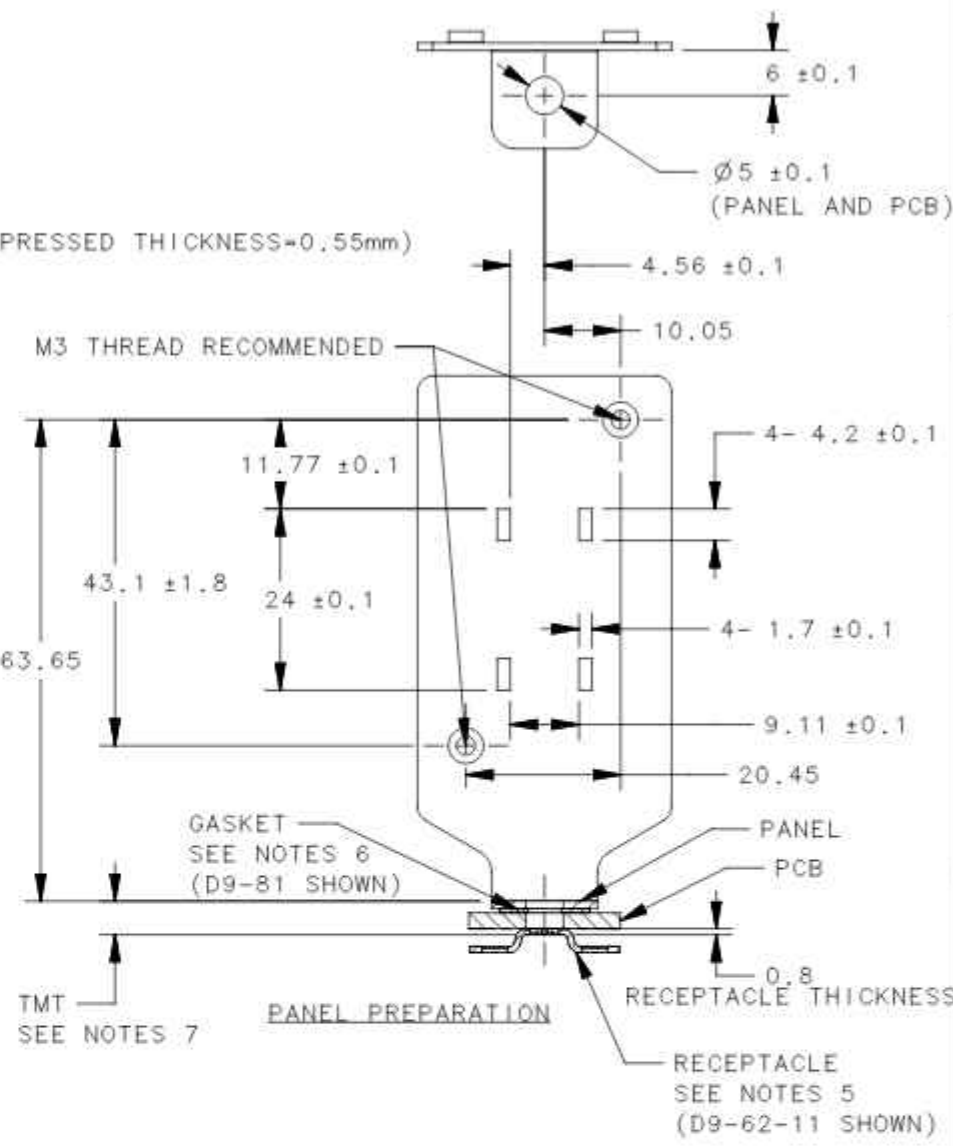
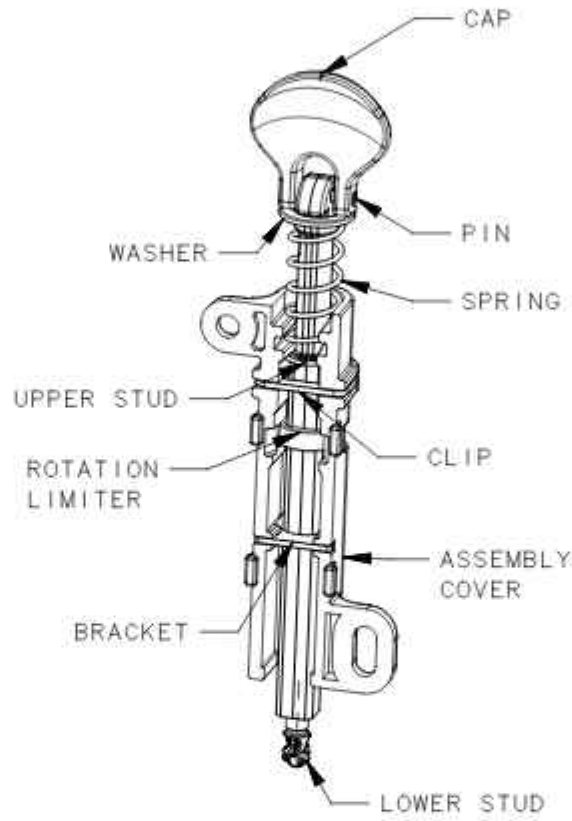
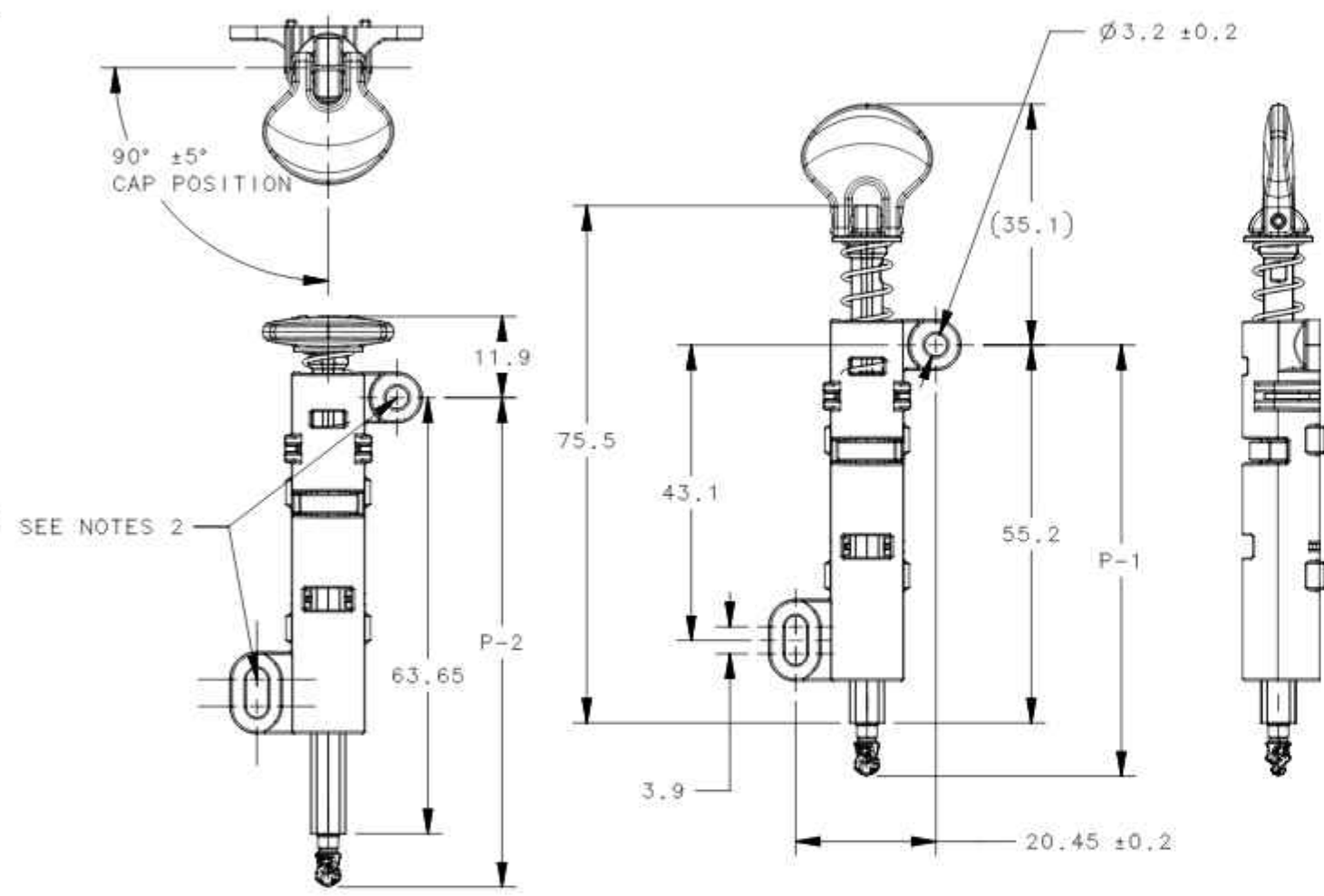

LOCKED

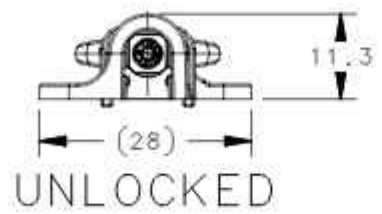

UNLOCKED

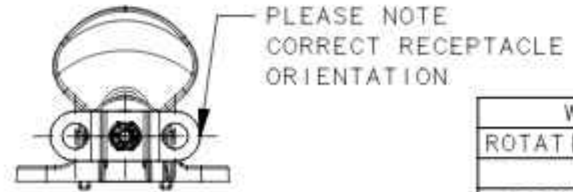

ASSEMBLY PART NUMBER	*EEE* CAP COLOR	TMT	P-1	P-2
D9-PR-20-EEE	000-BLACK . 072-BLUE	4.25	62.4+/-1.2	70.9+/-1.2
D9-PR-21-EEE	FOR ADDITIONAL COLORS	4.45	62.6+/-1.2	71.1+/-1.2
D9-PR-22-EEE	SEE J-47-0-3	4.65	62.8+/-1.2	71.3+/-1.2

TYPE OF COMPONENT	MATERIAL	FINISH/COLOR
WASHER	STAINLESS STEEL	PASSIVATE
ROTATION LIMITER	ZAMAK 3	CHROMATE SEALER
CAP	UL94-V0 PA6	PANTONE 279C
ASSEMBLY COVER	PC-ABS	BLACK
SPRING	MUSIC WIRE	ZINC PLATE
LOWER STUD	STEEL	ZINC PLATE
UPPER STUD	ZAMAK 3	CHROMATE SEALER
BRACKET	STEEL	NATURAL
PIN	STAINLESS STEEL	PASSIVATE
CLIP	STEEL	ZINC PLATE

PROPRIETARY ITEM
EXCEPT FOR USES EXPRESSLY GRANTED
IN WRITING, INFORMATION DISCLOSED
HEREON IS CONFIDENTIAL AND ALL
RIGHTS, PATENT AND OTHERWISE,
ARE RESERVED BY SOUTHCO, INC.

THIRD ANGLE PROJECTION
MILLIMETERS [IN]
TOLERANCES UNLESS OTHERWISE NOTED
ALL DIMENSIONS WITHOUT TOLERANCES ARE FOR REFERENCE ONLY.
PER ASME Y14.5M-1994

D9-PR		PCI RISER ASSEMBLY	
PART NUMBER		TYPE OF COMPONENT	
southco CONNECT • CREATE • INNOVATE			
DESCRIPTION QUICK ACCESS FASTENER PCI LOCKDOWN ASSEMBLY			
SIZE A3	SYSTEM NX	DWG NO. J-D9-PR	
DRAWN BY DL	DATE 21DEC2020	SCALE 1:1	SHEET 1 OF 1

SOUTHCO PERFORMANCE GUIDELINES

THE PERFORMANCE GUIDELINES SHOWN ON THIS PAGE ARE SUPPLIED AS A GENERAL GUIDE ONLY AS CONDITIONS VARY WITH EACH APPLICATION AND METHOD OF INSTALLATION. STRENGTH DATA GIVEN IS FOR FAILURE OF THE PRODUCT OR FOR SUFFICIENT DEFORMATION TO MAKE PRODUCT INOPERABLE. NO SAFETY FACTOR HAS BEEN APPLIED IT IS RECOMMENDED THAT THE USER REQUEST A PRODUCT SAMPLE FOR TESTING TO DETERMINE THE SUITABILITY OF THE PRODUCT FOR THE PURPOSE INTENDED AND USER'S PARTICULAR APPLICATION.

REVISION HISTORY			
REV	DATE	BY	DESCRIPTION
A	29SEP2022	DL/ED	PRN: P2022-1850

TORQUE FOR KNOB



D9-62-11

PUSH OUT FOR PIN

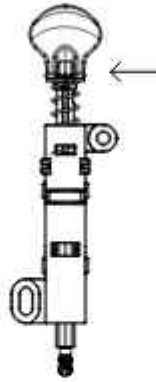

PUSH FOR KNOB IN LOCK



PULL OUT FOR STUD



- ① MAXIMUM TORQUE: 1.1N.m
AVERAGE ULTIMATE TORQUE: 1.6N.m
- ② MAXIMUM LOAD : 75N
AVERAGE ULTIMATE LOAD: 120N
- ③ MAXIMUM LOAD : 90N
AVERAGE ULTIMATE LOAD: 180N
- ④ MAXIMUM LOAD: 160N
AVERAGE ULTIMATE LOAD: 290N

NOTES:

MAXIMUM TORQUE/LOAD - THE HIGHEST RECOMMENDED TORQUE/FORCE

AVERAGE ULTIMATE TORQUE - THE AVERAGE FORCE THAT CAUSES FAILURE OR EXCESSIVE DEFORMATION WHICH RENDERS THE PRODUCT INOPERABLE

AVERAGE ULTIMATE LOAD - THE AVERAGE FORCE THAT CAUSES FAILURE OR EXCESSIVE DEFORMATION WHICH RENDERS THE PRODUCT INOPERABLE

CPB NUMBER 2020-0513	THIRD ANGLE PROJECTION	southco [®] CONNECT • CREATE • INNOVATE			
	MILLIMETERS [IN]				
SURFACE AREA	TOLERANCES UNLESS OTHERWISE NOTED	DESCRIPTION QUICK ACCESS FASTENER			
VOLUME	UP TO 0.5 ±0.05 OVER 0.5 UP TO 6 ±0.1 OVER 6 UP TO 30 ±0.2 OVER 30 ±0.3 ANGLES ±1°				
PROPRIETARY ITEM <small>EXCEPT FOR USES EXPRESSLY GRANTED IN WRITING, INFORMATION DISCLOSED HEREON IS CONFIDENTIAL AND ALL RIGHTS, PATENT AND OTHERWISE ARE RESERVED BY SOUTHCO, INC.</small>	PER ASME Y14.5M-1994	SIZE A4	SYSTEM NX	DWG NO. TD-D9-PR-J	
		DRAWN BY DL	DATE 04MAR2021	SCALE 1:2	SHEET 1 OF 1